

PRINCESS 42 • 2007 • Ref: PB481

Lying: UK South Coast

Price: £ 350,000



Brochure Photo

Twin 435hp D6-435 Volvo Penta Engines

Dual station Raymarine Colour Plotter

Bow Thruster

Holding Tank

Autopilot

Natural Light Cherry Interior

Cream Leather Upholstery

Commissioned March 2008

Generator fitted in 2009

Air-conditioning fitted in 2009

Passerelle fitted in 2009

Contact: Swanwick

Tel: Int. +44 (0)1489 557744

Fax: Int. +44 (0)1489 557766

Email: brokerage@princess.co.uk

PRINCESS 42 • 2007 • Ref: PB481

Dimensions:

- L.O.A: 13.48 metres (44 ft 3 in)
- Beam: 4.14 metres (13 ft 7 in)
- Draft: 1.09 metres (3 ft 7 in)
- Displacement: 14 Tonnes
- Fuel capacity: 1,332 Litres (250 Gallons)
- Water capacity: 455 Litres (100 Gallons)

Propulsion:

- Engines: 2 x 435hp D6-435 Volvo Penta diesel engines on shaft drives
- Engine hours: TBC

Navigational Equipment:

- Bow Thruster
- Raymarine (colour) plotter at upper and lower helm
- 4kW open array radar scanner
- Autohelm A6000 + auto pilot dual station
- Raymarine ST60 Speed (speed & log) at lower helm
- Raymarine ST60 Depth (echo sounder) at lower helm
- Raymarine Tridata (speed, log & echo sounder) at upper helm
- Dual station Raymarine ST6002 autopilot
- Dual station DSC VHF radio/telephone

Deck Equipment:

- Electro-hydraulic Passerelle fitted in 2009
- Vanilla Vinyl exterior cushions with blue insert on flybridge and cockpit.
- Teak cockpit deck and flybridge staircase
- Foredeck freshwater anchor/deck wash system
- Triple stainless steel framed saloon doors
- Electric anchor windlass with self-stowing anchor
- Additional anchor chain
- Stainless steel pulpit & guard rails
- Top loading coolbox at flybridge helm

Ship's Systems:

- Holding tank with electric flush toilets
- 24V DC battery systems for engine starting and auxiliary power
- 240V Shore support system
- 50A automatic float battery charger

Air-conditioning

- Reverse cycle Air-conditioning fitted in 2009

Generator:

- Generator fitted in 2009

Interior Arrangements:

- Standard 2 seater sofa on port side saloon
- 4 berths in 2 cabins
- 2 heads (2 en-suite)
- Saloon convertible to double berth
- Natural Light Cherry woodwork
- Cream Leather upholstery

Interior Equipment:

- Omni Directional TV aerial signal booster, Port side saloon
- UK 220V/240V Sockets
- Jabsco silent type electric toilets

Brochure Layout Plan:

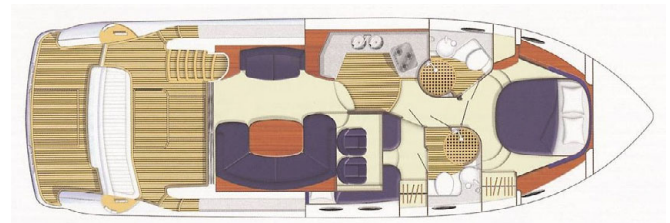

Whilst every care has been taken in the preparation of these particulars, their correctness is not guaranteed and they are intended as a guide only and do not constitute a part of any contract.

A prospective purchaser is strongly advised to check these particulars and where appropriate and at his own expense to employ a qualified marine surveyor to carry out a survey and/or to have an engine trial conducted which if conducted by us shall not imply any liability on our part.

All dimensions, speeds & range given are approximate and should be treated as a guide only. Some pictures may be from brochures or of a similar boat. Engine hours shown are correct at the time of the preparation of the particulars, but will vary with usage.

Please call to confirm availability of a specific boat