

PRINCESS 45 MkII • 2006/7 • Ref: PB573

Lying: South Coast UK

Price: £ 329,000



Brochure Photo

Twin Volvo D9-500 (500hp each)
Bow Thruster
Toilet holding tank
BOSE Sound System
Onan 9.5kW Generator
LCD TV & DVD in saloon
Stone leather saloon seating
Teak Flybridge and Side decks
Foredeck sunbathing cushions
Full reverse cycle air conditioning
Natural cherry high gloss woodwork

Contact: Swanwick

Tel: Int. +44 (0)1489 557744

Fax: Int. +44 (0)1489 557766

Email: brokerage@princess.co.uk

PRINCESS 45 • 2006/7 • Ref: PB573

Dimensions:

- L.O.A: 13.92 metres (45 ft 8 in)
- Beam: 4.27 metres (14 ft 0 in)
- Draft: 1.09 metres (3 ft 7 in)
- Displacement: 14.8 Tonnes
- Fuel capacity: 1,636 Litres (360 Gallons)
- Water capacity: 586 Litres (129 Gallons)

Propulsion:

- Engines: 2 x 500 hp Volvo Penta D9-500 diesel engines on shaft drives
- Engine hours: 185 (Nov 09)

Navigational Equipment:

- Simrad dual station VHF/DSC radio with intercom
- Furuno 1934C Radar/Plotter/GPS with 10" repeater on upper helm
- Remote searchlight with dual station controls
- Dual station Raymarine autopilot
- Dual station Raymarine speed and log
- Dual station Raymarine echo sounder
- Bow thruster with dual station controls
- Stern camera system

Deck Equipment:

- Remote control electric anchor winch
- Additional 10m of anchor chain (40m total)
- Trim tabs with dual station controls and indicators
- Triple opening stainless steel saloon doors
- Flybridge refrigerated cool box
- Teak-laid cockpit, bathing platform, fly bridge and side decks
- Hot and Cold transom shower
- Flybridge and cockpit covers Navy Canvas
- Foredeck sunbed cushions

Ship Systems:

- 220/240V Shore support system
- 24v DC electrical system
- 50 amp battery charging unit
- Electric quiet flush WCs
- Toilet holding tank (System 2)
- Saloon LCD TV and DVD player

Generator:

- Onan 9.5kW diesel generator with hydrohush exhaust system and soundproof cabinet

Air Conditioning:

- Air conditioning to all cabins, saloon and toilet compartments with heating on reverse cycle

Safety Equipment:

- Automatic electric bilge pumps
- Manual emergency bilge pump
- Automatic fire extinguisher in engine room
- Manual fire extinguishers in cabins

Interior Arrangements:

- 6 berths in 3 cabins
- 2 heads (2 en-suite)
- Stone leather saloon upholstery
- High gloss natural cherry woodwork
- Loop sand carpet
- 'Mojave Sand' galley worktop
- Milan Collection Fabrics

Interior Equipment:

- LCD TV in saloon cabinet
- FWD cabin flip down TV/DVD/stereo
- AM/FM/CD/DVD player in saloon
- Infill cushions for starboard cabin
- Galley and saloon refrigerators
- Combination Microwave Oven
- 3 Zone ceramic hob in galley in place of standard
- Mosquito screens for portholes

Miscellaneous:

- Later MKII face lifted model
- Additional TV point in forward cabin
- Upgraded part wood/part leather steering wheels

Brochure Layout Plan:

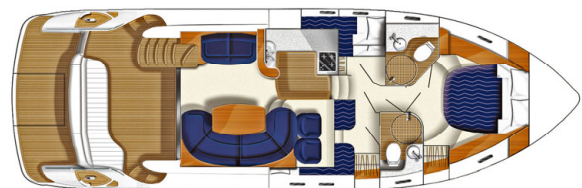

Whilst every care has been taken in the preparation of these particulars, their correctness is not guaranteed and they are intended as a guide only and do not constitute a part of any contract.

A prospective purchaser is strongly advised to check these particulars and where appropriate and at his own expense to employ a qualified marine surveyor to carry out a survey and/or to have an engine trial conducted which if conducted by us shall not imply any liability on our part.

All dimensions, speeds & range given are approximate and should be treated as a guide only. Some pictures may be from brochures or of a similar boat. Engine hours shown are correct at the time of the preparation of the particulars, but will vary with usage.

Please call to confirm availability of a specific boat