

FAIRLINE 55 SQUADRON MKIII • 2002/3 • Ref: PB652

Lying: Mallorca

Price: £ 399,000



Brochure Photo

Twin 700hp Volvo Penta D12-715EDC diesel engines

Bow and stern thruster to all control stations

Raymarine RL70C & R80 radar/chart plotter

Reverse Cycle Air Conditioning incl to crew cabin

Stone leather upholstery

3<sup>rd</sup> Station controls

Built 2002 commissioned 2003

Contact: Swanwick

Tel: +44 (0) 1489 557744

Fax: +44 (0)1489 557766

Email: [brokerage@princess.co.uk](mailto:brokerage@princess.co.uk)

## SQUADRON 55 • 2002/3 • Ref: PB652

### Dimensions:

- L.O.A: 17.05m (55ft 11in)
- Beam: 4.65m (15ft 3in)
- Draft: 1.12 m (3ft 8in)
- Dry weight (approx): 20 tons (20,325Kg)
- Fuel capacity: 2,182 Litres (480 Gallons)
- Water capacity: 572 Litres (126 Gallons)

### Propulsion:

- Engines: 2 x 700hp Volvo Penta D12-715EDC diesel shaft drive engines
- Engine hours: 485 hours as of March '10

### Navigational Equipment:

- Bow thruster with tri station controls
- Stern thruster with tri station controls
- Raymarine RL70C & R80 combined radar/plotter/GPS
- Dual station Autohelm ST6001 autopilot
- Dual station Raymarine ST60 echo sounder
- Dual station Raymarine ST60 speed/log
- VHF radio dual station with DSC
- Navtex weather fax
- Radar reflector

### Deck equipment:

- Teak laid cockpit and bathing platform decks
- Teak laid flybridge and side decks
- Cockpit and flybridge covers
- Remote control searchlight
- Reversible electric windlass and anchor
- Hot and cold transom shower
- Side deck access door from lower helm position
- Flybridge wet bar with electric BBQ
- Hydraulic passerelle with dinghy lift capability
- Foredeck cushions

### Ship systems:

- Electro-hydraulic trim tabs
- EDC electronic controls
- Sony Radio/CD player
- 220/240v shore support system with two shore power lines
- Battery charging unit
- Panasonic 32" LCD TV to saloon
- Saloon video and DVD player system
- Icemaker
- Vacuum flush fresh water WCs
- Toilet holding tank system
- Lower helm interior window demisters

### Generator:

- Onan 11KVa 220v 50hz diesel generator in soundproof cabinet

### Air Conditioning:

- Full reverse cycle air conditioning to all cabins including crew

### Interior arrangements:

- 6 berths in 3 cabins
- 2 heads (1 ensuite)
- 2 Berth crew cabin with ensuite WC & basin
- American cherry furniture
- Stone leather upholstery
- Ivory Berber carpets with overlays throughout
- "Autumn Wheat" galley worktop
- Zanussi washer/dryer in utility room
- Freezer unit in utility room
- Ironing board in utility room
- Dishwasher in galley
- Chubb safe in owners cabin

### Safety Equipment:

- 3 x automatic bilge pumps with manual back-up
- Automatic fire extinguisher in engine room
- Manual fire extinguishers

### Comments:

- Squadron crockery, cutlery and glassware
- Recent full survey available

### Brochure layout Plan:

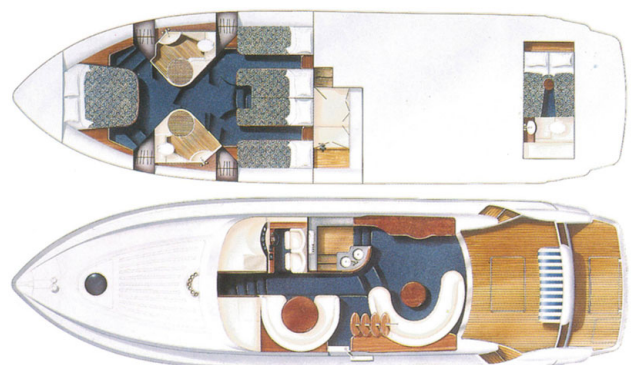

Whilst every care has been taken in the preparation of these particulars, their correctness is not guaranteed and they are intended as a guide only and do not constitute a part of any contract. A prospective purchaser is strongly advised to check these particulars and where appropriate and at his own expense to employ a qualified marine surveyor to carry out a survey and/or to have an engine trial conducted which if conducted by us shall not imply any liability on our part.

All dimensions, speeds & range given are approximate and should be treated as a guide only. Some pictures may be from brochures or of a similar boat. Engine hours shown are correct at the time of the preparation of the particulars, but will vary with usage.

Please call to confirm availability of a specific boat