

PRINCESS 23M • 2005/6 • Ref: PB670

Lying: Costa del Sol

Price: £ 995,000 (ex TAX)



Actual boat

Twin 1570hp CAT C30 diesel engines

Two double staterooms, two twin cabins and crew cabin

Furuno 10.4" colour radar/chart plotter with GPS

Teak flybridge & side decks

Hydraulic bow & stern thrusters

Vacuum flush toilets with holding tank

Whole boat air conditioning

Bimini top to flybridge

Natural light cherry woodwork

Berth available in Puerto Banus to lease or buy

Contact: Princess Motor Yachts Marbella

Tel: Int. +34 952 81 81 41 Fax: Int. +34 952 81 49 49

Email: marbella@princess.eu.com

Princess 23M • 2005/6 • Ref: PB670

Dimensions:

- L.O.A: 22.83 m (74 ft 11 in)
- Beam: 5.71 m (18 ft 9 in)
- Draft: 1.60 m (5 ft 3 in)
- Displacement: 48 Tonnes
- Fuel capacity: 5,819 Litres (1,280 Gallons)
- Water capacity: 1,386 Litres (305 Gallons)

Propulsion:

- Engines: 2 x Caterpillar C30 (2 x 1570 hp) diesel engines
- Engine hours: approx 1,725 hours
- Hydraulic sternthruster (25hp), bowthruster (25hp) & anchor winch

Navigational Equipment:

- Furuno Navnet combined colour radar/ chart-plotter with GPS
- Additional Furuno GD1900C (10.4") displays at lower helm and flybridge
- Raytheon autopilot
- Raytheon echo sounder and log
- Shipmate VHF radio with DSC R/T with intercom
- CCTV system linked to Navnet with engine room and aft facing cameras

Deck Equipment:

- Teak to flybridge deck
- Teak to side decks
- Teak to cockpit and bathing platform decks
- Flybridge tender crane (also spans bathing platform)
- Telescopic hydraulic passerelle
- Bimini top in navy Sunbrella
- Cockpit table
- Black net windscreen covers
- Side entry gates to port & starboard
- Third station engine and thruster controls at aft cockpit (inc windlass control)
- Avon 360 RIB with 40hp Yamaha four stroke outboard
- G6 Track Vision Satellite dish with dummy at radar arch

Ship systems:

- 22.5Kw ONAN diesel generator
- 2 x 75 amp float battery chargers

- 2 x 240v Shore support system. Separate circuits for auxiliary power and air-conditioning supply
- 5 Bladed propellers on Tenet shafts
- Electric trim tabs
- Holding tank system with vacuum flush toilets
- Full air conditioning to whole boat with heating on reverse cycle
- 4 underwater lights at transom

Interior arrangements:

- 8 berths in 4 cabins
- 4 heads (4 en-suite)
- 2 crew berths (aft cabin) with toilet and shower
- Natural light cherry wood interior
- Stone leather saloon upholstery
- 42" TV in saloon with DVD and surround sound system
- TV and DVD to all cabins (inc crew)
- Phone system/wireless/GPRS/fax
- Washer/drier in lazarette area
- Leather upholstery
- Crystal and china

Safety Equipment:

- Automatic electric bilge pumps with manual override
- Automatic fire extinguisher in engine room
- Liferaft
- 3 x Smoke alarms
- EPIRB

Miscellaneous:

- MCA Coded, SCV II examined for commercial operation as charter yacht
- One owner from new
- Jacuzzi in stateroom bath
- 2 complete sets of bed linen

Brochure layout Plan:

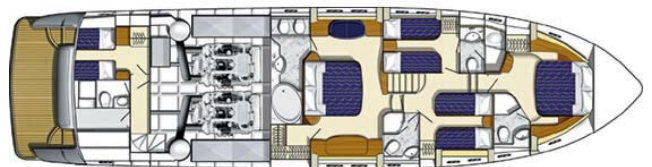

Whilst every care has been taken in the preparation of these particulars, their correctness is not guaranteed and they are intended as a guide only and do not constitute a part of any contract. A prospective purchaser is strongly advised to check these particulars and where appropriate and at his own expense to employ a qualified marine surveyor to carry out a survey and/or to have an engine trial conducted which if conducted by us shall not imply any liability on our part.

All dimensions, speeds & range given are approximate and should be treated as a guide only. Some pictures may be from brochures or of a similar boat. Engine hours shown are correct at the time of the preparation of the particulars, but will vary with usage. Please call to confirm availability of a specific boat