

**PRINCESS V58 • 2003 • Ref: PB716**

**Lying: UK South Coast**

**Price: £ 375,000**



Photo of Similar Boat

Open Cockpit Version  
Full Width Owner's Stateroom  
White Hull  
Twin 800hp MAN D2848 LE403 diesels  
Furuno colour radar/chart plotter  
Air-conditioning  
9.5kW generator  
Concealed telescopic passerelle  
Washer/dryer fitted to galley  
Bose 3-2-1 Digital home cinema system  
Random block teak floor to whole saloon  
Fawn leather upholstery  
Natural cherry woodwork

**Contact: Swanwick**

Tel: Int. +44 1489 557744

Fax: Int. +44 1489 557766

E-mail: [pbi@princess.co.uk](mailto:pbi@princess.co.uk)

**PRINCESS V58 • 2003 • Ref: PB716**

**Dimensions:**

- L.O.A: 18.19 metres (59 ft 8 in)
- Beam: 4.62 metres (15 ft 2 in)
- Draft: 1.13 metres (3 ft 8 in)
- Displacement: 23.5 Tonnes
- Fuel capacity: 2,500 Litres (550 Gallons)
- Water capacity: 473 Litres (104 Gallons)

**Propulsion:**

- Engines: 2 x 800 hp MAN D2848 LE403 diesel
- Engine hours: T.B.A.

**Navigational Equipment:**

- 9.5 hp Bow thruster
- Furuno NavNet 10.4" colour radar/GPS/plotter
- Raymarine Speed, Depth & Autopilot
- Simrad RD87 VHF radio/telephone

**Deck Equipment:**

- Electro-hydraulically opening garage with storage for tender/wet bike
- Electro-hydraulic concealed telescopic passerelle with remote control
- Electric anchor winch with the total of 50 m of chain (Additional 10m of anchor chain)
- Foredeck freshwater anchor/deckwash system
- Helm console in white GRP
- Cockpit table with support legs as per V50

**Ship Systems:**

- Continental 220/240V sockets
- Electric starboard wheelhouse windows
- Battery charger automatic float

**Air Conditioning:**

- Full Med specification, System B with reverse cycle heating

**Generator:**

- 9.5kW generator fitted in place of standard

**Safety Equipment:**

- Automatic fire extinguishers in engine room & generator space
- Automatic electric bilge pumps
- Hand operated fire extinguishers in cabin

**Interior Arrangements:**

- Full width Owner's stateroom
- 4 berths in 2 cabins
- 2 heads (2 en-suite)
- Natural cherry wood interior
- Random Block teak floor to whole of saloon
- Fawn leather upholstery
- Belgium black galley worktop
- Standard icemaker not fitted

**Interior Equipment:**

- Bose 3-2-1 digital home cinema system
- Washer/dryer fitted in galley
- Standard ice maker not fitted
- Courtesy lights fitted to wardrobes

**Notes:**

- Stunning open cockpit version with full width owner's stateroom

**Brochure Layout Plan:**

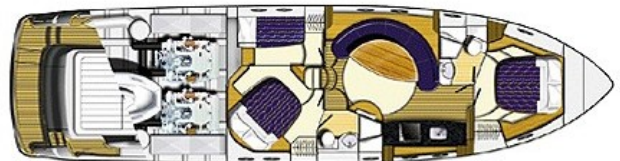
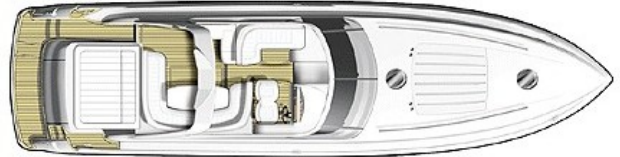

Standard Layout

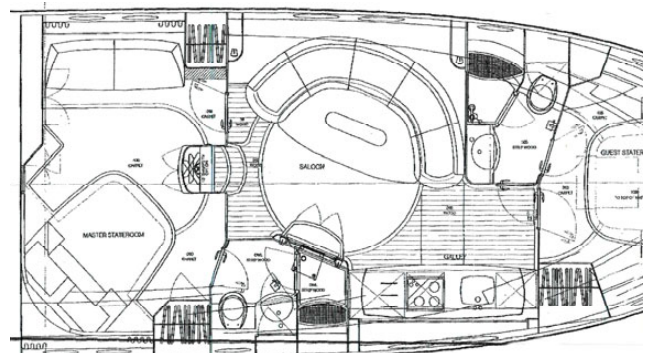

Full Width Owner's Cabin

Whilst every care has been taken in the preparation of these particulars, their correctness is not guaranteed and they are intended as a guide only and do not constitute a part of any contract. A prospective purchaser is strongly advised to check these particulars and where appropriate and at his own expense to employ a qualified marine surveyor to carry out a survey and/or to have an engine trial conducted which if conducted by us shall not imply any liability on our part.

All dimensions, speeds & range given are approximate and should be treated as a guide only. Some pictures may be from brochures or of a similar boat. Engine hours shown are correct at the time of the preparation of the particulars, but will vary with usage.

Please call to confirm availability of a specific boat