

FAIRLINE TARGA 44 GT • 2008 • Ref: PB789

Lying: Ireland

Price: £ 320,000



Similar Craft

Midnight blue hull

Twin 435hp Volvo Penta IPS600 diesels

Raymarine radar / chart plotter with 2x E80 displays

Eberspacher warm air heating system

American Cherry Gloss woodwork

Ivory leather upholstery

Windscreen Demisters

Toilet Holding tank

Teak Cockpit table

3x LCD TV & DVD

Onan Generator

Bow thruster

Contact: Swanwick

Tel: Int. +44 (0)1489 557744

Fax: Int. +44 (0)1489 557766

E-mail: pbi@princess.co.uk

FAIRLINE TARGA 44GT • 2008 • Ref: PB789

Dimensions:

- L.O.A: 13.68 metres (44 ft 11 in)
- Beam: 4.04 metres (13 ft 3 in)
- Draft: 1.01 metres (3 ft 4 in)
- Dry weight: 11,300Kg (11.12 Tons)
- Fuel capacity: 996 Litres (219 Gallons)
- Water capacity: 320 Litres (70 Gallons)

Propulsion:

- Engines: 2 x 435hp Volvo Penta IPS600 diesel engines with IPS drives
- Engine hours: 230 hours (January 2011)

Navigational Equipment:

- Bow thruster
- Raymarine radar / chart plotter / GPS with 2x Raymarine E80 displays
- Raymarine ST6001 autopilot
- VHF radio/telephone
- Trim tabs
- Remote control searchlight
- High speed magnetic compass

Deck Equipment:

- Cockpit wet bar with fridge, sink and icemaker
- Electric griddle in cockpit
- Blue mood lights
- Stainless steel pulpit & guard rails
- Teak cockpit deck
- Electric anchor windlass
- Teak cockpit table
- Black mesh screen cover
- Foredeck sunbathing cushions

Ship Systems:

- 240V Shore support system
- Inverter & breaker with audio visual system
- Automatic battery charger
- Onan 4Kw 240v 50Hz diesel generator with sound shield cabinet

Heating:

- Eberspacher warm air heating system with outlets in all cabins

Safety Equipment:

- Automatic fire extinguisher
- Automatic electric bilge pumps

Interior Arrangements:

- 4 berths in 2 cabins
- 2 heads (2 en-suite)
- Bed conversion to saloon settee
- American cherry gloss woodwork
- Ivory leather upholstery
- Black coral worktop

Interior Equipment:

- Stereo radio/CD/DVD player in saloon
- 19" LCD TV in saloon
- LCD TVs fitted to forward & aft cabins

Brochure Layout Plan:

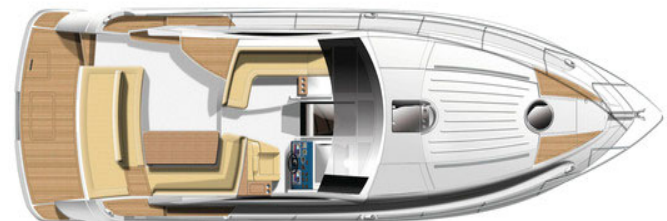
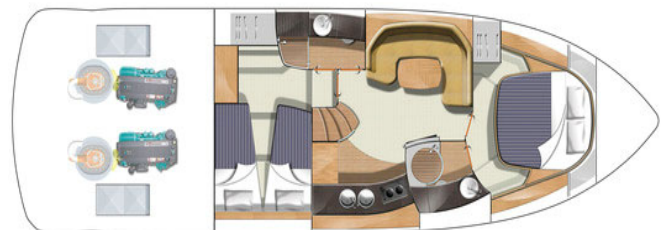

Whilst every care has been taken in the preparation of these particulars, their correctness is not guaranteed and they are intended as a guide only and do not constitute a part of any contract.

A prospective purchaser is strongly advised to check these particulars and where appropriate and at his own expense to employ a qualified marine surveyor to carry out a survey and/or to have an engine trial conducted which if conducted by us shall not imply any liability on our part.

All dimensions, speeds & range given are approximate and should be treated as a guide only. Some pictures may be from brochures or of a similar boat. Engine hours shown are correct at the time of the preparation of the particulars, but will vary with usage.

Please call to confirm availability of a specific boat