

# PRINCESSBROKERAGEINTERNATIONAL

A DIVISION OF PRINCESS INTERNATIONAL SALES & SERVICE LIMITED

SOUTHAMPTON | LONDON | PLYMOUTH | IRELAND | CHANNEL ISLANDS | GERMANY | SWITZERLAND | TURKEY | MALLORCA | SPAIN

[www.princess.co.uk/pbi](http://www.princess.co.uk/pbi) ————— [pbi@princess.co.uk](mailto:pbi@princess.co.uk)



Similar Yacht

## PRINCESS 85MY 2011

3,950,000 € ( Ex. VAT )

Lying: South of France Ref: PB884

Midnight blue hull

Twin CAT C32A 1,925hp engines

GRP hardtop with electric sunroof

TracStar digital fin stabiliser system

ARMANI custom interior fabrics and furniture

Cockpit Bar

Spa bath on flybridge

KVH Satellite TV System

KVH V-SAT Satellite Comms

Blue underwater transom lights

Premium Bose audio system

Walnut satin finish woodwork

Fresh water maker (160 litres/hour)



Southampton +44 (0)1489 557755 | London +44 (0)207 499 5050 | Plymouth +44 (0)1752 600657

Mainland Spain +34 952 818141 | Mallorca +34 971 676439

Princess Motor Yacht Sales is a division of Princess International Sales & Service Limited

Registered in England No: 829659 | Registered Office: 6 Athena Court, Athena Drive, Tachbrook Park, Warwick, CV34 6RT, England

# PRINCESSBROKERAGEINTERNATIONAL

A DIVISION OF PRINCESS INTERNATIONAL SALES & SERVICE LIMITED

SOUTHAMPTON | LONDON | PLYMOUTH | IRELAND | CHANNEL ISLANDS | GERMANY | SWITZERLAND | TURKEY | MALLORCA | SPAIN

[www.princess.co.uk/pbi](http://www.princess.co.uk/pbi) ————— [pbi@princess.co.uk](mailto:pbi@princess.co.uk)



Saloon



Saloon



Wheelhouse



Galley



Flybridge



Cockpit

# PRINCESSBROKERAGEINTERNATIONAL

A DIVISION OF PRINCESS INTERNATIONAL SALES & SERVICE LIMITED

SOUTHAMPTON | LONDON | PLYMOUTH | IRELAND | CHANNEL ISLANDS | GERMANY | SWITZERLAND | TURKEY | MALLORCA | SPAIN

[www.princess.co.uk/pbi](http://www.princess.co.uk/pbi) ————— [pbi@princess.co.uk](mailto:pbi@princess.co.uk)



Master Stateroom



Forward VIP Cabin



Master Stateroom



Foredeck Seating



Exterior



Flybridge

## Dimensions:

- L.O.A: 25.93 metres (85 ft 1 in)
- Beam: 6.30 metres (20 ft 8 in)
- Draft: 1.65 metres (5 ft 5 in)
- Displacement: 70 Tonnes
- Fuel capacity: 8,400 Litres (1,850 Gallons)
- Water capacity: 1,500 Litres (330 Gallons)

## Propulsion:

- Engines: 2 x 1,925 hp Caterpillar C32A diesel engines on shaft drives
- Engine hours: 163 hours as of Jan 2012

## Navigational Equipment:

- Furuno 3D colour radar / chart plotter with 2 x 12.1" displays at both lower & upper helm positions
- Dual station Raymarine speed & log
- Dual station Raymarine echo sounder
- Dual station VHF radio/telephone with DSC

## Ship Systems:

- Trac Star hydraulic digital fin stabiliser system
- Trac hydraulic bow and stern thrusters
- Colour CCTV camera system (5 cameras) interfaced and displayed on both helm stations, Master and crew mess with a selector switch at each station
- Fresh water maker (160 litres/hour)

- KVH Satellite TV system with European & Caribbean decoders in saloon and all cabins including crew.
- KVH Mini V-Sat V7 satellite Communication system
- ASEA Shore power voltage convertor unit

## Deck Equipment:

- GRP flybridge hardtop with electric opening sunroof and enclosure curtains
- Spa bath on flybridge
- Cockpit bar
- Flybridge tender crane
- Hydraulic raise/lower transom platform
- Side entry gates to port & starboard side decks
- Exterior upholstery in white Movida material
- Underwater transom lights (4 blue A12 PRO LED)
- Sunshade for forward seating area
- Teak cockpit, flybridge and side decks
- Cockpit and flybridge enclosure covers

## Generators:

- 2 x 27kW Onan 240v 50hz diesel generators
- Generator running hours:- 451 (port) and 355 (starboard)

## Air Conditioning:

- Full chilled water air conditioning system throughout boat with heating on reverse cycle with digital controls in each cabin



## Safety Equipment:

- Automatic fire extinguisher system in engine room
- Automatic electric bilge pumps
- Safety equipment including 2x canister liferafts

## Interior Arrangements:

- 10 berths in 4 cabins
- Custom starboard cabin with bunk beds for 4 (this can be converted back to the standard double bed if required by the buyer)
- 5 heads (4 en-suite + 1 day heads)
- Walnut woodwork with satin finish
- Armani designer interior scheme with Armani fabrics and upgraded lighting
- Armani 'Descartes' saloon coffee table and sofa fabrics
- Armani 'Rima' dining chairs
- Heavy velvet 'Granite' and 'Natural Steel Grey' carpets
- Black Amethyst Granite galley worktop
- 'Mocca Crème' Marble to all bathrooms
- Black out roller blinds in cabins
- Mood lighting fitted in all cabins and saloon
- Electric blinds in saloon

## Interior Equipment:

- Saloon LCD TV fitted to saloon sideboard on raise/lower system
- Bose Premium Audio upgrade system
- Dishwasher, icemaker, washing machine, dryer, wine cooler (12 bottle)
- Central vacuum system
- LCD TV & DVD/radio fitted in all cabins including crew area
- iPod docking stations in saloon and all cabins including crew area
- Additional combination washer/dryer fitted in crew cabin
- Intruder alarm fitted
- Additional bunk in crew cabin



# PRINCESSBROKERAGEINTERNATIONAL

A DIVISION OF PRINCESS INTERNATIONAL SALES & SERVICE LIMITED

SOUTHAMPTON | LONDON | PLYMOUTH | IRELAND | CHANNEL ISLANDS | GERMANY | SWITZERLAND | TURKEY | MALLORCA | SPAIN

[www.princess.co.uk/pbi](http://www.princess.co.uk/pbi) ————— [pbi@princess.co.uk](mailto:pbi@princess.co.uk)

## Brochure Layout Plan:

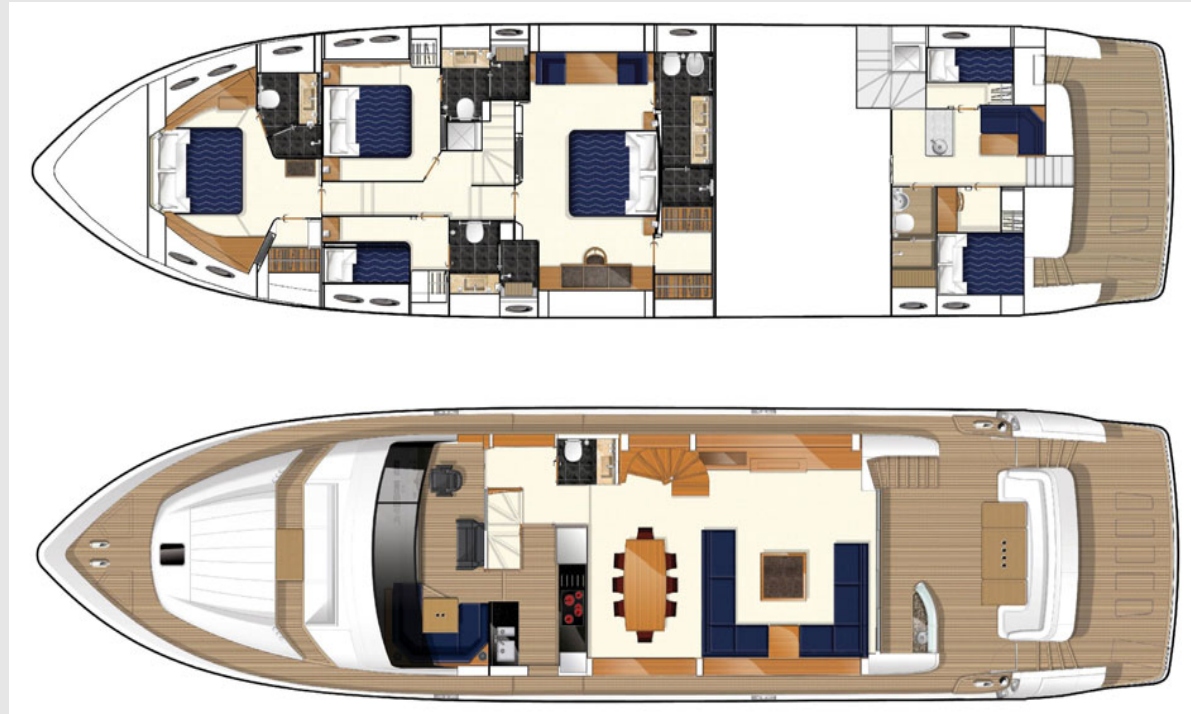

## Disclaimer:

In this case we are acting as Brokers only. The Vendor ~~is~~ is not selling in the course of a business. Whilst every care has been taken in their preparation, the correctness of these particulars is not guaranteed. The particulars are intended only as a guide and they do not constitute a term of any contract. A prospective buyer is strongly advised to check the particulars and where appropriate at his own expense to employ a qualified Marine Surveyor to carry out a survey and/or to have an engine trial conducted which if conducted by us shall not imply any liability for such engine on our part.



Southampton +44 (0)1489 557755 | London +44 (0)207 499 5050 | Plymouth +44 (0)1752 600657

Mainland Spain +34 952 818141 | Mallorca +34 971 676439