

Princess Motor Yacht Sales

International Distributors of Princess Motor Yachts

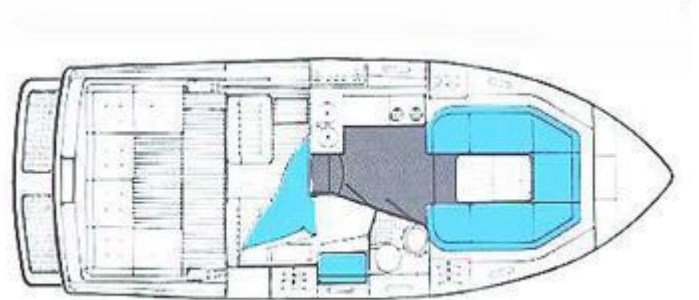

Princess 286 Riviera



Year Started:
1983

Year Finished:
1991

Length Overall (Inc Pulpit):
31ft 4in / 9.53m

Length Overall (Ex Pulpit):
30ft 0in / 9.14m

Beam:
11ft 0in / 3.351m

Draft:
2ft 9in / 0.84m

Approx. Displacement:
3.3 tonnes

Height Above Waterline to top of GRP radar arch:
8ft 2in / 2.54m

**Height Above Waterline to Top of Fixed Structure
(Excluding radar arch and light mast):**
6ft 10in / 2.08m

Usual Engines Fitted:

Option 1:
Twin Volvo AQAD41/DP (200hp diesels on sterndrives)

Option 2:
Twin Volvo AQAD30/DP (110hp diesels on sterndrives)

Option 3:
Twin Volvo AQ271/DP (270hp diesels on sterndrives)

"The World's Most Sophisticated Motor Yachts"