

# Princess Motor Yacht Sales

International Distributors of Princess Motor Yachts

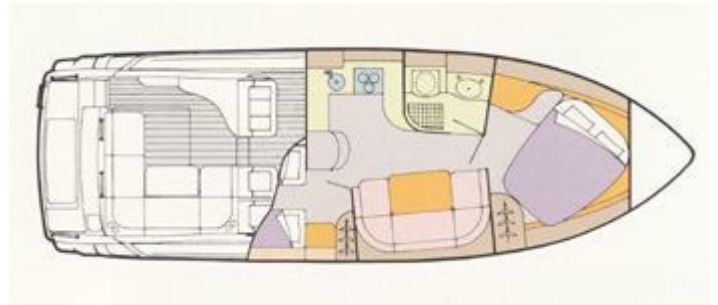

## Princess 346 Riviera



**Year Started:**  
1991

**Year Finished:**  
1992

**Length Overall (Inc Pulpit):**  
37ft 8in / 11.48m

**Length Overall (Ex Pulpit):**  
35ft 11in / 10.95m

**Beam:**  
11ft 6in / 3.50m

**Draft:**  
2ft 11in / 0.89m

**Approx. Displacement:**  
5.95 tonnes

**Height Above Waterline to top of GRP radar arch:**  
9ft 5in / 2.88m

**Height Above Waterline to Top of Fixed Structure  
(Excluding radar arch and light mast):**  
N/A

**Usual Engines Fitted:**

**Option 1:**  
Twin Volvo KAD42/DP (230hp diesels)

**Option 2:**  
Twin Volvo AD41/DP (200hp diesels)

**Option 3:**  
Twin Volvo AQ501/DP (231hp petrols)

*"The World's Most Sophisticated Motor Yachts"*