

Princess Motor Yacht Sales

International Distributors of Princess Motor Yachts

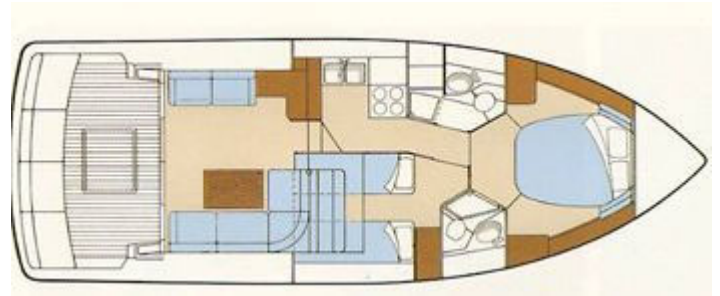

Princess 388



Year Started:
1988

Year Finished:
1991

Length Overall (Inc Pulpit):
41ft 6in / 12.34m

Length Overall (Ex Pulpit):
41ft 0in / 12.19m

Beam:
13ft 10in / 4.22m

Draft:
3ft 3in / 0.99m

Approx. Displacement:
8 tonnes

Height Above Waterline to top of GRP radar arch:
13ft 2in / 4.03m

**Height Above Waterline to Top of Fixed Structure
(Excluding radar arch and light mast):**
11ft 4in / 3.46m

Usual Engines Fitted:

Option 1:
Twin Volvo TAMD61 (306hp diesels)

Option 2:
Twin Cummins 6BTA (250hp diesels)

Option 3:
Twin Volvo TAMD41 (200hp diesels)

"The World's Most Sophisticated Motor Yachts"