

# Princess Motor Yacht Sales

International Distributors of Princess Motor Yachts

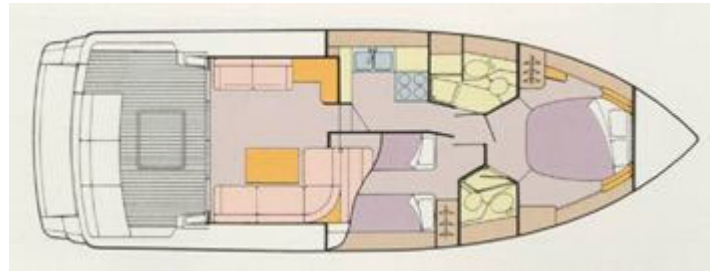

## Princess 398



**Year Started:**  
1991

**Year Finished:**  
1992

**Length Overall (Inc Pulpit):**  
41ft 8in / 12.70m

**Length Overall (Ex Pulpit):**  
40ft 8in / 12.40m

**Beam:**  
13ft 10in / 4.22m

**Draft:**  
3ft 3in / 0.99m

**Approx. Displacement:**  
8.9 tonnes

**Height Above Waterline to top of GRP radar arch:**  
13ft 2in / 4.03m

**Height Above Waterline to Top of Fixed Structure  
(Excluding radar arch and light mast):**  
11ft 4in / 3.46m

**Usual Engines Fitted:**

**Option 1:**  
Twin Volvo TAMD61 (306hp diesels)

**Option 2:**  
Twin Volvo TAMD71 (380hp diesels)

**Option 3:**  
Twin Cummins 6BTA (250hp diesels)

*"The World's Most Sophisticated Motor Yachts"*