

Princess Motor Yacht Sales

International Distributors of Princess Motor Yachts

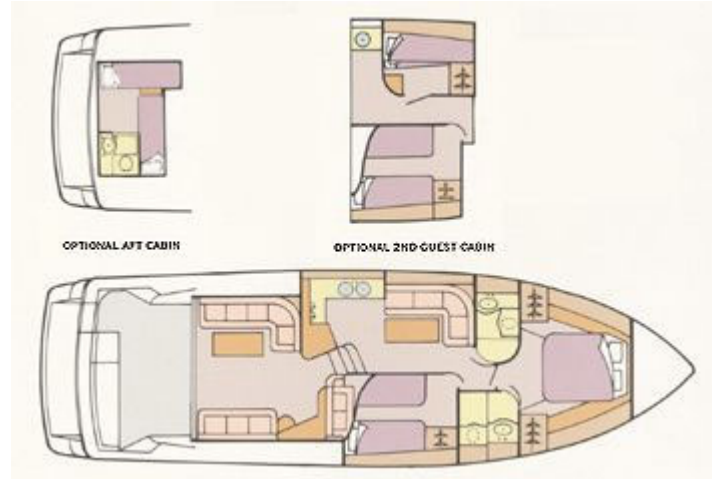

Princess 455



Year Started:
1991

Year Finished:
1993

Length Overall (Inc Pulpit):
50ft 0in / 15.24m

Length Overall (Ex Pulpit):
47ft 9in / 14.55m

Beam:
14ft 2in / 4.32m

Draft:
3ft 9in / 1.41m

Approx. Displacement:
13.75 tonnes

Height Above Waterline to top of GRP radar arch:
12ft 5in / 3.79m

**Height Above Waterline to Top of Fixed Structure
(Excluding radar arch and light mast):**
11ft 4in / 3.45m

Usual Engines Fitted:

Option 1:
Twin Volvo TAMD72 (430hp diesels)

Option 2:
Twin Volvo TAMD71B (380hp diesels)

Option 3:
Twin Volvo TAMD61 (306hp diesels)

"The World's Most Sophisticated Motor Yachts"