

## Princess 50 MkII



Flybridge Layout



Upper Accommodation Layout

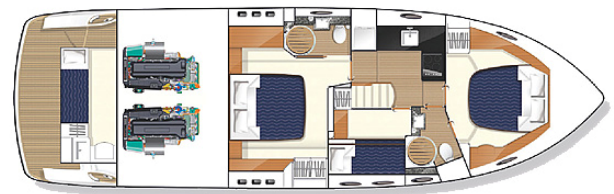

Lower Accommodation Layout

**Year Started:**  
2008

**Year Finished:**  
In Production

**Length Overall (Inc Pulpit):**  
50ft 5in (15.37m)

**Beam:**  
15ft (4.57m)

**Draft:**  
4 ft 2in (1.27m)

**Approx. Displacement:**  
19 tonnes

**Fuel capacity**  
560 gallons (2500 litres)

**Water capacity**  
130 gallons (592 litres)

**Usual Engines Fitted:**

**Option 1:**  
Twin Volvo D11-670 (670hp diesels)

*"The World's Most Sophisticated Motor Yachts"*