

Princess 560

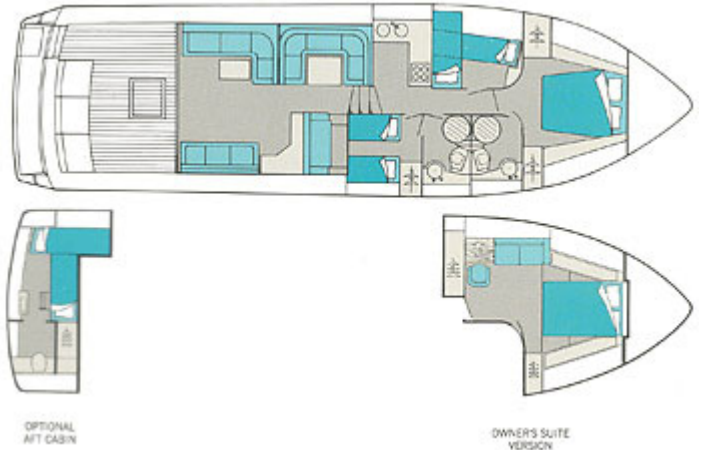

Year Started:
1992

Year Finished:
1993

Length Overall (Inc Pulpit):
57ft 3in / 17.45m

Length Overall (Ex Pulpit):
56ft 3in / 17.15m

Beam:
15ft 8in / 4.78m

Draft:
4 ft 3in / 1.30m

Approx. Displacement:
15.5 tonnes

Height Above Waterline to top of GRP radar arch:
15ft 5in / 4.70m

**Height Above Waterline to Top of Fixed Structure
(Excluding radar arch and light mast):**
12ft 8in / 3.86m

Usual Engines Fitted:

Option 1:
Twin Volvo TAMD122 (480hp diesels)

Option 2:
Twin GM Detroit 6V92TA (550hp diesels)

Option 3:
Twin Volvo TAMD2 (430hp diesels)

"The World's Most Sophisticated Motor Yachts"