

Flybridge layout

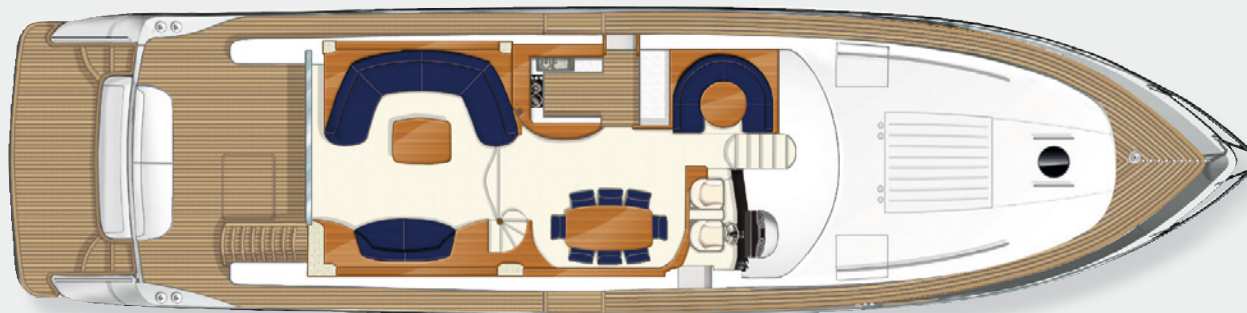

Upper accommodation layout

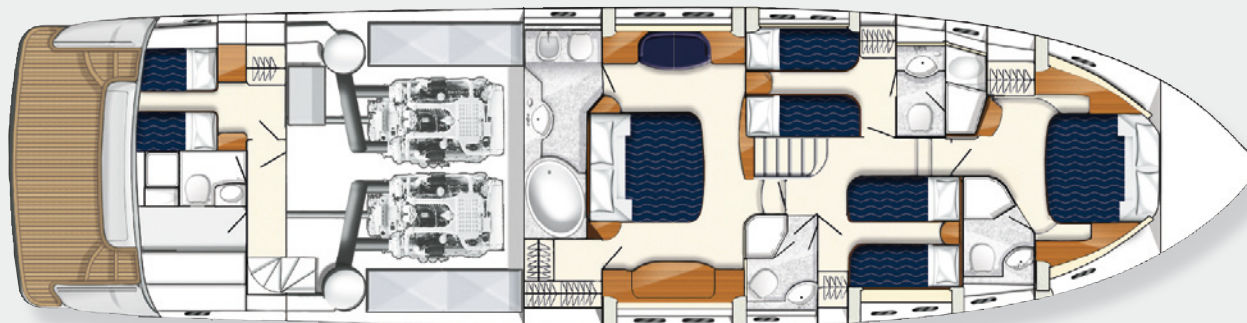

Lower accommodation layout

PRINCESS 23M

PRINCIPAL DIMENSIONS

Length overall (incl. pulpit)	74ft 11in (22.83m)
Length overall (excl. pulpit)	73ft 11in (22.53m)
Beam	18ft 9in (5.71m)
Draft	5ft 3in (1.6m)
Displacement approx. (Twin MAN 1360hp)	51.9 tonnes*
Fuel capacity	1270 gallons (5765 litres)
Water capacity (incl. calorifier)	305 gallons (1386 litres)

STANDARD EQUIPMENT

Power-assisted hydraulic steering system
Bow thruster (220kgf)
24v DC/240v AC electrical system
240v shore power with 2 x 75-amp float battery charger
220v/240v diesel generator (22.5kW)
Full air conditioning
Dual station remote control electric anchor winch
Deck/anchor wash
Electric stern rope mooring winches
Dual station electric trim tabs with indicators
Dual station autopilot
Dual station VHF with DSC R/T with intercom
Dual station colour radar/chart plotter/GPS
Dual station speed and distance log
Dual station echo sounder with alarm
Remote control searchlight
Combination microwave/conventional oven/grill
Refrigerator
Deep freeze

Cocktail cabinet with refrigerator
Icemaker
Flybridge wetbar including sink and electric barbecue
Flybridge refrigerator
Dishwasher
Laundry centre
Vacuflush toilets with holding tank
Saloon LCD TV with DVD and Bose surround-sound system
LCD TV/DVD/radio in both staterooms
Flybridge stereo CD/radio
Teak-laid transom platform/cockpit deck/flybridge stairway/ stairs to side decks
Teak laid side decks and flybridge
Flybridge sunbed and cushions
Helmsman's door to starboard side deck
Opening door to port side decks
Stainless steel framed saloon doors
Flybridge crane with tender and wetbike storage facility (also spans transom platform)
Remote control telescopic passerelle
Transom door
Hot and cold transom shower
Fully fitted crew cabin
Cockpit night covers

ENGINE OPTIONS - DIESEL

Twin MAN V12 1360 CRM	(2 x 1360hp)	Speed range: 30-32 knots †
Twin Caterpillar C32	(2 x 1572hp)	Speed range: 33-35 knots †
Twin Caterpillar C32	(2 x 1675hp)	Speed range: 36-38 knots †

PRINCESS 23M

DECK FITTINGS

- Teak laid transom platform, cockpit deck, flybridge stairway, stairs to side decks, side decks and flybridge
- Reversible electric anchor winch with foredeck, main helm and flybridge controls
- Stemhead roller with automatic anchor launch and retrieve
- 50kg Delta anchor with 90m of chain
- Twin stern rope mooring winches port and starboard
- Bow rope stowage locker
- Freshwater deck/anchor wash (with both foredeck and transom outlets)
- Coachroof sunbed recess with cushions
- Coachroof fender lockers (8 fenders)
- Stainless steel bow, stern, transom and spring cleats (2 pairs)
- Stainless steel pulpit and guard rails
- Forward coachroof handrails
- Canopy handrails
- White PVC high impact rubbing band with stainless steel insert
- Full set IMCO navigation lights
- Riding light
- Dual station remote control searchlight
- Twin electric horns
- Fuel and water fillers
- Transom deckwash point
- Telephone connection point
- Flybridge davit crane (420kg)
- Liferaft locker
- Stern mooring lights

AFT COCKPIT

- Self-draining
- Upholstered seating
- Deck lighting
- Cockpit cover
- Stainless steel handrails
- Remote control telescopic passerelle (3.2m)
- Transom garage with electro-hydraulic lift to door
- Transom bathing platform with dinghy/wetbike storage facilities and foldaway swimming ladder, hot and cold shower, teak sole and deck light
- Door leading to crew cabin, utility area and engine room area from side deck. Also watertight transom door giving direct access from bathing platform
- Locker housing 240v shore support inlet and shoreline
- Transom bathing platform stowage compartment

FLYBRIDGE

- Dual station instrument controls (see Lower Helm Position)
- Helm position featuring hydraulically raised instrument console with repeat engine instrumentation
- Bilge pump visual and audible warning indicators
- Engine room fire extinguisher warning system
- Chart area
- Additional seating around U-shaped sofa/dinette
- Sunbed
- Stereo CD/radio
- Aft access from cockpit via GRP hatch, forward access from saloon via door and stairway
- Wind deflector screens
- Stainless steel handrails
- Deck-level lighting
- GRP radar arch
- Console and seat covers
- Matched whip aerials for VHF/RT and radio
- Wet bar with refrigerator, sink, hot and cold water supply, barbecue hob and storage
- Electro-hydraulic crane for ship's tender/wetbike (suitable for lifting 420kg to flybridge and to transom platform)

LOWER HELM POSITION

- Burr elm instrument console with engine instruments and fuel gauges
- Dual station instruments and controls at Flybridge and Lower Helm Position:
 - rudder position indicator
 - electronic engine controls
 - power-assisted hydraulic steering
 - bow thruster control
 - remote control electric anchor winch
 - trim tab controls with indicators
 - autopilot
 - VHF with DSC R/T with intercom
 - colour radar and chartplotter/GPS
 - all electronic navigation equipment interfaced with radar and autopilot
 - speed and distance log
 - echo sounder with alarm
 - remote control searchlight
 - high-speed magnetic reserve compass
 - horn button
- Intercom to all cabins and engine room
- Automatic foghorn with loud hailer
- Twin leather upholstered helm seats with electric adjustment

LOWER HELM POSITION (CONTINUED)

- Triple windscreen wipers with windscreen wash
- Bilge pump controls
- 24v and 240v control panels
- PVC sunscreens
- Stainless steel framed toughened glass windscreen, clear for unimpaired night vision
- Helmsman's door to starboard side deck
- Glass partition to dining area with opaque/clear electronic control

DECK SALOON

- Large U-shaped sofa with coffee table
- 2 seater sofa
- Entertainment centre incorporating LCD screen TV/DVD/radio linked to Bose surround-sound system
- Cocktail cabinet with refrigerator and bottle and glass storage
- Curtains or blinds to all windows
- Overhead downlighters and pelmet lights
- Stainless steel framed aft cockpit door and electric drop window to cockpit area

Dining area:

- Separate dining area (8 chairs) and sideboard storage unit

GALLEY

- Granite or Avonite worktop
- Ceramic 4-ring hob
- Extractor fan
- Combination microwave/conventional oven with grill
- Twin-bowl stainless steel sinks with mixer tap
- Full height refrigerator with door and drawers and integral ice maker, separate drawer style deep freeze
- Dishwasher
- Trash compactor
- Overhead and concealed lighting
- Drawers and storage cupboards
- Laid timber floor
- Sliding bar aperture to saloon
- Opening door to port side deck

ACCOMMODATION

- All cabins are fitted with opening and/or fixed portholes, air conditioning outlets and 240v power points
- All en-suites feature freshwater Vacuflush toilets and 240v shaver points

OWNER'S STATEROOM

- Large double bed with drawers below
- Bedside cabinets
- Mirror
- Walk-in wardrobe with additional storage
- Dressing table with stool
- LCD TV/DVD/radio
- Sofa
- Triple vertical portlights (with one opening) port and starboard
- Writing desk
- Chest of drawers
- Overhead cupboards
- Storage units
- Downlighters, concealed lights and reading lights
- Intercom

Owner's en-suite bathroom:

- Large washbasin with mixer tap set into Avonite vanity top
- Bath/shower (with body jets) with automatic pump-out and extractor vent
- Bidet
- Towel locker
- Mirrors
- Stowage lockers

FORWARD STATEROOM

- Large double bed with drawers below
- Twin wardrobes with shelves
- Mirror
- Dressing table with stowage
- LCD TV/DVD/radio
- Sideboard with stowage
- Downlighters, concealed lights and reading lights
- Intercom
- Deck hatch

En-suite shower/WC:

- Washbasin with Avonite worktop and mixer taps
- Shower cubicle with automatic pump-out and extractor vent
- Towel locker
- Mirrors
- Storage lockers

PORT AND STARBOARD GUEST CABINS

- 2 single beds with storage under berths
- Large wardrobe with shelves
- Bedside table with storage
- High-level lockers
- Downlighters and reading lights
- Intercom

PORT AND STARBOARD GUEST CABINS (CONTINUED)

Port and starboard en-suite shower/WC's:

- Shower cubicle with automatic pump-out and extractor vent
- Mirrors
- Storage lockers
- Washbasin with Avonite top and mixer tap
- Starboard shower/WC has access door from passageway as well as from cabin

AFT GUEST CABIN/CREW CABIN

- 2 single berths
- Hanging and storage lockers
- Downlighters
- Reading lights
- Intercom
- Access via stairway from cockpit or from transom hatch via utility room

Shower/WC:

- Washbasin with mixer tap
- Shower stall with automatic pump-out and extractor vent
- Mirror
- Stowage under sink
- Overhead locker

UTILITY AREA

- Access from transom hatch or via cockpit stairway
- Storage space, cupboards and lockers
- Washing machine/dryer
- Vacuum cleaner

POWER AND DRIVE SYSTEMS

- Raw water flow failure light and audible alarm at the flybridge and lower helm stations
- 5-bladed propellers in nickel aluminium bronze
- 220kgf electric bow thruster with dual-station controls (with 2 additional heavy duty batteries linked to engine start batteries)
- Engine room lighting
- Engine room access located from the side deck under the flybridge stairs
- Power-assisted hydraulic steering system
- Trim tabs with indicators
- Electronic engine and gear shift controls
- Engine room extractor fans with electronic time delay

ELECTRICAL SYSTEM

24 Volt:

- 4 x heavy-duty batteries for engine starting and windlass operation (110AH each)
- 4 x heavy-duty auxiliary batteries (200AH each)
- Engine alternators charge via diode system to isolate engine start batteries from auxiliaries
- 2 x 75-amp float battery chargers for auxiliary batteries and 1 x 5-amp float battery charger for engine start batteries
- Remote battery master switches with control switch at main switch panel
- Circuit breakers on all circuits
- 24-12v dropper for certain navigation and radio circuits

220/240 Volt:

- 22.5kW diesel generator in own soundproof shield with water-cooled and specially silenced exhaust
- Automatic fire extinguisher situated by generator linked to main fire extinguisher system
- 2 x 50-amp shore support inlets
- Generator/shore support change-over switches
- Polarity check system
- Earth leakage safety trip, circuit breakers on all circuits
- Power points (240v) in:
 - owner's stateroom (2)
 - forward stateroom (2)
 - port and starboard cabins
 - crew cabin
 - galley (2 double)
 - saloon (2)
 - dining area
 - utility area

AIR CONDITIONING SYSTEM

- Aft saloon – 24000 BTU twin outlets
- Forward saloon, helm and galley – 30000 BTU
- Owner's stateroom and bathroom – 16000 BTU
- Port and starboard guest cabins – 1 x 7000 BTU each with outlets in cabin and bathroom
- Forward guest cabin and bathroom – 1 x 10000 BTU with outlets in cabin and bathroom
- Aft cabin – 1 x 10000 BTU with outlets in cabin and bathroom

FUEL SYSTEM

- Twin fuel tanks with interconnection system giving 1270 gallons (5765 litres) capacity
- Fuel fillers on port and starboard side decks
- High-capacity duplex fuel filters with water separators and change-over valves, water sensors connected to warning system at both helm positions
- Remote-operated fuel cocks
- Fuel gauges at lower helm position

WATER SYSTEM

- Water tanks totalling 260 gallons (1182 litres) with 45 gallons (205 litres) hot water calorifier
- Water heated by engines and 240v immersion heater
- Automatic water pump with filter
- Main circuit breaker at switch panel
- Water level gauge
- Deck fillers port
- Pressurised freshwater WC system (with water-saving vacuum-flush system) linked to 100 gallons (457 litres) holding tank
- Holding tank dock side and overboard discharge with low-noise electric pump and macerator back-up system
- Holding tank level gauge on main switch panel

FIRE EXTINGUISHERS

- Automatic/manual override fire extinguishers in engine room and generator space with warning system at both helm positions and incorporating engine air vent closure system
- Hand-operated fire extinguishers in:
 - owner's stateroom
 - forward stateroom
 - port and starboard cabins
 - galley
 - utility room
 - lower helm position
 - crew cabin
- Separate automatic fire extinguisher fitted in electrical space

BILGE PUMPS

- 7 x automatic electric bilge pumps with manual override in accommodation area (3), engine room (2) and lazarette (2)
- Electric bilge pumps have controls and warning lights at lower helm and warning light with audible alarm at flybridge helm
- Manually operated high-capacity pump with valve system and additional suction points in lazarette, engine room and other accommodation areas

OTHER ITEMS SUPPLIED AS STANDARD

- Set of cutlery and crockery for 8
- Set of crystal glasses
- Set of towels (8 large, 8 hand)
- Fenders (8) and warps (4)
- Ensign staff
- First aid kit
- Boathook
- Owner's manual and engine manual and tools
- Quilted bedspreads for beds in owner's stateroom, forward guest cabin, port and starboard cabins (except crew cabin)
- Electric vacuum cleaner
- Cockpit cover
- Ship's document case