

PRINCESS

A BEAUTIFUL OBSESSION





PRINCESS 43

BEAUTIFULLY CONSTRUCTED, IMMACULATELY FINISHED.

This incredibly spacious new yacht delivers impeccable performance and seakeeping with efficient cruising across a wide range of speeds, combined with straightforward handling, comfort and elegance. She truly is a remarkable feat of design and engineering excellence.

Twin transom gates lead from the optional bathing platform to the teak-laid cockpit. Move up to the impressive flybridge, with its generous seating and dining area, as well as forward seating that converts to a sunbed, and you'll discover plenty of space to entertain guests.

CRAFTED FURNITURE, INTELLIGENTLY ARRANGED.

Sliding glass doors lead from the large cockpit to the generously proportioned, contemporary, light-filled saloon. Your galley features all the amenities of a modern kitchen, while the well-appointed, luxurious cabins and bathrooms offer all the space you need.

Beautifully styled with the latest fabrics and furnishings, being on board is a true pleasure for the whole family.



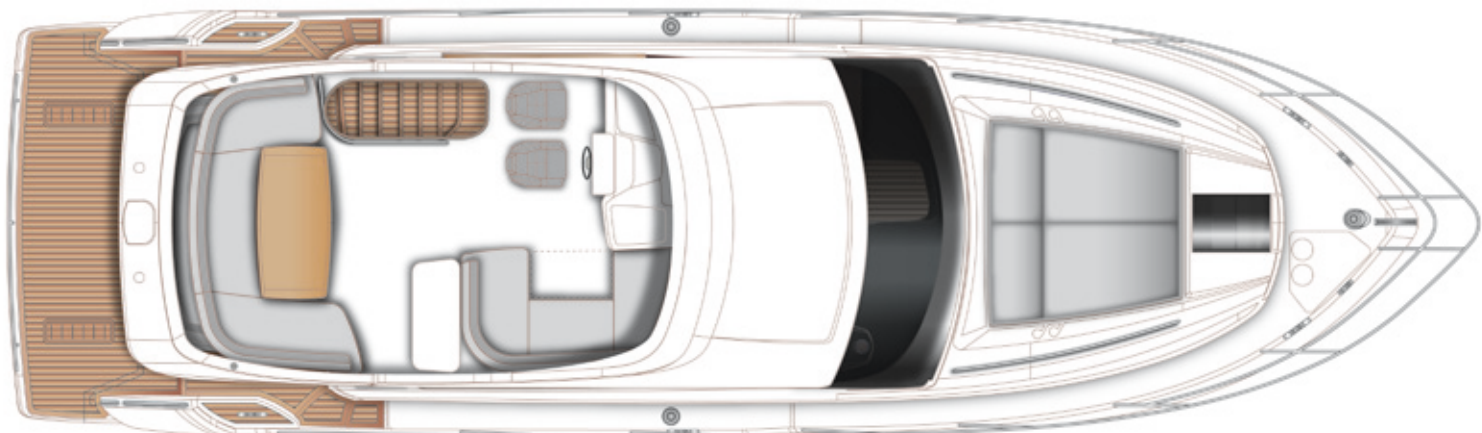

FLYBRIDGE LAYOUT

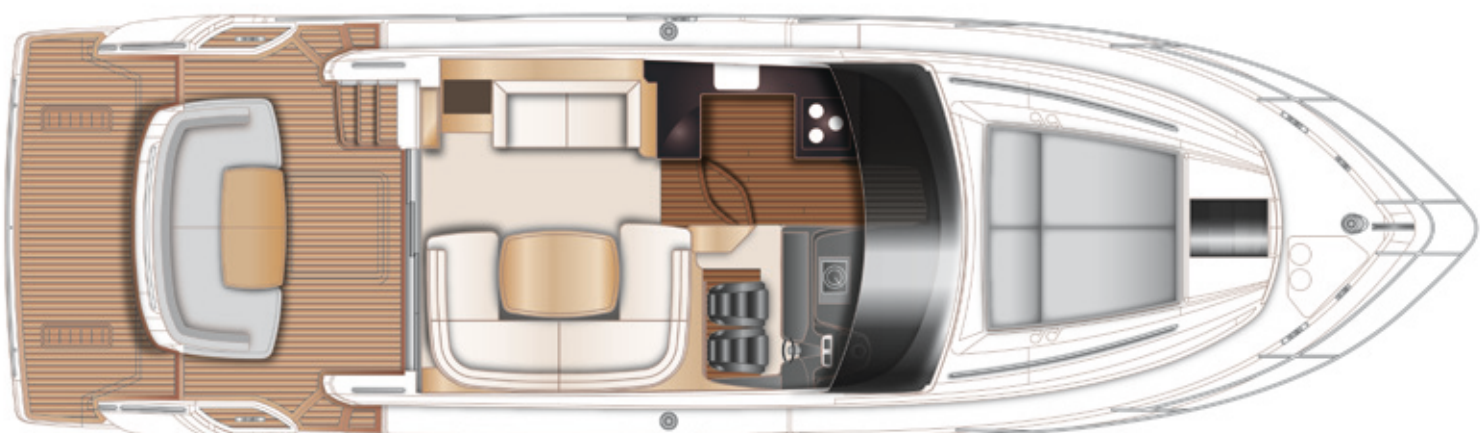

MAIN DECK LAYOUT

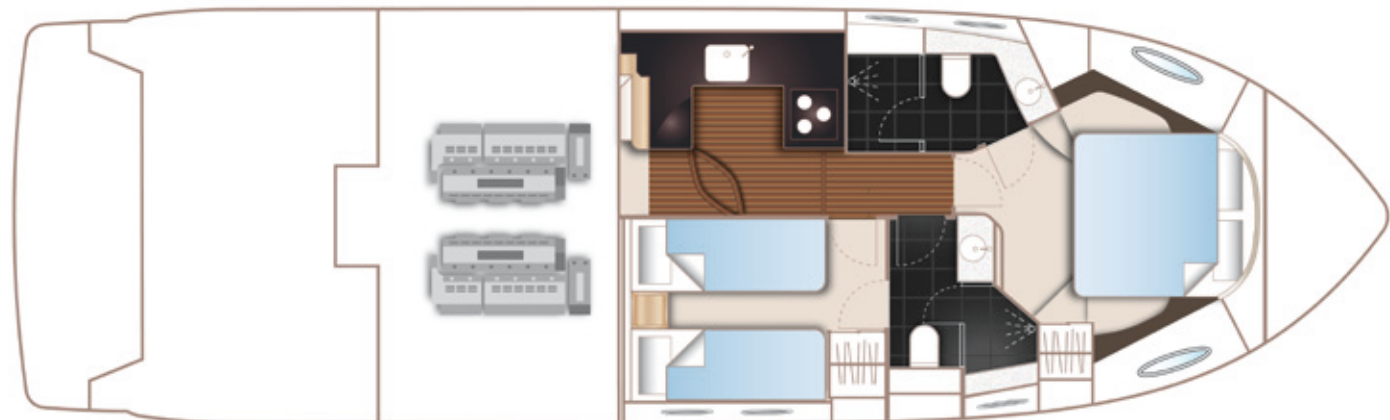

LOWER ACCOMMODATION LAYOUT

PRINCIPAL DIMENSIONS

Length overall (incl. pulpit)	47ft 6in (14.5m)
Length overall (excl. pulpit)	46ft 4in (14.14m)
Beam	13ft 11in (4.25m)
Draft (at full load) approx.	3ft 9in (1.14m)

Displacement approx.	14,400kg (31,700lbs)*
Fuel capacity	300 gal/360 US gal/1,363l
Water capacity (incl. calorifier)	100 gal/120 US gal/455l

ENGINE OPTIONS – DIESEL

Twin Volvo D6-370 (2 x 370mhp)	Speed range: 27-29 knots†
Twin Volvo D6-435 (2 x 435mhp)	Speed range: 30-32 knots†

DECK FITTINGS

- Teak-laid transom platform, cockpit deck, flybridge, stairway and stairs to side decks
- Reversible electric anchor winch with foredeck, main helm and flybridge controls
- Stemhead roller with automatic anchor launch and retrieve
- Self-stowing 20kg/44lbs Delta anchor with 40m of chain
- Deck hatch access to chain locker
- Stainless-steel bow, stern and spring cleats
- Stainless-steel bow and stern fairleads
- Stainless-steel pulpit and guardrails
- Stainless-steel coachroof and flybridge handrails
- Foredeck hatch
- PVC rubbing band with stainless-steel insert
- Full set of IMCO navigation lights
- Riding light
- Searchlight with dual-station remote controls
- Twin electric horns
- Fuel and water filters
- Coachroof sunbed recess

AFT COCKPIT

- Self-draining
- Upholstered seat with stowage space below
- Teak folding table
- LED overhead and deck level lighting
- Stainless-steel handrails
- Lockable gas strut assisted hatch to engine room/lazarette
- Overboard vented, self-draining locker for 2 gas bottles
- Twin transom doors leading to bathing platform
- Transom bathing platform with foldaway swimming ladder, hot and cold shower
- Dinghy chock system
- 220/240v shore support inlet and cable stowage locker
- Reserve manual bilge pump with valve chest in locker
- Remote fuel cocks located in locker
- Fender storage
- Life raft storage locker
- Integral stairway to flybridge with teak treads
- Steps to side deck
- Cockpit cover
- Electro-hydraulic raise/lower mechanism for transom platform (suitable for a tender up to 400kg) is optionally available

FLYBRIDGE

- Dual station instrumentation and controls (see Lower Helm Position for details)
- Helm position featuring adjustable wheel
- Audible and visual alarm for bilge pumps
- Twin helm seats with fore and aft adjustment for helmsman
- Large U-shaped upholstered seating
- L-shaped seat (converts to sunbed)
- Folding teak table
- Loudspeakers linked to saloon stereo
- Clearview hatch to aft cockpit
- Wind deflector screens
- Stainless-steel handrails
- GRP radar arch
- Console and seat covers
- Twin matching whip aerials for VHF R/T and radio
- Refrigerated top loading coolbox
- Optional wetbar with electric barbecue

LOWER HELM POSITION

- Twin helm seats with fore and aft adjustment for helmsman
- Instrument console with engine instruments and fuel gauges
- Dual station instruments and controls at Flybridge and Lower Helm Positions:
 - rudder position indicator
 - electronic engine controls
 - audible and visual engine warning system
 - electronic steering with hydraulic back-up system
 - bow thruster control
 - electric anchor winch remote control
 - trim tab controls with indicators

LOWER HELM POSITION (continued)

- VHF with DSC R/T with intercom to flybridge
- speed and distance log
- echo sounder with alarm
- autopilot
- remote control searchlight
- high speed magnetic compass
- horn button
- Chart table with light and chart stowage
- Windscreen wipers with freshwater windscreen wash system
- Bilge pump controls with visual pump running warnings
- 24v and 220/240v electrical control panels
- Black mesh sunscreen
- Riding light, helm and navigation light control switches
- Stowage under helm seat
- 12v outlet
- Red night lighting
- Sliding tinted side window adjacent to helmsman

DECK SALOON

- Triple stainless-steel framed sliding doors to cockpit
- U-shaped sofa with dining table to starboard (converts to double berth)
- Moveable 2-seater sofa
- Radio/iPod/MP3 player with saloon and flybridge speakers
- Sideboard units with glass, bottle and general stowage and space for optional refrigerator
- Curtains, venetian blinds or sunscreens to all windows and doors
- LED overhead and concealed lighting (24V)
- Tinted side windows
- Clock with barometer

GALLEY

- Avonite worktop
- Recessed 3-zone gas hob with flame-failure protection and cover
- Hob extractor
- Combination microwave/conventional oven with grill
- Stainless-steel sink with mixer tap
- Refrigerator with freezer compartment
- Waste bin
- LED overhead and concealed lighting (24V)
- Dedicated crockery and cutlery stowage
- General storage cupboards
- Chopping board
- Under floor storage compartment
- Lift up stairs with storage compartment and provision for washer/dryer
- Provision for dishwasher

ACCOMMODATION

- All cabins and bathrooms feature opening portholes
- All cabins feature 220/240v power points
- All bathrooms feature electric quietflush toilets and 240v shaver points

OWNER'S CABIN

- Large double bed with drawers below
- Wardrobe with shelves
- Dressing table
- Mirror
- Storage lockers and drawers
- Deck hatch with flyscreen and blind
- LED overhead and concealed lighting (24V)
- Individual berth lights
- Fitted carpet

En-suite bathroom:

- Washbasin with Avonite worktop
- Mirror
- Storage lockers
- Shower compartment with automatic pump-out
- Extractor fan
- LED overhead and concealed lighting (24V)
- Bathroom accessories
- Tiled flooring

STARBOARD GUEST CABIN

- Two single beds with pocket sprung mattresses and storage below (with option of two single electrically powered sliding beds to create a double bed)
- Bedside table
- Wardrobe with shelves
- Mirror
- Storage lockers and drawers
- LED overhead and concealed lighting (24V)
- Individual berth lights
- Fitted carpet

En-suite bathroom:

- Washbasin with Avonite worktop
- Mirror
- Storage lockers
- Shower compartment with automatic pump-out
- Extractor fan
- LED overhead and concealed lighting (24V)
- Bathroom accessories
- Tiled flooring
- Day access door from passageway

FINISHES

- Teak-laid decks to transom platform, steps to side decks and steps to flybridge
- Timber-laid floor to galley
- Furniture in choice of oak, cherry or walnut wood with satin or gloss lacquer finishes
- Tiled floors in all bathroom suites in guest accommodation
- Avonite wash hand basin counter tops in all bathroom suites in guest accommodation
- Galley worktop in Avonite
- Choice of high quality carpet and upholstery fabric from extensive range
- Curtains, blinds or sunscreens to all windows and portholes

POWER AND DRIVE SYSTEMS

- 4-bladed propellers in nickel aluminium bronze
- Bow thruster (80kg/176lb) with dual-station controls
- Engine room lighting
- Electronic steering system with hydraulic backup
- Lockable access hatch and ladder from cockpit to engine room/lazarette
- Trim tabs with indicators
- Electronic engine and gear shift controls
- Engine room extractor fan

ELECTRICAL SYSTEMS

24 Volt:

- 2 x heavy-duty batteries for engine starting
- 4 x heavy-duty auxiliary batteries
- Battery link facility with remote control at helm position
- Both battery banks are charged using a voltage sensitive relay that parallels both battery banks when a charging source is present.
- 60 amp 24v battery charger
- Remote battery master switches with control switch at main switch panel
- Circuit breakers on all circuits.
- 24v to 12v voltage dropper on certain navigation and radio circuits

220/240 Volt:

- Shore support inlet in cockpit locker with storage for cable
- Polarity check system
- Earth leakage safety trip
- Circuit breakers on all circuits
- Power points (240v) in:
 - forward stateroom
 - starboard cabin
 - galley
 - saloon
- Shaver points in both bathrooms

FUEL SYSTEM

- Twin fuel tanks (in NS8 marine grade alloy) with interconnection system giving 300 gallons/360 US gallons/1363 litres capacity
- Fuel fillers on port and starboard side decks
- High-capacity fuel filters/water traps
- Remote fuel cock controls in cockpit locker
- Fuel gauges at lower helm position

WATER SYSTEM

- Water tank of 93 gallons/112 US gallons/423 litres plus 7 gallon/8 US gallon/32 litres hot water calorifier (total 100 gallons/120 US gallons/455 litres)
- Water heated by engine and 240v immersion heater
- Automatic water pump with filter
- Main circuit breaker at switch panel
- Water level gauge
- Deck filler

FIRE EXTINGUISHERS

- Automatic/manual override fire extinguishers in engine room with warning system at Flybridge and Lower Helm Position
- Hand-operated fire extinguishers (4) in forward stateroom, starboard cabin, galley and lower helm

BILGE PUMPS

- Automatic electric bilge pumps (with manual override) in engine room, forward accommodation and aft lazarette (4 in all)
- High-capacity manual bilge pump with valve system and suction points in same areas

OTHER ITEMS SUPPLIED AS STANDARD

- Ensign staff
- Fenders (4)
- Mooring warps (4)
- First Aid kit
- Tool kit
- Boat hook
- Owner's manual and engine manual
- Quilted bedspreads supplied to all cabins
- Ship's document case
- Anchor winch back up handle

*Displacements are calculated with 50% fuel and water but with no optional equipment fitted or other gear or crew aboard.

†Maximum speeds will vary depending on cleanliness of hull, condition of sterngear, loading of craft, water and air temperatures, sea conditions and other factors. Speed estimates are therefore given in good faith but without warranty or liability on the part of Princess Yachts International plc.

Craft illustrated in this brochure may be fitted with certain optional equipment. Specifications may be changed at any time without notice or liability.

USA Specification

‡Princess yachts built for use in North America are certified by the National Marine Manufacturer's Association (NMMA) to comply with safety recommendations set forth by the American Boat and Yacht Council (ABYC) and with standards established by the United States Coast Guard Office of Boating Safety. In addition, certain other specifications, which vary by model, are upgraded on Princess yachts built for use in North America. Thus, specifications and equipment will vary from the information listed in the brochure for North American Princess yachts (e.g. air-conditioning and an upgraded generator will be included as standard for all North American models and electric cooking facilities will be supplied in place of gas systems). Please consult the USA Specification Brochure for full details regarding the North American specifications for individual models.

PRINCESS YACHTS
INTERNATIONAL PLC
Newport Street
Plymouth
Devon PL1 3QG
United Kingdom

Tel: +44 (0)1752 203888
Fax: +44 (0)1752 203777

info@princessyachts.com

princessyachts.com