

Princess 49

€780,000 INC VAT

Year **2017** 

Lying **Palma, ES** 

Ref **PB2405** 



OPEN TO PART EXCHANGE • PRINCESS TECHNICAL ORIENTATION INCLUDED

PROFESSIONAL PHOTOGRAPHY AND VIRTUAL TOUR AVAILABLE

EU Tax Paid • Twin Volvo IPS 700 (550mhp) Diesel engines • White hull • Walnut interior wood satin finish • 3 cabins accommodating 6 guests • Teak laid flybridge deck, side decks and foredeck • Onan 11kW Generator • Seakeeper NG5 Gyro Stabiliser • Reverse cycle air-conditioning and heating • Bow thruster • Volvo IPS DPS • Stern camera facing bathing platform • ZEN 30 touch 24V watermaker • Electro-hydraulic transom platform • Passarelle • Flybridge wetbar

Princess 49

€780,000 INC VAT

Year **2017** 

Lying **Palma, ES** 

Ref **PB2405** 

- WiFi • Apple TV

PLEASE CONTACT US FOR MORE INFORMATION ON THIS PRINCESS 49 FOR SALE

INFORMATION & FEATURES

Volvo IPS 550mhp

| | | | |
|--------------|----------------|---------------|---------------|
| Engine Type: | Inboard | Power: | 550 hp |
| Fuel Type: | Diesel | Engine Hours: | 450 |

Volvo IPS 550mhp (Engine 2)

| | | | |
|--------------|----------------|---------------|---------------|
| Engine Type: | Inboard | Power: | 550 hp |
| Fuel Type: | Diesel | Engine Hours: | 450 |

Dimensions

| | |
|-------|-----------------|
| LOA: | 51ft |
| Beam: | 14ft 3in |

Tanks

| | |
|--------------|---------------|
| Fuel: | 1800 l |
| Fresh Water: | 382 l |

Accommodations

Other

| | |
|----------------|-------------------|
| Hull Colour: | White hull |
| Hull Material: | Fiberglass |

Navigation Equipment

- International VHF
- Volvo IPS DPS (GPS hold system)

Princess 49

€780,000 INC VAT

Year **2017** 

Lying **Palma, ES** 

Ref **PB2405** 

- Seakeeper NG5 Gyro Stabiliser
- Volvo Automatic Interceptor trim tabs
- Garmin XHD colour radar with 24", 4Kw Radome (with display on standard 16" screen which allows separate or split displays with standard chartplotter and engine instrumentation)
- Second Garmin 16" colour multifunction display at the lower helm
- Second Garmin 16" colour multifunction display at the upper helm
- European version plotter charts
- Garmin AIS 600 Class B transponder
- Stern camera facing end of bathing platform connected to Garmin navigation screens at upper and lower helms

Deck Equipment

- Teak laid Flybridge deck, side decks and foredeck
- Transom platform with electro-hydraulic raise/lower facility (450kgSWL-maximum tender 300kg) with dinghy chock system
- Passerelle (2.9m telescopic letterbox type)
- Additional 10m of 10mm Anchor Chain (Total = 50m)
- Foredeck freshwater Anchor / deckwash system
- Electric stern docking winches
- Flybridge wet bar incorporating sink, electric griddle/BBQ and storage
- Hi-Low electric saloon table
- Folding cockpit table
- Underwater transom lights (2 Lumishore SMX95 Blue)
- Bimini top in two tone Sunbrella with linen underside
- Bimini top - Charcoal Grey Sunbrella canvas
- Foredeck suncushions in Movida Met with contrast colour to base cushions and headrest upstands
- Bimini top includes LED overhead lighting
- White mesh windscreen covers
- Cockpit third station

Ship Systems

- Onan 11kW generator with hydrohush exhaust

Princess 49

€780,000 INC VAT

Year **2017** 

Lying **Palma, ES** 

Ref **PB2405** 

- Reverse cycle air-conditioning/Heating: 56,000 BTU tropical specification up to 40 degree C (includes outlets in all cabins, bathrooms and additional 50A shore support fitting)
- Bow thruster (120Kgf/265lbf) with dual controls
- ZEN 30 touch 24V watermaker
- Continental 220V/240V Sockets
- Waterproof 220V/240V socket in lazarette
- Holding tank has electric overboard discharge as well as reserve manual and dockside discharge arrangements

Interior Fitout

- Walnut interior wood Satin finish
- Carrra White galley worktop
- Walnut flooring to saloon, galley, Helm, stairs (carpet to lower passageway and cabins only)
- Gold Bullion venetian blinds in saloon and aft galley
- Bathroom floors in Carrera White (gloss)
- 3 cabins, sleeps 6
- All cabins and bathrooms feature opening portholes
- Opening window to portside of saloon
- Icemaker fitted in aft Saloon sideboard
- Platinum II leather upholstery in deck saloon
- Vi spring mattresses
- All bathrooms feature full shower stalls, electric freshwater toilets, extractor fan and 240V shaver points

Interior Equipment

- 3-zone ceramic hob
- Hob extractor
- Combination microwave/conventional oven with grill
- Stainless steel sink with mixer tap
- Refrigerator with freezer compartment
- Second fridge in aft saloon sideboard
- Princess glasses (6 wine, 6 tumblers)
- David Mellor 'Paris' cutlery (6 pieces,6 settings)

Princess 49

€780,000 INC VAT

Year **2017** 

Lying **Palma, ES** 

Ref **PB2405** 

- Princess china (5 piece, 6 place settings)
- Mosquito screens for all opening portlights

Audio Visual Equipment

- WiFi - 4G and Hotspot Connection
- New Fusion HiFi
- Apple TV
- ZEN 30 touch 24V
- Deck Saloon - 40" HD LED TV (with 3D capability) on a power lift mechanism (radio/iPod/MP3 is upgraded to a Fusion MS-AV750 Radio/DVD/MP3 player with Bluetooth facility)
- Deck Saloon - Harmon Kardon 2.1 Blu-ray system Bluetooth connectivity and KEF speakers (when optional TV is selected) in place of Fusion MS-AV750
- Cockpit - Fusion RA200 radio with waterproof speakers linked to the saloon Harman Kardon unit, Flybridge - Fusion MS-UD650 radio/iPod/MP3 player with waterproof speakers
- Exterior Fusion speakers upgraded to SG-F65

Broker Comments

- Coppercoat hull treatment

Disclaimer

In this case we are acting as Brokers only.

The Vendor is not selling in the course of a business. Whilst every care has been taken in their preparation, the correctness of these particulars is not guaranteed. The particulars are intended only as a guide and they do not constitute a term of any contract.

A prospective buyer is strongly advised to check the particulars and where appropriate at his own expense to employ a qualified Marine Surveyor to carry out a survey and/or to have an engine trial conducted which if conducted by us shall not imply any liability for such engine on our part.

Princess 49

€780,000 INC VAT

Year **2017** 

Lying **Palma, ES** 

Ref **PB2405** 



PRINCESS
BROKERAGE INTERNATIONAL
EST 1964
OUR KNOWLEDGE IS YOUR LUXURY

> **OPEN TO PART EXCHANGE**
WE CAN HELP SPEED UP THE SALE THROUGH OUR OFFER TO UNDERWRITE A PART-EXCHANGE AGAINST THE BROKERAGE YACHT

> **PRINCESS TECHNICAL ORIENTATION INCLUDED**
AT NO ADDITIONAL COST, REGARDLESS OF WHERE THIS YACHT IS LOCATED, WE OFFER A COMPREHENSIVE TECHNICAL INTRODUCTION TO YOUR PURCHASE

> **PROFESSIONAL PHOTOGRAPHY, VIDEO & 3D TOUR AVAILABLE**
VIEW IMAGERY, VIDEO AND A 3D TOUR/WALKTHROUGH OF THIS YACHT ONLINE

PRINCESS
BROKERAGE INTERNATIONAL

brokerage@princess.co.uk
+44 (0)1489 587755
www.princessmotorboatsales.com



Princess 49

€780,000 INC VAT

Year **2017** 

Lying **Palma, ES** 

Ref **PB2405** 



Princess 49

€780,000 INC VAT

Year **2017** 

Lying **Palma, ES** 

Ref **PB2405** 



Princess 49

€780,000 INC VAT

Year **2017** 

Lying **Palma, ES** 

Ref **PB2405** 



Princess 49

€780,000 INC VAT

Year **2017** 

Lying **Palma, ES** 

Ref **PB2405** 



Princess 49

€780,000 INC VAT

Year **2017** 

Lying **Palma, ES** 

Ref **PB2405** 

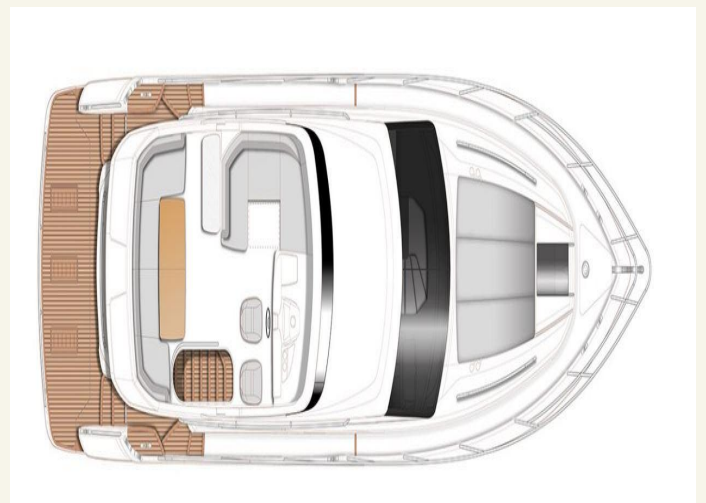
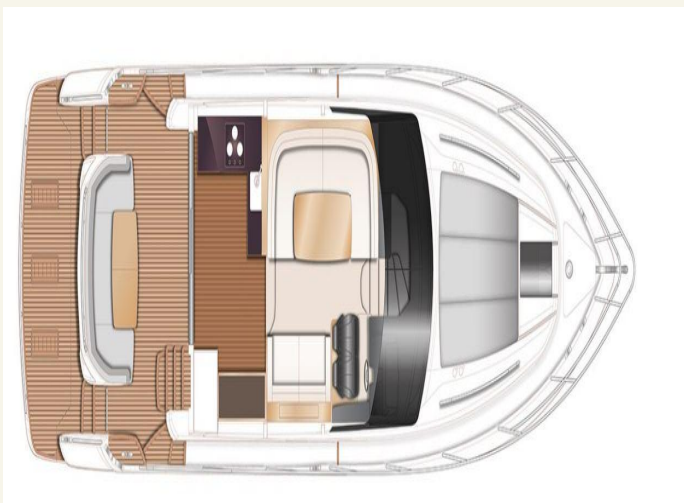
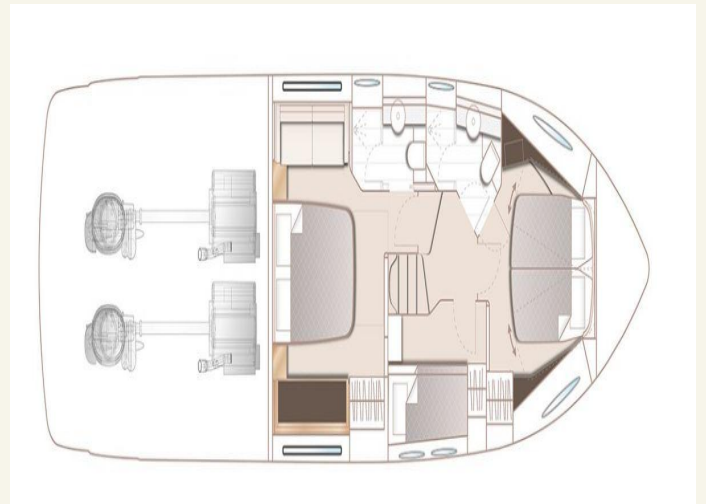

Princess 49

€780,000 INC VAT

Year **2017** 

Lying **Palma, ES** 

Ref **PB2405** 

FINANCE AND INSURANCE
AVAILABLE ON THIS
PRINCESS YACHT

Contact
finance@princess.co.uk
insurance@princess.co.uk
for information.

PRINCESS
OFFICIAL DISTRIBUTOR
UK / SPAIN / GERMANY

PRINCESS MOTOR YACHT SALES

