

# Princess F65

Price on Application

Year **2025** 

Lying **Southampton, GB** 

Ref **PNF65081** 



## NEW 2025 PRINCESS F65 FOR SALE • OPEN TO PART EXCHANGE

PROFESSIONAL PHOTOGRAPHY, VIRTUAL TOUR AND VIDEO COMING SOON

Twin MAN V8-1200 diesel engines (2x 1200 mhp) • White hull • Walnut interior wood, satin finish • 4 Cabins accommodating up to 8 guests plus 2 berth crew cabin • Allure Collection interior styling • Sleipner Vector Fin stabilisation system • GRP flybridge hardtop with electric opening section • Electrically operated sun awning • Teak laid side decks, foredeck and flybridge • Electro-hydraulic telescopic passerelle (4.0m) • Raymarine navigation suite • Premium audio-visual system • Onan 19 kW generator • Interior lighting upgrade package • Reverse cycle air-conditioning • Variable speed (eVision) bow and stern thrusters • Third station controls in cockpit • Electric stern rope handling winches • Full soft furnishing and upholstery package • Icemaker • Foredeck cool box



PRINCESS MOTOR YACHT SALES

T: +44 (0)1489 557755

E: [ukdirect@princess.co.uk](mailto:ukdirect@princess.co.uk)

[www.princess.co.uk](http://www.princess.co.uk)

# Princess F65

Price on Application

Year **2025** 

Lying **Southampton, GB** 

Ref **PNF65081** 

**PLEASE CONTACT US FOR MORE INFORMATION ABOUT THIS 2025 PRINCESS F65 FOR SALE**

## Specification

- **Length** 20.29m / 66ft 7in
- **Beam** 5.09m / 16ft 8in
- **Hull colour** White Gel coat finish with dark grey water line and black antifouling
- **Hull material** Fiberglass
- **Number of engines** 2
- **Fuel type** diesel
- **Total power** 2400.0 hp

## Navigation Equipment

- Raymarine Ray 90 Dual Station VHF (International)
- European Raymarine chart plotter
- Second Raymarine Axiom 2 XL16 display (upper and lower helm)
- Raymarine RMK-10 remote control keypads (upper and lower helm)
- Raymarine Cyclone HD radar with 48" open array scanner
- Raymarine i70s multifunction displays (upper and lower helm)

## Deck Equipment

- GRP Flybridge hardtop featuring electric opening section in soft fabric and including lighting with dimmer
- Electrically operated sun awning to aft end of hardtop
- Electro-hydraulic telescopic passerelle (4.0m) with automatic hand rails
- Teak laid flybridge deck, side decks, seating area and foredeck (6mm with black caulking)
- Teak step nosing upgrade (including transom, flybridge, foredeck and steps to side deck when side deck option is selected)
- Exterior upholstery in Comfort Exterior III Met Ice with Met Macadamia contrast detailing
- Foredeck sunbeds with manually adjustable head rests and back rests (to provide aft facing seating to complement U-shaped seating area)
- Cockpit servery, flybridge console and wetbar finished in Oyster Grey
- Exterior lighting upgrade package (9 total)
- Underwater transom lights (4 Lumishore SMX54 White)
- Underwater lighting to aft hull sides (2 per side Lumishore SMX54 White)
- Upgraded steering wheel at both helm stations
- Foredeck teak coffee table
- Foredeck freshwater anchor/deckwash system

# Princess F65

## Price on Application

Year **2025** 

Lying **Southampton, GB** 

Ref **PNF65081** 

- SEABOB storage racks for (F5/F5S/F5SR), located in transom locker with 2 x IP66 rated sockets included for use standard charger
- Exterior covers (Grey)
- Reticulated foam fitted to all standard exterior cockpit, foredeck and flybridge seating/sunpads in place of standard
- Princess logo in bathing platform teak
- Canopy styling blade in contrast paint - Electric Blue
- Stern docking lights
- Throws and cushions with detailed fabric specs
- Tender chock mounting system for later fitting of tender chocks on bathing platform
- Electric stern rope handling winches (2)
- Stainless steel Epsilon anchor (40kg) with swivel
- Additional 20m of 10mm anchor chain (total 80m)
- Foredeck cool box, positioned between foredeck sun pads

## Interior Fitout

- Walnut interior wood satin finish
- Timber flooring to aft dining area in V-groove planked walnut
- Interior lighting upgrade package including concealed LED strip lighting to starboard and port sofa base surround
- Aft cabin fit out (Two Berths, wardrobes, toilet and shower)
- Electrically powered sliding berth in starboard cabin to convert to a double berth
- Pull-out table to companion seating
- Flip-up arm rests to both the lower and flybridge helm and navigator seats
- Stools for use at either dinette or forward saloon area
- Allure Collection interior styling
- Colour scheme soft furnishings and upholstery

## Interior Equipment

- Slimline dishwasher fitted in galley (9 place setting)
- Icemaker in saloon
- Mosquito screens for all portlights

# Princess F65

Price on Application

Year **2025** 

Lying **Southampton, GB** 

Ref **PNF65081** 



# Princess F65

Price on Application

Year **2025** 

Lying **Southampton, GB** 

Ref **PNF65081** 



# Princess F65

Price on Application

Year **2025** 

Lying **Southampton, GB** 

Ref **PNF65081** 



# Princess F65

Price on Application

Year **2025** 

Lying **Southampton, GB** 

Ref **PNF65081** 

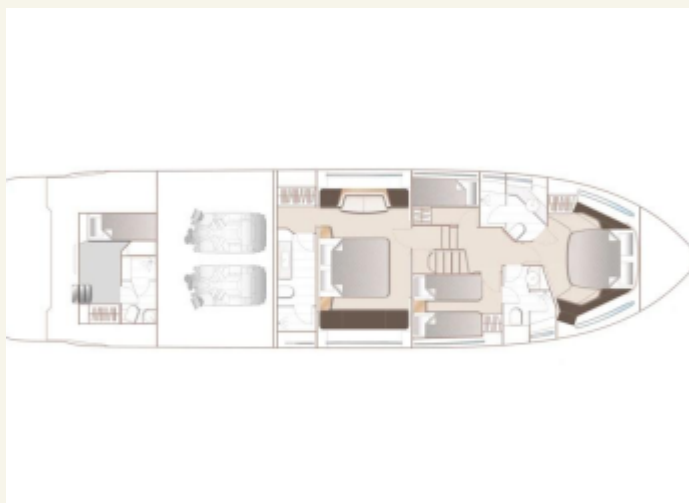

FINANCE AND INSURANCE  
AVAILABLE ON THIS  
PRINCESS YACHT

Contact  
[finance@princess.co.uk](mailto:finance@princess.co.uk)  
[insurance@princess.co.uk](mailto:insurance@princess.co.uk)  
for information.

**PRINCESS**  
OFFICIAL DISTRIBUTOR  
UK / SPAIN / GERMANY

PRINCESS MOTOR YACHT SALES



**PRINCESS**  
OFFICIAL DISTRIBUTOR  
UK / SPAIN / GERMANY

PRINCESS MOTOR YACHT SALES

**T:** +44 (0)1489 557755

**E:** [ukdirect@princess.co.uk](mailto:ukdirect@princess.co.uk)

**[www.princess.co.uk](http://www.princess.co.uk)**