

Princess S65

£2,973,000 EX VAT

Year **2025** 

Lying **Southampton, GB** 

Ref **PNS65538** 



2026 MODEL YEAR PRINCESS S65 FOR SALE • SPECIAL PRICE

OPEN TO PART EXCHANGE • PROFESSIONAL PHOTOGRAPHY, VIRTUAL TOUR AND VIDEO AVAILABLE

2025 built • Twin MAN V12-1400 engines (2 x 1400mhp) • White hull • Walnut interior wood, satin finish • 4 cabins accommodating up to 8 guest plus 1 berth crew cabin • Seakeeper 18 Gyro Stabilisation • Electro-hydraulic telescopic passerelle • Teak decking to foredeck, side decks and Sportbridge • Electrically operated sliding roof • Electrically operated sun awning • Reverse cycle air-conditioning • Onan 19kW generator • Dual Raymarine Axiom XL 16" displays • Raymarine Cyclone radar • Sportbridge sunbed conversion • Wetbar with refrigerator and icemaker • On-board WiFi with 4G/5G antenna • Forward and starboard cabin TV/audio packages • Cockpit audio system • Foredeck cool box and teak coffee table



PRINCESS MOTOR YACHT SALES

T: +44 (0)1489 557755

E: ukdirect@princess.co.uk

www.princess.co.uk

Princess S65

£2,973,000 EX VAT

Year **2025** 

Lying **Southampton, GB** 

Ref **PNS65538** 

**PLEASE CONTACT US FOR MORE INFORMATION ON THIS NEW PRINCESS S65
SPORTBRIDGE
MOTOR YACHT FOR SALE**

Specification

- **Length** 20.60m / 67ft 7in
- **Beam** 5.11m / 16ft 9in
- **Hull material** Fiberglass
- **Number of engines** 2
- **Fuel type** diesel
- **Total power** 2800.0 hp

Navigation Equipment

- Raymarine Ray 90 VHF - International VHF
- Raymarine chart plotters - European version plotter
- Raymarine Cyclone colour radar, 55W pedestal with 48" open array scanner
- Second Raymarine Axiom 2 XL 16 (15.6") colour multifunction display at lower and upper helm
- Raymarine Remote control keypad (RMK-10) for multifunction display fitted at lower and upper helm
- Raymarine i70s 4" multifunction display at lower and upper helm
- Third station controls in cockpit starboard buttress (engine controls, emergency stops and thruster controls)

Deck Equipment

- Electro-hydraulic telescopic passerelle (4.0m) with automatic hand rail
- Electrically operated sliding roof over forward saloon area (incorporating skylight with blinds)
- Electrically operated sun awning to aft end of cockpit (anthracite grey mesh fabric)
- Teak (6mm) to Sportbridge deck
- Teak (6mm) with black caulking to foredeck and side decks
- Foredeck teak coffee table with deck mounted fixing point
- Foredeck sunbeds with manually adjustable head rests and back rests (to provide aft facing seating to complement U-shaped seating area)
- Teak step nosing upgrade (including transom, foredeck and steps to side deck)
- Exterior covers - Grey
- Reticulated foam fitted to all standard exterior cockpit, sportbridge seating/sunpads and foredeck seating.
- Bimini top - Grey canvas
- Bimini includes dimmable LED overhead lighting (switched from console)
- Electro-hydraulically powered bimini top

Princess S65

£2,973,000 EX VAT

Year **2025** 

Lying **Southampton, GB** 

Ref **PNS65538** 

- Upgraded steering wheel to lower and upper helm
- L-shaped aft facing cockpit seating fitted with reticulated foam to starboard side
- Up/down table and infill cushion on sportbridge dinette to create a large sun bed
- Exterior helm seats in Met Ice with quilting detail and Met Storm contrast accents
- Canopy styling blade finished in unique contrast colour of Electric Blue
- Flip-up arm rests to sportsbridge, lower helm and navigator seating
- Cockpit servery unit including top-loading cool box, storage cupboard, bin and sink/tap
- Sportbridge wetbar finished in Platinum gloss
- Refrigerator fitted in sportbridge wetbar (95 ltr)
- Sportbridge console base finished in Oyster Grey Gloss
- Lighting upgrade package (exterior and interior)
- Underwater transom lights (4 Lumishore SMX54 White)
- Underwater lighting to aft hull sides (4 Lumishore SMX54 White, 2 per side)
- Princess logo in bathing platform teak
- Electric stern rope handling winches (2)
- Stainless steel Epsilon anchor in place of standard (40kg)
- Additional 20m of galvanised 10mm anchor chain to give a total of 80m
- Chock mounting system for later fitting of wet bike or similar of maximum 1.25m width / beam
- Icemaker fitted in deck saloon
- Top loading foredeck cool box

Ship Systems

- Gyro Stabilisation - Seakeeper 18 with controls at both helms
- Onan 19kW generator
- Variable speed (eVision) bow and stern thruster with hold-function docking facility and dual station controls
- Princess Connect Telemetry and Maintenance System
- Reverse cycle, split air system, air-conditioning/heating with controls in all cabins and outlets
- Aft cabin air-conditioning condensing unit
- Multi sockets, in place of standard sockets (throughout craft)
- AGM 140Ah batteries in place of standard (for start, domestic and generator batteries)
- Toilet is plumbed into the black water holding tank
- Electric discharge system

Interior Fitout

- Walnut wood satin finish (galley, dinette, and helm timber floor is V-groove planked walnut)
- Starboard cabin includes double berth conversion with powered sliding mechanism on inboard berth
- Saloon armchair integrated into starboard sideboard
- Aft cabin fit out with single berth, locker with shelves and en-suite bathroom accessed from hatch under after sun pad
- Allure Collection Styling
- Silverstone and Pitch Black Eco upholstery helm seats with quilting and Fortress accents with rear insert panel in timber to match boat timber
- Forward L-Shaped seat main upholstery in Met Ice with Met Macadamia contrast upholstery
- Bathroom in white laminate with solid surface vanity top and non-slip (GRP) flooring

Princess S65

£2,973,000 EX VAT

Year **2025** 

Lying **Southampton, GB** 

Ref **PNS65538** 

Interior Equipment

- Stools for use at dinette or forward saloon area (2)
- Mosquito screens for all opening portlights



Princess S65

£2,973,000 EX VAT

Year **2025** 

Lying **Southampton, GB** 

Ref **PNS65538** 



Princess S65

£2,973,000 EX VAT

Year **2025** 

Lying **Southampton, GB** 

Ref **PNS65538** 



Princess S65

£2,973,000 EX VAT

Year **2025** 

Lying **Southampton, GB** 

Ref **PNS65538** 



Princess S65

£2,973,000 EX VAT

Year **2025** 

Lying **Southampton, GB** 

Ref **PNS65538** 

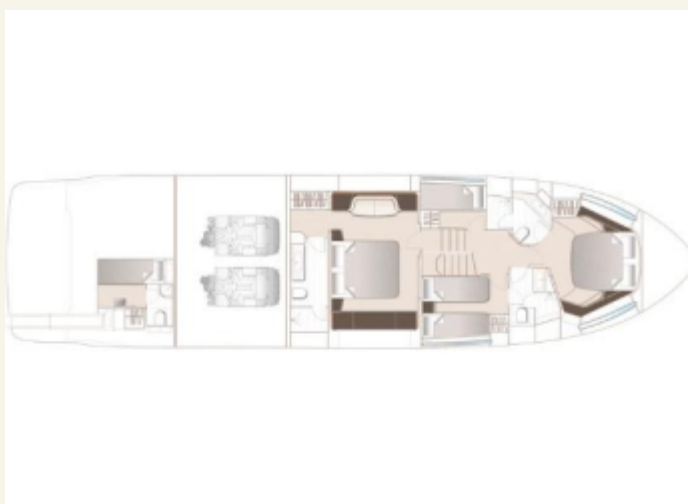

FINANCE AND INSURANCE
AVAILABLE ON THIS
PRINCESS YACHT

Contact
finance@princess.co.uk
insurance@princess.co.uk
for information.

OFFICIAL DISTRIBUTOR
BY APPOINTMENT

PRINCESS MOTOR YACHT SALES



PRINCESS
OFFICIAL DISTRIBUTOR
UK / SPAIN / GERMANY

PRINCESS MOTOR YACHT SALES

T: +44 (0)1489 557755

E: ukdirect@princess.co.uk

www.princess.co.uk