

Princess V52

£449,000 EX VAT

Year **2014** 

Lying **Torquay, GB** 

Ref **PB2406** 



OPEN TO PART EXCHANGE • PRINCESS TECHNICAL ORIENTATION INCLUDED

PROFESSIONAL PHOTOGRAPHY AND VIRTUAL TOUR AVAILABLE

Ex tax • Twin Caterpillar C12A-715 (715hp each) diesel engines • Steel Grey Hull • Lower dinette 2 cabin layout accommodating 4 guests • Walnut Interior wood, satin finish • Variable speed bow and stern thrusters • Crew cabin fitout • Onan 11Kw generator • KVH Tracvision satellite TV • Raymarine navigation equipment • Eberspacher heating • Windscreen demisters • Fusion stereo system • Hi-lo folding dining/coffee table in saloon

PLEASE CONTACT US FOR MORE INFORMATION ON THIS PRINCESS V52 SPORTS CRUISER FOR SALE

Princess V52

£449,000 EX VAT

Year **2014** 

Lying **Torquay, GB** 

Ref **PB2406** 

Specification

- **Length** 16.64m / 54ft 7in
- **Beam** 4.45m / 14ft 7in
- **Hull material** Fiberglass
- **Number of engines** 2
- **Fuel type** diesel
- **Total power** 1430.0 hp

Navigation Equipment

- Raymarine e125 chartplotter/GPS with external GPS and 12.1" brilliant colour multifunction display
- Raymarine SHD digital colour radar 48" 4kW scanner
- Raymarine AIS Class B Transponder interfaced with chartplotter and with 8ft (2.4m) aerial
- Raymarine ST60 wind speed instrument
- European version plotter charts
- International VHF
- UK version VHF

Deck Equipment

- Grey Sunbrella cockpit sun awning with full height cockpit cover
- Cockpit wetbar with sink, top loading coolbox, storage, wastebin and optional barbecue
- Teak laid cockpit, transom platform and side decks
- U-shaped seating/dining area (converts to sunbed)
- Electro-hydraulic raise/lower transom platform with integrated swimming ladder
- Foredeck freshwater anchor/deckwash system
- Reversible electric anchor winch with foredeck and helm position controls
- Self-stowing anchor with 50m chain
- Stemhead roller with automatic anchor launch and retrieve
- Foredeck hatch with integrated skylight
- Twin electric horns
- Folding teak table
- Overhead and low level courtesy lights
- Access hatch to engine room
- Transom door
- Hot and cold shower

Ship Systems

Princess V52

£449,000 EX VAT

Year **2014** 

Lying **Torquay, GB** 

Ref **PB2406** 

- Variable speed bow thruster (150kgf) and stern thruster (120kgf) with hold function docking facility
- 11kW Onan generator
- Engine room lighting
- Power-assisted steering
- Trim tabs with indicators and auto tab function
- Electronic engine controls
- Additional 220V/240V interior power point in galley and saloon
- Weatherproof 220V/240V socket in the engine room and cockpit
- Windscreen Demist system using warm air heater powered from calorifier
- Eberspacher D8L boat heating with additional outlets in both bathrooms and in cockpit
- Eberspacher silencer
- KVH Tracvision satellite TV system with dummy dome

Interior Fitout

- Walnut interior wood, satin finish
- Saloon, galley and helm floors are Wenge
- Helm seats to be in black leather
- Koko galley worktop

UPPER SALOON

- U-shaped sofa with Cream fabric upholstery
- Hi-lo folding dining/coffee table in saloon
- Cocktail cabinet
- Overhead downlighters
- Electric opening roof
- Triple stainless-steel framed sliding doors to cockpit
- Opening window (port)
- Timber-laid flooring with carpet overlay

LOWER DINETTE

- Galley
- Seating around raise/lower dining table
- 2 x stools
- Cream leather upholstery

OWNER'S STATEROOM

- Large double bed with drawers below
- Wardrobe with shelves
- Drawers and storage lockers
- Sofa
- En-suite bathroom with shower cubicle

Princess V52

£449,000 EX VAT

Year **2014** 

Lying **Torquay, GB** 

Ref **PB2406** 

- Safe in master cabin wardrobe

FORWARD GUEST CABIN

- Scissors berths
- Wardrobe
- Storage lockers
- En-suite bathroom with shower cubicle

CREW CABIN FIT OUT

- Single berth with toilet and wash basin

Interior Equipment

- 3 ring ceramic hob
- Single stainless-steel sink with Monobloc mixer tap
- Combination microwave/conventional oven with grill
- Refrigerator with freezer compartment
- Dimmer switch for deck saloon lighting
- Dimmer switch for lower dinnette lighting
- Refrigerator fitted in deck saloon sideboard unit
- 2x stools for deck saloon seating area

Disclaimer

In this case we are acting as Brokers only.

The Vendor is not selling in the course of a business. Whilst every care has been taken in their preparation, the correctness of these particulars is not guaranteed. The particulars are intended only as a guide and they do not constitute a term of any contract.

A prospective buyer is strongly advised to check the particulars and where appropriate at his own expense to employ a qualified Marine Surveyor to carry out a survey and/or to have an engine trial conducted which if conducted by us shall not imply any liability for such engine on our part.

Princess V52

£449,000 EX VAT

Year **2014** 

Lying **Torquay, GB** 

Ref **PB2406** 



PRINCESS
BROKERAGE INTERNATIONAL
EST 1964
OUR KNOWLEDGE IS YOUR LUXURY

- > **OPEN TO PART EXCHANGE**
WE CAN HELP SPEED UP THE SALE THROUGH OUR OFFER TO UNDERWRITE A PART-EXCHANGE AGAINST THE BROKERAGE YACHT
- > **PRINCESS TECHNICAL ORIENTATION INCLUDED**
AT NO ADDITIONAL COST, REGARDLESS OF WHERE THE YACHT IS LOCATED, WE OFFER A COMPREHENSIVE TECHNICAL INTRODUCTION TO YOUR PURCHASE
- > **PROFESSIONAL PHOTOGRAPHY, VIDEO & 3D TOUR AVAILABLE**
VIEW READY, VIDEO AND A 3D TOUR/WALKTHROUGH OF THIS YACHT ONLINE

PRINCESS
BROKERAGE INTERNATIONAL
broking@princess.co.uk
+44 (0)1489 557755
www.princessmotoryacht.com



Princess V52

£449,000 EX VAT

Year **2014** 

Lying **Torquay, GB** 

Ref **PB2406** 



Princess V52

£449,000 EX VAT

Year **2014** 

Lying **Torquay, GB** 

Ref **PB2406** 



Princess V52

£449,000 EX VAT

Year **2014** 

Lying **Torquay, GB** 

Ref **PB2406** 



Princess V52

£449,000 EX VAT

Year **2014** 

Lying **Torquay, GB** 

Ref **PB2406** 



Princess V52

£449,000 EX VAT

Year 2014 

Lying Torquay, GB 

Ref PB2406 

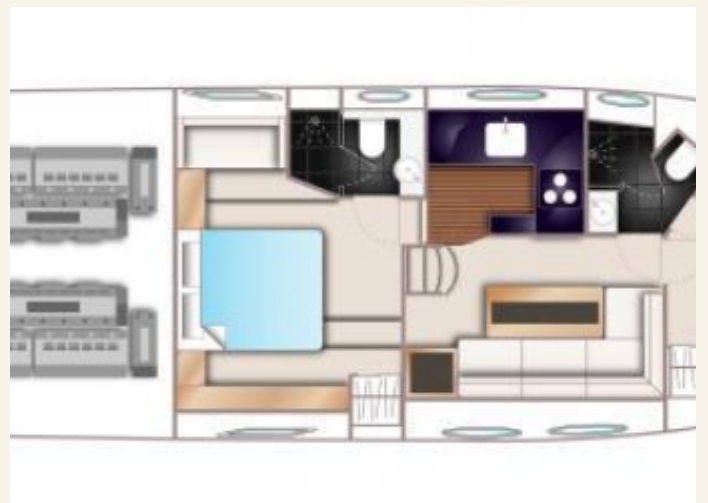

Princess V52

£449,000 EX VAT

Year **2014** 

Lying **Torquay, GB** 

Ref **PB2406** 

FINANCE AND INSURANCE
AVAILABLE ON THIS
PRINCESS YACHT

Contact
finance@princess.co.uk
insurance@princess.co.uk
for information.

OFFICIAL DISTRIBUTOR
OF PRINCESS YACHTS
IN GREAT BRITAIN

PRINCESS MOTOR YACHT SALES



BROKERAGE INTERNATIONAL

T: +44 (0)1489 557755
E: ukbrokerage@princess.co.uk
www.princess.co.uk