

V
CLASS



EXPERIENCE THE
EXCEPTIONAL

Your yacht is an extension of yourself. A statement of your lifestyle. She needs to deliver unforgettable experiences for you, your family and friends. Every Princess yacht is designed with our forward-thinking mentality and crafted with meticulous attention to detail. So whether you're dashing across the water or moored in your favourite bay, you will recognise the difference our design and details make, inside and out.

Experience the exceptional.



CRAFTED IN PLYMOUTH

Perched on the edge of the English Channel lies the city of Plymouth, where we established our home in 1965. Today Princess shipyards cover an area of over 1.1 million square feet, an area rich in British maritime heritage. In fact, South Yard, where our X Class Super Flybridge yachts are constructed, is a former naval yard dating back to the 17th century. From the outset, our goal has been to meticulously sculpt our yachts around our owners' enjoyment of them. Such dedication and attention to detail resonates deeply with our Plymouth craftspeople.

Over 3,000 people, each possessing a mastery of their skill, fastidiously realise this vision in our shipyards. Through a culture of innovation, our yachts are not only some of the most technically-advanced in the world but also the most beautifully realised.



DEEPLY INGENIOUS THE PRINCESS DEEP-V HULL

Our pioneering deep-V hulls are born from our naval architect's obsession with exceptional seakeeping and voluminous space. Their sculpted form is shaped from a lightweight, resin-infused hull composite which can create greater internal volume compared to standard hull production methods. This ingenious design ensures it requires less power and burns less fuel to achieve its maximum design speed. Such precision thinking gives rise to the most exhilarating performance, defined by its efficiency, agility and poise. So whether you're slicing through the seas at 40 knots or navigating stormy waters – a foundation of superior engineering rides with you.

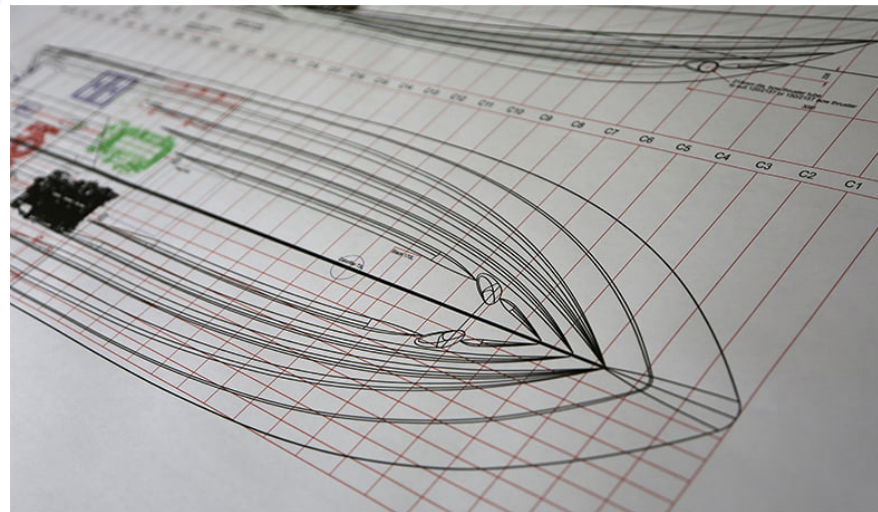



V CLASS

Take the helm and the variable geometry of the deep-V hull assuredly translates any surge of power into taut handling. Enjoy a spirited dash across the ocean in a Princess V Class, a paradox of responsive power and exclusive luxury.

V50



The all-new V50 is installed with premium technology to provide an ease of ownership which makes boating more accessible to new owners. An intuitive IPS system and joystick allows for easy piloting, whilst the addition of the fully integrated Volvo Penta assisted docking system can assist in the management of external factors such as wind, current and manoeuvring in crowded marinas. Additional technology includes premium audio from Naim; plus the new Garmin On-Deck smart boat system, an integrated remote connectivity solution which tracks, monitors and controls selected on-board systems from virtually anywhere via a smartphone app.





When entertaining, the extended cockpit provides exceptional outdoor living space in which to create unforgettable experiences. The elongated canopy provides a shaded area to escape the heat of the sun whilst being in a position to fully appreciate the yacht's balanced performance.

Below deck, a bright, modern open galley sits opposite a sociable entertaining space. Four guests enjoy two beautifully appointed cabins that are filled with natural light from the extensive hull glazing, with a full-beam master stateroom situated amidships. The forward en-suite has additional access to the saloon for use as a day head when required.





V50
SPECIFICATION

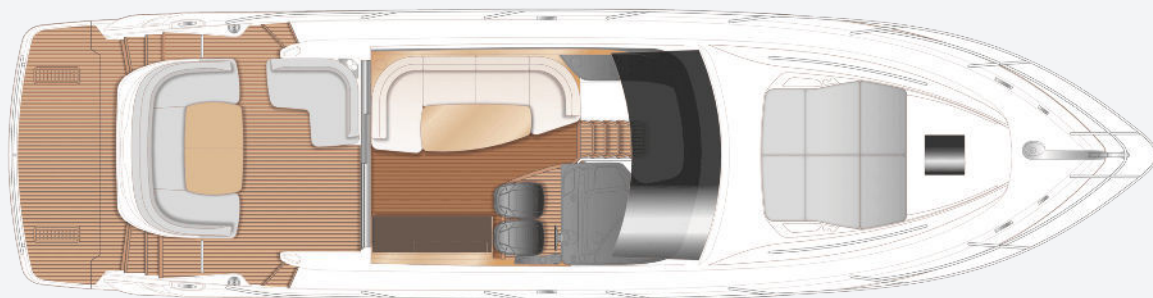

V50 Main Deck

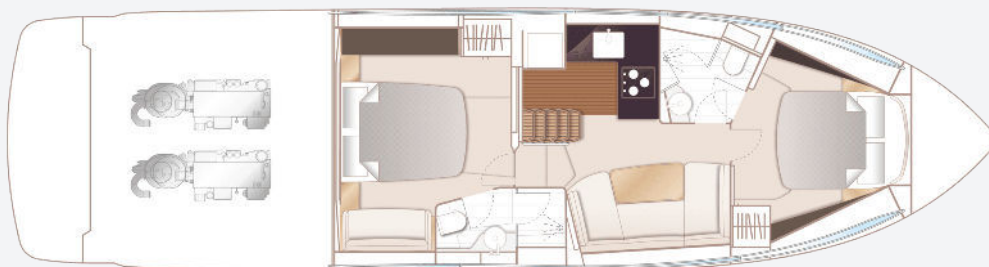

V50 Lower Deck

PRINCIPAL DIMENSIONS

Length overall (incl. pulpit)	52ft 7in (16.02m)
Length overall (excl. pulpit)	50ft 4in (15.35m)
Beam	13ft 4in (4.08m)
Draft	3ft 7in (1.09m)
Displacement approx. (half load)	15,898kg (35,049lbs)*
Fuel capacity	341 gal/410 US gal/1,550l
Water capacity (incl. calorifier)	91 gal/109 US gal/ 414l

ENGINES

Twin Volvo IPS 600 (2 x 440mhp)	Speed range: 29-31 knots†
--	------------------------------

FULL SPECIFICATION

DECK FITTINGS

- 6mm Teak-laid transom platform, transom steps, cockpit deck and steps to side deck
- Lewmar reversible electric anchor winch with foredeck and helm position controls
- Self-stowing anchor system incorporating one 20kg/44lb Lewmar Delta galvanised steel anchor with flush pin shackle fitted and 40m galvanised 9.5mm chain
- Stemhead roller with automatic anchor launch and retrieve
- Stainless steel bow, stern and spring cleats
- Stainless steel bow fairleads
- Stainless steel pulpit and guardrails
- Stainless steel coach roof handrails
- PVC rubbing band with stainless steel insert
- Illuminated crown logo to transom
- Full set of IMCO navigation lights
- Riding light
- Remote control searchlight
- Single electric horn
- Fuel and water fillers
- Holding tank dockside discharge connection

- Deck hatch access to chain locker with fender stowage rack
- Foredeck escape hatch
- Foredeck drinks holders (4)
- Ensign socket

COCKPIT AND BATHING PLATFORM

- Self-draining
- Upholstered aft U-shaped
- Forward L-shaped seating/dining area (optional seat infill)
- Cup holders to L-shaped seating (2)
- Folding teak dining table
- LED overhead and low deck level lighting
- Cockpit cover
- Stainless steel handrails
- Lockable transom hatch to stern lazarette with gas strut assistance
- Lockable access hatch to engine room
- 220/240v shore support inlet in locker
- Life raft stowage locker
- Transom bathing platform with integrated foldaway swimming ladder (with optional

- electro-hydraulic raise/lower mechanism – note when this option is selected it includes transom steps to access stern from bathing platform when in lowered position)
- Port and starboard transom gates leading to bathing platform
- Hot and cold transom shower
- Storage lockers
- Waterproof speakers linked to saloon sound system
- Fender stowage rack in engine room/lazarette
- Seat locker containing remote fuel cocks, manual bilge pump with valve chest and manual controls for automatic fire extinguisher

HELM

- Twin upholstered seats, manually adjustable helm seat (fore/aft), fixed position navigator seat
- Instrument console incorporating engine instruments and fuel gauges

- Instruments and controls at helm position include:
 - Power-assisted electric steering system
 - Adjustable steering wheel
 - High speed magnetic compass
 - Electronic engine controls with integrated trim control
 - Joystick manoeuvring control
 - Electric anchor winch with remote control
 - Volvo/Garmin 16" MFD, incorporating GPS chart plotter, engine instrumentation, alarm warning system, autopilot control, fuel gauges, speed and distance log, echo sounder and steering angle indicator
 - VHF with DSC R/T with intercom
 - Single remote-control searchlight
 - Horn button to operate single electric horn
- Twin windscreen wipers
- Windscreen freshwater pressure wash
- Bilge pump controls with audible and visual alarm for bilge pumps (3)
- Electric drop window to starboard side
- Engine room fire extinguisher warning system
- Drinks holder (2) at console, with additional drink holder (1) at base of navigator seat

- Toughened un-tinted glass screen
- Black mesh sunscreens for exterior use
- USB charging points
- Riding light, helm and nav light control switches
- Timber-laid flooring

DECK SALOON

- U-shaped sofa with drawers
- Dining table
- Sideboard
- Refrigerator
- Curtains, blinds or sunscreens to all windows and doors
- LED overhead downlighters
- Access stairway to lower accommodation
- Electric opening roof
- Triple stainless steel framed sliding doors to cockpit
- Fusion Apollo MS-RA670 audio unit (with external USB connection) with Wi-Fi and Bluetooth connected to saloon Fusion 6" CL602 speakers (2) and cockpit speakers
- Timber flooring
- 220/240v outlets (2)
- USB charging points (2)

LOWER SALOON

- U-shaped sofa with single drawer and top loading storage (top loading storage is occupied by air conditioning unit when option is specified)
- Table
- Storage lockers
- LED overhead downlighters
- 24/240v main electrical control panel with battery isolation switches
- Fusion Apollo MS-RA670 audio unit (with external USB connection) with Fusion 6" CL602 speakers (2)
- Window with opening portlight (1)
- Manual tension venetian blinds
- Thermal heat alarm
- 220/240v outlets (1)
- USB charging points (2)

GALLEY

- Sylmar white solid surface worktop
- 2-zone ceramic hob
- Sylmar white solid surface sink with Monobloc mixer tap (remains white for all options)
- Combination microwave/oven with grill

- Full height fridge freezer (270l), with deep freeze drawers
- Waste bin
- High/low storage cupboards, drawers and lockers
- Timber-laid flooring
- Window with opening portlight
- Manual tension venetian blind
- Hob extractor fan
- Cutlery and crockery storage
- Chopping board
- 220/240v power outlets (4)
- LED overhead task lighting (24v), concealed light and night lighting
- Storage bin under galley sole

ACCOMODATION

- All cabins and bathrooms feature opening portholes
- All cabins feature 220/240v power points
- All bathrooms feature electric freshwater toilets and 240v shaver points

OWNER'S STATEROOM

- Large double bed with bedside tables and drawers below

- Wardrobe with shelves and full-length mirror
- Drawers and storage lockers
- Sideboard
- LED overhead and individual berth lights (24v)
- Starboard side sofa
- Panoramic windows in toughened glass with opening ports
- Manual tension venetian blinds
- Fitted carpet
- 220/240v outlets (2)
- USB charging points (4)

EN-SUITE BATHROOM

- Solid surface worktop
- Wash basin with Monobloc mixer tap
- Separate stall shower with extractor fan and auto pump out
- Mirror
- LED overhead and concealed lighting (24v)
- Storage locker
- Window with opening portlight
- Manual tension venetian blinds
- Solid surface flooring
- Bathroom accessories

- 220/240v shaver socket

FORWARD STATEROOM

- Large double bed with drawers below (option of scissor berths)
- Wardrobe with full length mirror
- Deck hatch
- Storage lockers
- LED overhead (24v)
- Window with opening portlights
- Manual tension venetian blinds
- 220/240v outlets (1)
- USB charging points (2)
- Fitted carpets

EN-SUITE BATHROOM

- Solid surface worktops
- Wash basin with Monobloc mixer tap
- Separate stall shower with extractor fan and automatic pump out
- Mirror
- LED overhead and concealed lighting (24v)
- Storage locker
- Window with opening portlight
- Manual tension venetian blinds
- Solid surface flooring

- Bathroom accessories
- 220/240v shaver socket

POWER AND DRIVE SYSTEMS

- Twin Volvo IPS engines (driving contra rotating propellers via pod drive)
- Power-assisted steering (electrical)
- Electronic engine controls
- Joystick manoeuvring system
- Volvo active corrosion protection system for pod drive
- Engine room extractor fans with electronic time delay
- Volvo interceptor trim system integrated into Volvo engine system (integrated into Volvo/Garmin display)
- Engine room lighting
- Access from cockpit hatch
- Fresh water supply point in engine room
- Engine room insulation
- High volume air intakes
- Engine beds integrally moulded with hull for strength and vibration absorption
- Bulkheads integrally bonded
- Engines flexibly mounted
- Automatic fire extinguisher with remote

override

- Automatic/manual bilge pumps
- 24v to 12v converters for certain navigation and radio circuits

ELECTRICAL SYSTEMS

24 Volt:

- 4 x heavy-duty batteries for engine starting
- 4 x heavy-duty auxiliary batteries
- Engine alternators charge via split charge relays to isolate engine start batteries from auxiliaries and ensure efficient charging of both battery banks
- 40-amp 24v float battery charger
- Battery paralleling system (for engine start back-up)
- Remote battery master switches with control switch at main panel
- Circuit breakers on all circuits
- Galvanic isolation system

220/240 Volt:

- Shore support inlet (32A)
- Power points in owner's stateroom, forward guest cabin, galley, lower and upper saloon
- Polarity check system

- Earth leakage safety trip
- Shaver points in both bathrooms
- 4kW generator
- 12v battery charger

FUEL SYSTEM

- Twin fuel tanks (in NS8 marine grade alloy) with interconnection system
- Fuel fillers on both side decks
- High-capacity duplex fuel filters with water traps with change-over valves, water contamination warning integrated into Volvo/Garmin display (integrated into Volvo/Garmin display)
- Remote fuel cocks in cockpit seat locker for main engines and generator
- Fuel gauges integrated into Volvo/Garmin display

WATER SYSTEM

- Water capacity totalling 80 gal / 96 US gal / 364 l plus 11 gal / 13 US gal / 50 l hot water calorifier
- Water heated by engine and 240v immersion heater
- Automatic water pump with filter

- Pump main circuit breaker at AC/DC switch panel
- Water level gauge
- Deck filler
- Electric quiet flush freshwater toilet system with holding tank, content gauge and low noise manual overboard discharge, as well as dockside discharge

FIRE EXTINGUISHERS

- Automatic fire extinguisher in engine room and generator space
- Hand-operated fire extinguishers (4) in: owner's stateroom, forward guest cabin, galley and upper saloon

BILGE PUMPS

- Automatic electric bilge pumps with manual override (3 in all)
- High-capacity manual bilge pump in cockpit seat locker with valve system and suction points in engine room and accommodation space
- Electric bilge pumps to have controls, warning lights with audible alarm and "pump out" isolation at helm

OTHER STANDARD EQUIPMENT

- Fenders (6)
- Mooring warps (4)
- First aid kit
- Boat hook
- Quilted bedspreads for both cabins
- Tool kit
- Owner's manual and engine manual
- Anchor winch backup handle
- Ensign staff
- Set of towels
- Ships document case

FINISHES

- Furniture finished in a choice of Rovere Oak and Alba Oak in satin finish as standard. Silver Oak or Walnut in satin or gloss finish available as an option
- Galley and bathroom worktops in solid surface
- Timber-laid galley, saloon and helm floors
- Bathroom floors in solid surface
- Manual tension venetian blinds to all windows and portholes, curtains to saloon doors
- Choice of high-quality carpets and

upholstery fabrics from extensive range



V50 OPEN
SPECIFICATION

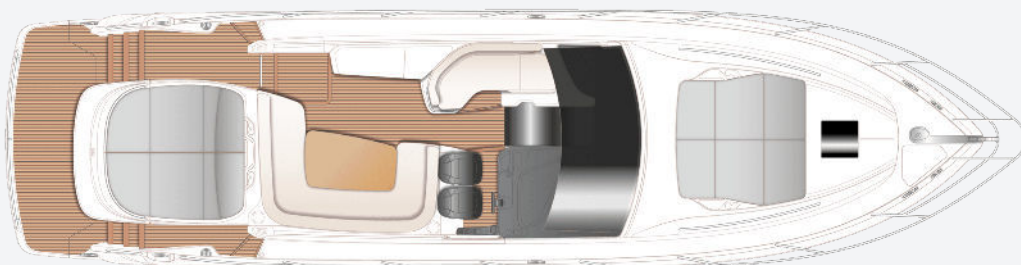

V50 Open Main Deck

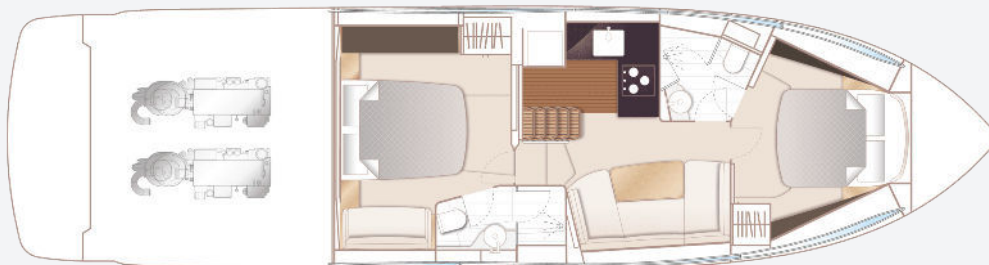

V50 Open Lower Deck

PRINCIPAL DIMENSIONS

Length overall (incl. pulpit)	52ft 7in (16.02m)
Length overall (excl. pulpit)	50ft 4in (15.35m)
Beam	13ft 4in (4.08m)
Draft	3ft 7in (1.08m)
Displacement approx. (half load)	15,919kg (35,095lbs)*
Fuel capacity	341 gal/410 US gal/1,550l
Water capacity (incl. calorifier)	91 gal/109 US gal/ 414l

ENGINES

Twin Volvo IPS 650 (2 x 480mhp)	Speed range: 30-32 knots†
--	------------------------------

FULL SPECIFICATION

DECK FITTINGS

- 6mm teak-laid transom platform, cockpit deck and steps to side deck
- Lewmar reversible electric anchor winch with foredeck and helm position controls
- Self-stowing anchor system incorporating one 20kg/44lb Lewmar Delta galvanised steel anchor with flush pin shackle fitted and 40m galvanised 9.5mm chain
- Stemhead roller with automatic anchor launch and retrieve
- Stainless steel bow, stern and spring cleats
- Stainless steel bow fairleads
- Stainless steel pulpit and guardrails
- Stainless steel coach roof handrails
- PVC rubbing band with stainless steel insert
- Illuminated crown logo to transom
- Full set of IMCO navigation lights
- Riding light
- Remote control searchlight
- Single electric horn
- Fuel and water fillers
- Holding tank dockside discharge connection

- Deck hatch access to chain locker with fender stowage rack
- Foredeck escape hatch
- Foredeck drinks holders (4)
- Ensign socket

COCKPIT AND BATHING PLATFORM

- Self-draining
- Upholstered U-shaped seating/dining area
- Folding teak dining table
- LED Overhead and deck level lighting
- Cockpit cover
- Stainless steel handrails
- Wet bar with sink, storage, refrigerated coolbox
- Lockable access hatch to engine room
- 220/240v shore support inlet in locker
- Life raft stowage locker
- Transom platform with integrated swimming ladder (with electro-hydraulic raise/lower mechanism)
- Transom steps to access stern from bathing platform when in lowered position

- Aft sunbed with drinks holders (4)
- Tender garage with electro-hydraulic door and electric winch for tender up to 3.25m
- Transom door leading to bathing platform
- Hot and cold transom shower
- Storage lockers
- Waterproof speakers linked to saloon Fusion Apollo MS-RA670 sound system
- Fender stowage rack in engine room/lazarette
- Cockpit locker containing remote fuel cocks, manual bilge pump with valve chest and manual controls for automatic fire extinguisher

HELM POSITION

- Twin upholstered seats, manually adjustable helm seat (fore/aft) with sit/stand facility, fixed position navigator seat
- J-shaped companionway seating with drinks holders (2)
- Instrument console incorporating engine instruments and fuel gauges

- Instruments and controls at helm position include:
 - Power-assisted steering
 - Adjustable steering wheel
 - High speed magnetic compass
 - Electronic engine controls with integrated trim control
 - Joystick manoeuvring control
 - Electric anchor winch with remote control
 - Volvo/Garmin 16" MFD, incorporating GPS chart plotter, engine instrumentation, alarm warning system, autopilot control, fuel gauges, speed and distance log, echo sounder and steering angle indicator
 - VHF with DSC R/T with intercom
 - Single remote-control searchlight
 - Horn button to operate single electric horn
- Twin windscreen wipers
- Windscreen freshwater pressure wash
- Bilge pump controls with audible and visual alarm for bilge pumps (3)
- Electric drop window to starboard side
- Engine room fire extinguisher warning system
- Drinks holder (2) at console, with additional drink holder (1) at base of navigator seat

- Toughened un-tinted glass screen
- Black mesh sunscreens for exterior use
- USB charging points
- Riding light, helm and nav light control switches
- 6mm teak-laid flooring

LOWER SALOON

- U-shaped sofa with single drawer and top loading storage (top loading storage is occupied by A/C unit when option is specified)
- Table
- Storage lockers
- LED overhead downlighters
- 24/240v main electrical control panel with battery isolation switches
- Skylight
- Fusion Apollo MS-RA670 audio unit (with external USB connection) with Fusion 6" CL602 speakers (2)
- Window with opening portlight (1)
- Manual tension venetian blinds
- Thermal heat alarm
- 220/240v outlets (1)
- USB charging points (2)

GALLEY

- Sylmar White solid surface worktop
- 2-zone ceramic hob
- Sylmar White solid surface sink with Monobloc mixer tap
- Combination microwave/convection oven with grill
- Full height fridge/freezer (270l)
- Waste bin
- High/low storage cupboards, drawers and lockers
- Timber-laid flooring
- Under floor storage bin
- Window with opening portlight
- Manual tension venetian blind
- Hob extractor fan
- Cutlery and crockery storage
- Chopping board
- 220/240v power outlets (4)
- LED overhead task lighting (24v), concealed light and night lighting
- Storage bin under galley sole

ACCOMMODATION

- All cabins and bathrooms feature opening portholes

- All cabins feature 220/240v power points
- All bathrooms feature electric freshwater toilets and 240v shaver points

OWNER'S STATEROOM

- Large double bed with bedside tables drawers below
- Wardrobe with shelves and full-length mirror
- Drawers and storage lockers
- Sideboard
- LED overhead and individual berth lights (24v)
- Starboard side sofa
- Panoramic windows in toughened glass with opening ports
- Manual tension venetian blinds
- Fitted carpet
- 220/240v outlets (2)
- USB charging points (4)

EN-SUITE BATHROOM

- Solid surface worktop
- Wash basin with Monobloc mixer tap
- Separate stall shower with extractor fan and auto pump out

- Mirror
- LED overhead and concealed lighting (24v)
- Storage locker
- Windows with opening portlight
- Manual tension venetian blind
- Solid surface flooring
- Bathroom accessories
- 220/240v shaver socket

FORWARD STATEROOM

- Large double bed with drawers below (option of scissor berths)
- Wardrobe with full length mirror
- Deck hatch
- Storage lockers
- LED overhead (24v)
- Window with opening portlights
- Manual tension venetian blinds
- 220/240v outlets (1)
- USB charging points (2)
- Fitted carpets

EN-SUITE BATHROOM

- Solid surface worktop
- Wash basin with Monobloc mixer tap
- Separate stall shower with extractor fan and

automatic pump out

- Mirror
- LED overhead and concealed lighting (24v)
- Storage locker
- Window with opening portlight
- Manual tension venetian blinds
- Solid surface flooring
- Bathroom accessories
- 220/240v shaver socket

POWER AND DRIVE SYSTEMS

- Twin Volvo IPS engines (driving contra rotating propellers via pod drive)
- Power-assisted steering (electrical)
- Electronic engine controls
- Joystick manoeuvring system
- Volvo active corrosion protection system for pod drive
- Engine room extractor fans with electronic time delay
- Volvo interceptor trim system integrated into Volvo engine system (integrated into Volvo/Garmin display)
- Engine room lighting
- Access from cockpit hatch
- Fresh water supply point in engine room

- High volume air intakes
- Engine beds integrally moulded with hull for strength and vibration absorption
- Bulkheads integrally bonded
- Engines flexibly mounted
- Automatic fire extinguisher with remote override
- Automatic/manual bilge pumps

ELECTRICAL SYSTEMS

24 Volt:

- 4 x heavy-duty batteries for engine starting
- 4 x heavy-duty auxiliary batteries
- Engine alternators charge via split charge relays to isolate engine start batteries from auxiliaries and ensure efficient charging of both battery banks.
- 40-amp 24v float battery charger
- Battery paralleling system (for engine start back-up)
- Remote battery master switches with control switch at main panel
- Circuit breakers on all circuits
- Galvanic isolation system
- 12v voltage dropper for certain navigation and radio circuits

220/240 Volt:

- 7kW diesel generator with own starting battery, remote controls and specially silenced exhaust
- Automatic fire extinguisher situated by generator
- Shore support inlet (32A)
- Power points in owner's stateroom, forward guest cabin, galley and lower saloon
- Generator/ shore support change-over switch
- Polarity check system
- Earth leakage safety trip
- Shaver points in both bathrooms
- 4kW generator
- 12v battery charger

FUEL SYSTEM

- Twin fuel tanks (in NS8 marine grade alloy) with interconnection system
- Fuel fillers on both side decks
- High-capacity duplex fuel filters with water traps with change-over valves, water contamination warning integrated into Volvo/Garmin display (integrated into Volvo/Garmin display)

- Remote fuel cocks in cockpit locker for main engines and generator
- Fuel gauges integrated into Volvo/Garmin display

WATER SYSTEM

- Water capacity totalling 80 gal / 96 US gal / 364 l plus 11 gal / 13 US gal / 50 l hot water calorifier
- Water heated by engine and 240v immersion heater
- Automatic water pump with filter
- Pump main circuit breaker at AC/DC switch panel
- Water level gauge
- Deck filler
- Electric quiet flush freshwater toilet system with holding tank, content gauge and low noise manual overboard discharge, as well as dockside discharge

FIRE EXTINGUISHERS

- Automatic fire extinguisher in engine room and generator space
- Hand-operated fire extinguishers (4) in: owner's stateroom, forward guest cabin,

galley and upper saloon

BILGE PUMPS

- Automatic electric bilge pumps with manual override (3 in all)
- High-capacity manual bilge pump in cockpit locker with valve system and suction points in engine room and accommodation space
- Electric bilge pumps to have controls, warning lights with audible alarm and “pump out” isolation at helm

OTHER STANDARD EQUIPMENT

- Fenders (6)
- Mooring warps (4)
- Ensign staff
- First aid kit
- Boathook
- Functional fitted bedsheets as standard for both cabins
- Tool kit
- Owner’s manual and engine manual
- Anchor winch backup handle
- Set of towels
- Ships document case

FINISHES

- Furniture finished in a choice of Rovere Oak and Alba Oak in satin finish as standard. Silver Oak or Walnut in satin or gloss finish available as an option
- Galley and bathroom worktops in solid surface
- Timber-laid floors to galley, saloon and helm
- Bathroom floors in solid surface
- Venetian blinds to all windows and portholes
- Choice of high-quality carpets and upholstery from extensive range