

V
CLASS





EXPERIENCE THE
EXCEPTIONAL

Your yacht is an extension of yourself. A statement of your lifestyle. She needs to deliver unforgettable experiences for you, your family and friends. Every Princess yacht is designed with our forward-thinking mentality and crafted with meticulous attention to detail. So whether you're dashing across the water or moored in your favourite bay, you will recognise the difference our design and details make, inside and out.

Experience the exceptional.



CRAFTED IN PLYMOUTH

Perched on the edge of the English Channel lies the city of Plymouth, where we established our home in 1965. Today Princess shipyards cover an area of over 1.1 million square feet, an area rich in British maritime heritage. In fact, South Yard, where our X Class Super Flybridge yachts are constructed, is a former naval yard dating back to the 17th century. From the outset, our goal has been to meticulously sculpt our yachts around our owners' enjoyment of them. Such dedication and attention to detail resonates deeply with our Plymouth craftspeople.

Over 3,000 people, each possessing a mastery of their skill, fastidiously realise this vision in our shipyards. Through a culture of innovation, our yachts are not only some of the most technically-advanced in the world but also the most beautifully realised.



DEEPLY INGENIOUS THE PRINCESS DEEP-V HULL

Our pioneering deep-V hulls are born from our naval architect's obsession with exceptional seakeeping and voluminous space. Their sculpted form is shaped from a lightweight, resin-infused hull composite which can create greater internal volume compared to standard hull production methods. This ingenious design ensures it requires less power and burns less fuel to achieve its maximum design speed. Such precision thinking gives rise to the most exhilarating performance, defined by its efficiency, agility and poise. So whether you're slicing through the seas at 40 knots or navigating stormy waters – a foundation of superior engineering rides with you.

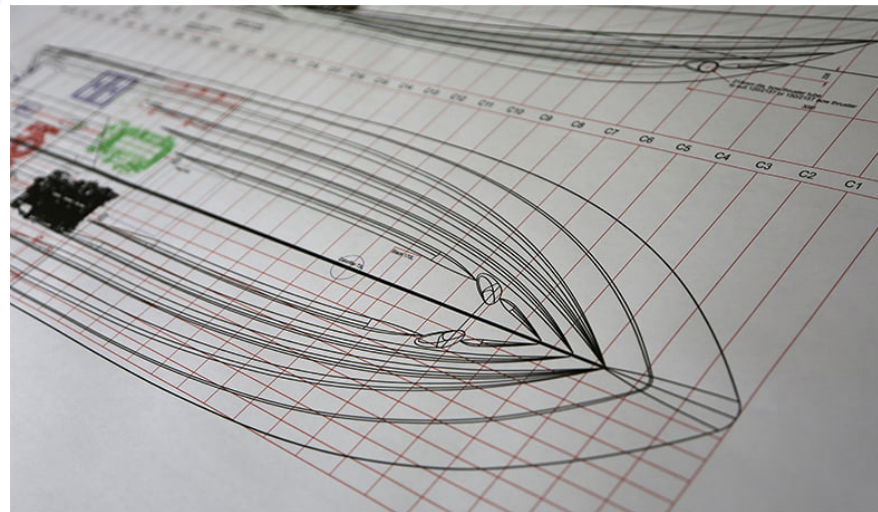



V CLASS

Take the helm and the variable geometry of the deep-V hull assuredly translates any surge of power into taut handling. Enjoy a spirited dash across the ocean in a Princess V Class, a paradox of responsive power and exclusive luxury.

V 55



The striking all-new V55 features a sleek and dynamic exterior profile coupled with an intelligent use of space and all the exceptional performance qualities synonymous with our V Class range. Her main deck has been purposely designed for those who enjoy true open-boating. The expansive cockpit features a large L-shaped seating area with additional seating aft around a substantial folding teak table served by a wetbar opposite with electric barbecue. This area connects to the saloon via a drop down sliding door and opening window aft of the galley, seamlessly integrating the two living areas as required. Her main deck also boasts a large sunpad located aft of the cockpit and a further foredeck seating and sunbathing area. With a top speed of 37 knots, she promises to deliver a powerful V Class sports yacht experience.





This new V Class continues to deliver throughout her lower deck with optimum use of space and multiple accommodation options. Featuring three generous guests cabins, she is class leading for a yacht of her size. Her ensuite master stateroom utilises the full beam of the yacht. Additional guests can enjoy the ensuite forward cabin which benefits from the option of scissor berths in addition to a third bunk cabin. There is also the option of a single aft cabin for crew or occasional guests.







V55
SPECIFICATION

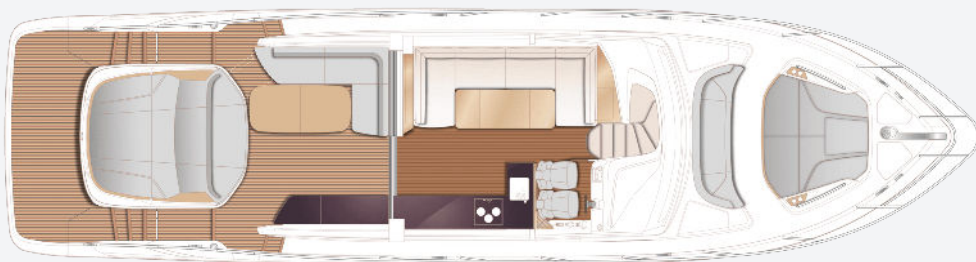

V55 Main Deck

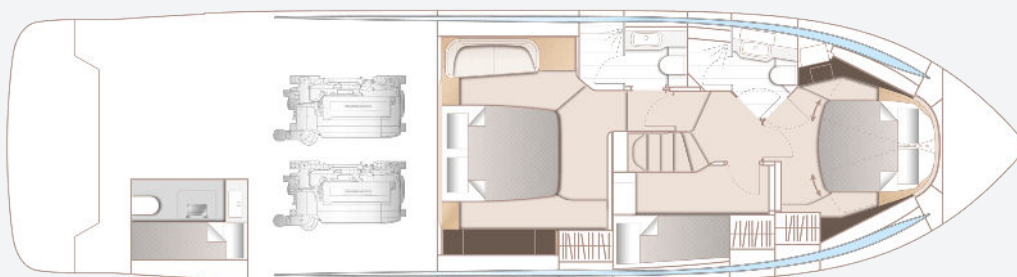

V55 Lower Deck

PRINCIPAL DIMENSIONS

Length overall (incl. pulpit)	58ft 5in (17.81m)
Length overall (excl. pulpit)	56ft 9in (17.29m)
Beam	15ft 3in (4.66m)
Draft	4ft 7in (1.4m)
Displacement approx. (half load)	31,194kg (68,770lbs)*
Fuel capacity	550 gal/660 US gal/2,500l
Water capacity (excl. calorifier)	105 gal/126 US gal/477l

ENGINES

Twin Volvo D13 (2 x 1,000mhp)	Speed range: 35-37 knots†
--	------------------------------

DECK FITTINGS

- Teak-laid transom platform, cockpit deck and steps to side deck
- Reversible electric anchor winch with foredeck and helm position controls
- Stemhead roller with automatic anchor launch and retrieve
- Self-stowing (32kg/70lb) Delta anchor with 40m of chain (9.5mm)
- Bow rope storage locker
- Freshwater deck/anchor wash
- Walk through coachroof seating area
- Deck storage locker for fenders
- Princess stainless steel bow, stern and spring cleats (8)
- Stainless steel pulpit and guardrails
- Stainless steel coachroof handrails
- Foredeck hatch
- PVC rubbing band with stainless steel insert
- LED deck level lighting
- Illuminated crown logo to transom
- Full set of IMCO navigation lights
- Riding light
- Searchlight with remote control
- Twin electric horns
- Fuel and water fillers

- V55 badges, 1 per side, aft canopy

COCKPIT AND BATHING PLATFORM

- Patio door with lift up section to starboard with locking gas strut. Moving panel slides to port and retracts forming large open section.
- Self-draining
- L-shaped seating/dining area, folding teak table with cushion infill to extend seating into U-shaped configuration
- Aft sunbed
- Wetbar with barbecue, drawer fridge and storage
- LED overhead and deck level lighting
- Hand holds moulded into GRP inboard faces of the aft buttresses.
- Garage(to take tender up to 3.45m) with electro-hydraulic door and tender launch system with electric winch
- Lifteraft stowage locker
- Lockable gas strut assisted hatch to port lazarette
- Lockable gas strut assisted hatch to lazarette/ optional crew cabin
- Lockable gas strut assisted hatch to engine room

- Locker containing remote fuel cocks, manual bilge pump with valve chest and manual controls for automatic fire extinguishers
- Twin transom gates leading to bathing platform
- Electro-hydraulic raise/lower teak laid bathing platform (450Kg SWL)
- Retractable bathing ladder (manual) in side of hydraulic platform
- Transom steps to access stern from bathing platform when in lowered position
- Hot and cold transom shower
- Fusion Signature 6.5" speakers waterproof speakers (2) linked to saloon sound system
- with local control (Fusion Apollo ERX-400) (additional x 2 speakers - optional)
- 220/240v shore support inlet in locker
- Tonneau cover

HELM POSITION

- Twin helm seats with fore and aft adjustment for helmsman
- Instrument console with 10" colour mfd screen incorporating engine instrumentation and fuel gauges and rudder indicator
- 16" brilliant colour mfd incorporating GPS/ chartplotter, log and echo sounder

- Instruments and controls at Helm Position:
 - power-assisted electro-hydraulic steering
 - adjustable steering wheel (new style Isotta steering wheel)
 - rudder position indicator
 - high-speed magnetic compass
 - electronic engine controls and joystick control
 - trim tab controls with indicators
 - bow thruster control
 - electric anchor winch remote control
 - autopilot
 - VHF with DSC R/T with intercom
 - remote control searchlight
 - horn button
- Drinks holders
- Toughened glass screen (clear for night vision)
- Windscreen wipers with freshwater windscreen wash
- Black mesh sunscreens
- Bilge pump controls with visual pump running warnings
- 24v and 240v electrical control panel
- Riding light, helm and navigation light control switches
- USB connection point
- LED overhead lighting (24v) and night lighting

- Electric drop window to starboard side
- Timber flooring (V groove planked)

SALOON

- U-shaped sofa with crockery storage below
- Folding dining table or coffee table with integrated storage
- 50" UHD LED TV on rise and fall with Sony BDP-S3700 Blu-Ray player
- Fusion Apollo MS-RA770 audio system paired with Focal 100 ICW6 speakers (2)
- Blinds or sunscreens to all windows and doors
- Dimmable LED overhead and concealed lighting (24v)
- Access stairway to lower accommodation
- Electric opening roof with integrated blinds
- Timber flooring (V groove planked)

GALLEY

- Sylmar white (satin finish) solid surface worktop
- Ceramic 4-zone hob (De Dietrich hob, white)
- Hob extractor
- Under-counter fridge freezer
- Combination microwave/convection oven with grill
- Stainless steel sink with mixer tap

- Waste bin
- Drawers and storage cupboards in taupe grey soft touch finish
- Stainless steel framed drop down patio door to cockpit with hinge up window over wetbar
- Blinds to all windows and doors
- Dimmable LED overhead and task lighting (24v)
- 220/240v outlets (4)
- Timber flooring (V groove planked)

ACCOMMODATION

- All cabins and bathrooms feature opening portholes
- All cabins feature 220/240v power points
- All bathrooms feature electric freshwater toilets and 240v shaver points

OWNER'S STATEROOM

- Large double bed
- Twin bedside tables
- Wardrobe with hanging and shelf storage
- Mirror
- 2-seater sofa to port
- Storage lockers and drawers
- Sideboard unit to starboard with storage lockers and drawers and integrated dressing

table

- 43" UHD LED TV
- Audio system with Apollo RA-670 with DAB and external USB, Sony BDP-S3700 Blu-ray player. Paired with Focal 100 ICW6 speakers (2)
- Panoramic windows including opening porthole with venetian blinds
- Dimmable LED overhead and concealed lighting (24v)
- Individual berth lights
- 220/240v outlets (2)
- Double USB charging points (2)
- Fitted carpet

EN-SUITE BATHROOM

- Wash basin and worktop in thermoformed solid surface in Sylmar White (satin finish)
- Mirror
- Storage lockers
- Shower compartment with automatic pump out
- Extractor fan
- Windows with opening portholes and venetian blind
- LED overhead and concealed lighting (24v)
- Bathroom accessories
- Flooring in Koko White (satin finish) solid

surface

FORWARD STATEROOM

- Large double bed with option of scissor berths
- Wardrobe with shelves
- Dressing table
- Mirror
- Storage lockers
- Window with opening porthole and venetian blind
- Deck hatch
- LED overhead and concealed lighting (24v)
- Individual berth lights
- 220/240v outlets (2)
- Double USB charging points (2)
- Fitted carpet

EN-SUITE BATHROOM

- Wash basin and worktop in thermoformed solid surface in Sylmar White (satin finish)
- Mirror
- Storage lockers
- Shower compartment with automatic pump out
- Extractor fan
- Window with opening porthole and venetian blind

- LED overhead and concealed lighting (24v)
- Bathroom accessories
- Flooring in Koko White (satin finish) solid surface

STARBOARD GUEST CABIN

- Two single bunk beds with drawers below
- Wardrobe with shelves
- Mirror
- Storage lockers with shelves
- Window with opening portholes and venetian blind
- LED overhead and concealed lighting (24v)
- Individual berth lights
- 220/240v outlets (1)
- Double USB charging points (2)
- Fitted carpet

OPTIONAL CREW CABIN (IN PLACE OF AFT LAZARETTE)

- Single bed with storage below
- Storage locker
- Opening porthole
- LED overhead lighting (24v)
- Individual berth light
- 220/240v outlet (1)

- Non-slip safety flooring
- Mirror
- Washbasin with solid surface worktop
- Electric freshwater toilet
- Bathroom accessories

POWER AND DRIVE SYSTEMS

- 5-bladed propellers in nickel aluminium bronze
- Bow thruster (210kgf/463lbf) with controls
- Engine room lighting
- Engine room access hatch and ladder
- Volvo electric power assisted steering “joystick ready” as standard
- Trim tabs with indicators
- Electronic engine and gear shift controls
- Engine room extractor fan with electronic time delay
- Fresh water supply point in engine room
- Dripless self-aligning shaft seals

ELECTRICAL SYSTEMS

24 Volt:

- 4 x heavy duty batteries for engine starting
- 4 x heavy duty auxiliary batteries
- Battery link facility with remote control at helm

position

- Both battery banks are charged using a voltage sensitive relay that parallels both battery banks when a charging source is present
- 60 amp battery charger charges both banks of batteries via an automatic switch charging system
- Remote battery master switches with control switch at main switch panel
- Circuit breakers on all circuits
- 12v voltage dropper for certain navigation and radio circuits

220/240 Volt:

- 9.5Kw diesel generator in own sound shield with water cooled specially silenced exhaust
- Automatic fire extinguisher
- 50 amp shore support inlet
- Generator/shore support change-over switch
- Polarity check system
- Earth leakage safety trip
- Circuit breakers on all circuits
- Power points in: Owner’s stateroom, guest cabins, galley and saloon area
- Shaver points in all bathrooms

FUEL SYSTEM

- Twin fuel tanks (in NS8 marine grade alloy) with interconnection system giving 484 gal / 581 US gal / 2,200l
- Fuel fillers on port and starboard side decks
- High-capacity duplex fuel filters with water traps with change-over valves, water warning sensors connected to warning lights at helm
- Remote fuel cocks in cockpit locker
- Fuel gauges at helm console

WATER SYSTEM

- Water tanks totalling 105 gal / 126 US gal / 477l plus 16 gallons/19 US gal / 73l / hot water calorifier
- Water heated by engines and 240v immersion heater
- Automatic water pump with filter
- Main circuit breaker at switch panel
- Water level gauge
- Deck filler
- Electric freshwater toilet system with 66 gal / 79 US gal / 300l holding tank, content gauge and low noise manual overboard discharge with dockside discharge system

FIRE EXTINGUISHERS

- Automatic/manual override fire extinguisher in engine room with warning system at helm position
- Hand-operated fire extinguishers (5) in owner's stateroom, forward and starboard guest cabins, galley and helm position
- Additional extinguisher fitted when optional aft cabin is specified

BILGE PUMPS

- Automatic/manual override electric bilge pumps in engine room (2), rudder area, lazarette and forward accommodation (6 in all)
- High-capacity manual bilge pump with valve system and suction points in same areas
- Electric bilge pumps have controls and warning lights at helm and warning light with audible alarm at helm

OTHER STANDARD EQUIPMENT

- Ensign staff
- Fenders (6)
- Mooring warps (4)
- Boat hook

- First Aid kit
- Tool kit
- Owner's manual and engine manual
- Quilted bedspreads supplied to all cabins (except optional crew cabin)
- Anchor winch back up handle
- Storage locker in lower lobby

FINISHES

- Teak-laid decks to transom platform, cockpit deck and steps to side decks
- Timber flooring (V groove planked) to galley, saloon and helm
- Furniture in choice of Rovere Oak or Alba Oak wood with satin finish. Silver Oak and Walnut wood with satin or gloss lacquer finishes available as an option.
- Upper accommodation furniture with finish and materials to complement the exterior living spaces
- Solid surface floors, counter tops and sinks in all bathrooms
- Galley worktop in solid surface
- Choice of high-quality carpet and upholstery fabric from extensive range

- Blinds or sunscreens to all windows and portholes
- Optional crew cabin has non slip safety flooring, crew bathroom has white solid surface countertops