

Y CLASS





EXPERIENCE THE
EXCEPTIONAL

Your yacht is an extension of yourself. A statement of your lifestyle. She needs to deliver unforgettable experiences for you, your family and friends. Every Princess yacht is designed with our forward-thinking mentality and crafted with meticulous attention to detail. So whether you're dashing across the water or moored in your favourite bay, you will recognise the difference our design and details make, inside and out.

Experience the exceptional.



CRAFTED IN PLYMOUTH

Perched on the edge of the English Channel lies the city of Plymouth, where we established our home in 1965. Today Princess shipyards cover an area of over 1.1 million square feet, an area rich in British maritime heritage. In fact, South Yard, where our X Class Super Flybridge yachts are constructed, is a former naval yard dating back to the 17th century. From the outset, our goal has been to meticulously sculpt our yachts around our owners' enjoyment of them. Such dedication and attention to detail resonates deeply with our Plymouth craftspeople.

Over 3,000 people, each possessing a mastery of their skill, fastidiously realise this vision in our shipyards. Through a culture of innovation, our yachts are not only some of the most technically-advanced in the world but also the most beautifully realised.



THE EXPERIENCE OF PERSONALISATION

Every yacht in the Y Class range is unique. We start with an inspiring platform, combining luxury and performance, with a focus on meticulous detailing. It's then down to you to create your ultimate yacht with a variety of layout options and a fine selection of designed interiors with expert guidance from the Princess Design Studio. It is this journey that makes the Y class so enticing. A refined yacht that is ingenious by design, exciting to experience and personalised by you.



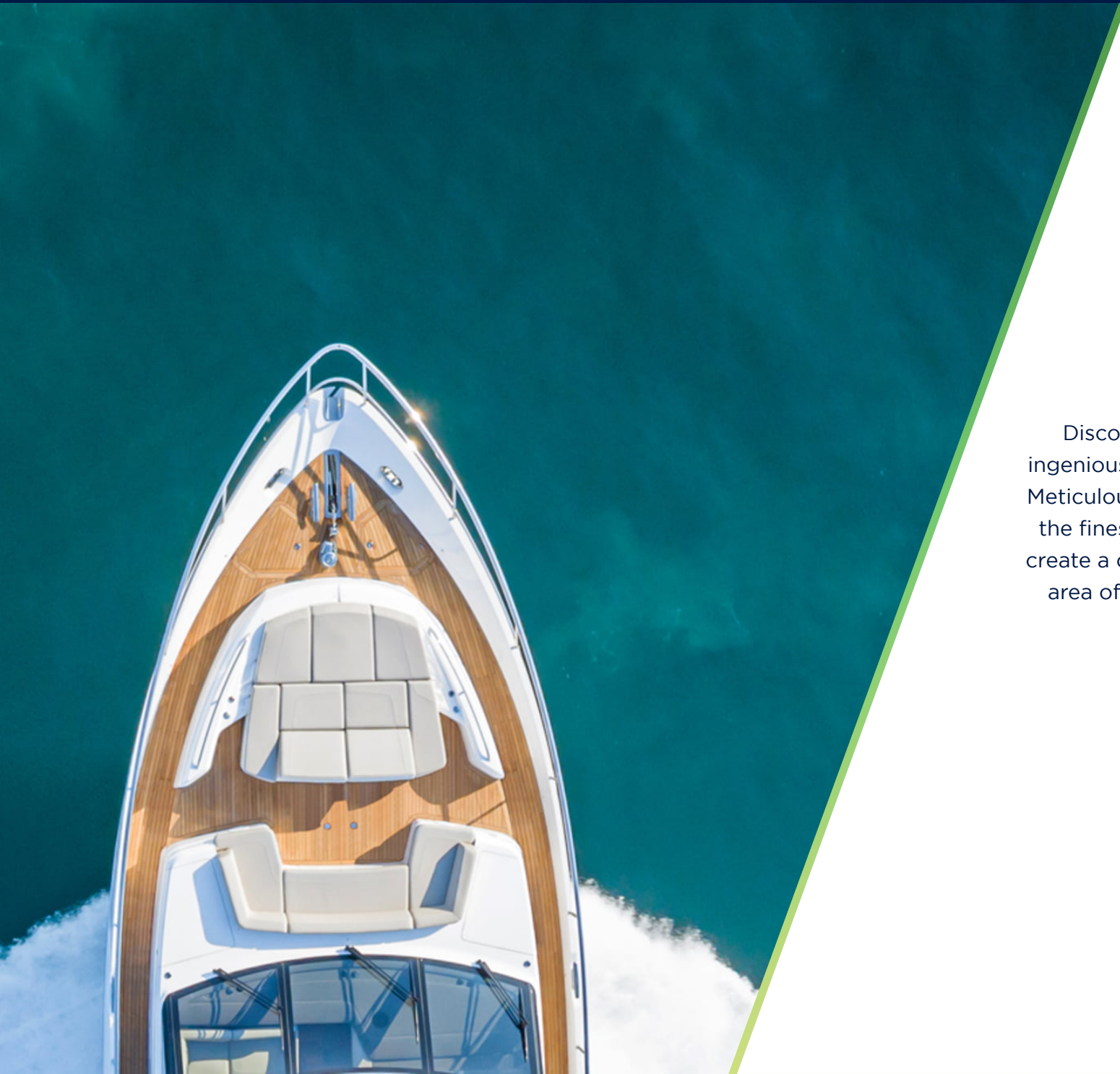

Y CLASS

Discover a world of motor yachting that's ingeniously crafted to capture your imagination. Meticulously detailed surroundings finished with the finest materials, bathed in space and light, create a compelling conversation between every area of the boat. A sophisticated experience with the power to excite.

Y 95



The flagship of our Y Class range – the all-new Y95, has been crafted with an emphasis on long-range cruising comfort and inspired styling. With the latest hull form and an efficient wave-piercing bow, she will provide class-leading seakeeping, reaching speeds up to 24 knots. With a spacious garage and transformer bathing platform and the option of a beach club, your maximum enjoyment of time on the water is assured. Her evolved exterior styling features the longest and most expansive hull windows ever installed on a Princess yacht, whilst her spacious indoor and outdoor living spaces are comparable to those of larger craft.



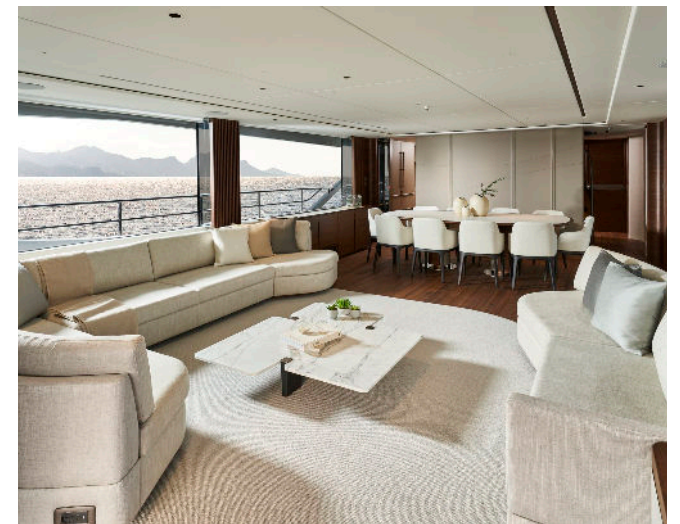

Configurable layout options throughout and a new interior design language await, with the guidance of your own Princess Design Consultant to assist with defining your vision. With an interior volume comparable to larger yachts, her main deck features a full beam master stateroom with skylights and is complemented by a further four well-appointed en-suite guest cabins. Her generous crew accommodation includes an en-suite Captain's cabin with double bed.







EXPERIENCE THE Y95





Y95
SPECIFICATION

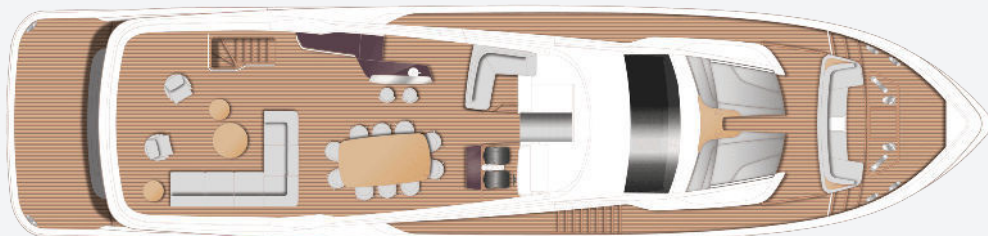

Y95 Flybridge

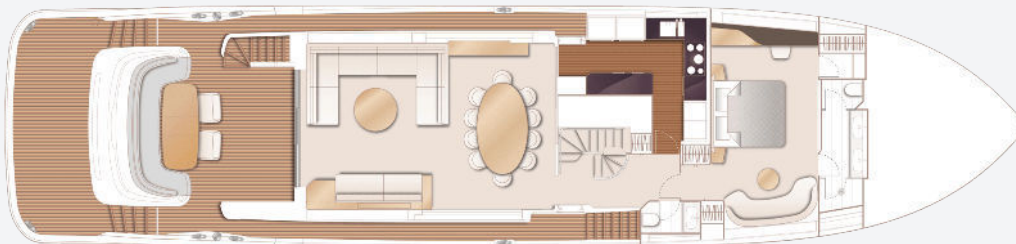

Y95 Main Deck

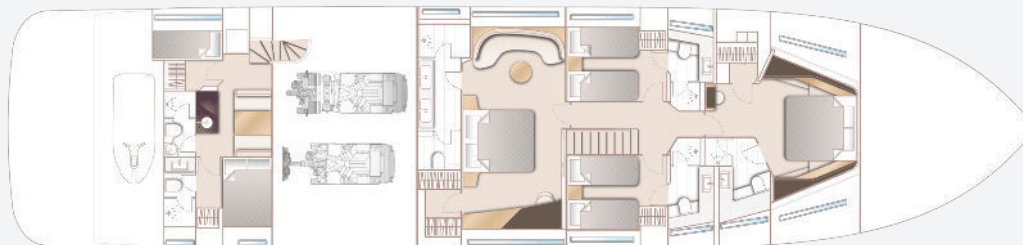

Y95 Lower Deck

PRINCIPAL DIMENSIONS

Length overall (incl. pulpit)	95ft 6in (29.1m)
Length overall (excl. pulpit)	93ft 9in (28.58m)
Beam	22ft 3in (6.77m)
Draft approx. (full load)	6ft 6in (1.97m)
Displacement approx. (half load)	111,762kg (246,393lbs)*
Fuel capacity	3,040 gal/3,650 US gal/13,818l
Water capacity (excl. calorifier)	410 gal/492 US gal/1,865l

ENGINES

Twin MAN V12 (2 x 2,000mhp)	Speed range: 22-24 knots†
--	------------------------------

FULL SPECIFICATION

DECK FITTINGS

- 6mm teak-laid transom platform, transom steps, cockpit deck, stairway to flybridge, side decks, steps to foredeck, flybridge deck and foredeck walkthrough areas
- Reversible hydraulic anchor winches with bridge controls (Lewmar V8)
- Anchor pockets with anchor launch and retrieve
- Twin anchor system incorporating two 125kg galvanised kedge anchor with 100m of 14mm galvanised chain
- Deck chain stoppers (2)
- Mooring bollards forward (4)
- Mooring bollards aft (6)
- Mooring bollards mid-ship (1 per side)
- Twin electric sternline mooring winches (Lewmar C6)
- Deck hatch access to chain, Bosuns and fender storage locker (locking, with access ladder)
- Freshwater deck/anchor wash (with both fore and aft deck outlets) (bow deckwash locker, starboard side under transom steps) (quick release bayonet fitting)

- Stainless steel bow and stern fairleads
- Stainless-steel foredeck guard rails
- Stainless steel flybridge handrails
- PVC rubbing band with stainless-steel insert
- LED deck level lighting
- Full set of IMCO navigation lights
- Riding light
- Twin beam searchlight with remote controls (located on hardtop/radar arch)
- Loudhailer (located on mast)
- Stern docking lights (on underside of canopy/flybridge overhang)
- Twin electric horns (located on mast)
- Fuel and water fillers (fuel: main deck, port and starboard, water: starboard side)

COCKPIT AND BATHING PLATFORM

- Self-draining
- Upholstered U-shaped seating with storage below (non-locking)
- Teak dining table with removable central leaf section paired with 2 dining chairs
- LED overhead and deck level lighting

- Stainless-steel handrails
- Stern docking station controls on starboard side including thruster controls and emergency engine stop Rexroth control as standard
- Remote control 5.47m telescopic passerelle with folding handrails
- Watertight (double D sealed) hinged locking door giving access from transom into garage / optional beach club area
- Engine room to cockpit escape hatch
- Garage (to take wet-bike up to 3.05m) with electro-hydraulic door and manual wet-bike launch system with additional storage for SEABOBs (2 max, starboard bulkhead mounted rack)
- Rope storage locker (non-locking)
- Starboard locker containing remote fuel cocks, manual bilge pump with valve chest and manual controls for automatic fire extinguishers
- Integral stairway to flybridge with teak step treads

- Twin glazed transom gates leading to bathing platform
- Electro-hydraulic teak laid transformer bathing platform (1000Kg SWL)
- Retractable bathing ladder (manual) in side of bathing platform
- Hot and cold transom shower
- Three phase shore support inlet (380v-415v / 42kVa @50Hz) with Glendinning cabledmaster (15m/50ft) and a single-phase shore power inlet (220-240v / 15kVa @ 50Hz. Both shore supports with isolation transformers. (US Spec single phase 2 x 100A @ 60Hz)
- Cockpit table cover, U-shaped seat cover & dining chairs cover
- Optional wetbar unit with wash basin
- Port side deck lockable access and stairway to crew accommodation

HELM

- Enclosed pilot house with central leather upholstered slim-line helm seat with arm rests.
- L-shaped companion seating to port with table
- Sliding companionway door to flybridge
- Instrument console with LED display incorporating engine instruments, CCTV linked

to Böning screens, fuel gauges, alarms and rudder position indicator

- Dual station helm position instrument and controls
 - power-assisted electro-hydraulic steering (SeaStar)
 - steering wheel
 - high-speed magnetic compass
 - electronic engine controls
 - bow thruster control
 - hydraulic anchor winch remote control
 - colour radar (with scanner) and GPS/chart plotter (twin 19" displays)
 - autopilot
 - speed and distance log
 - echo sounder with alarm
 - VHF with DSC R/T with intercom
 - remote control dual searchlight
 - horn button (to operate twin electric horns)
 - Bilge pump controls with audible and visual alarms
 - engine room fire extinguisher warning system
- Automatic fog horn with loudhailer
- Chart storage
- Drink holders
- Toughened glass screen (clear for night vision)

with windscreen de-mist system

- Windscreen wipers with freshwater windscreen wash
- Exterior black mesh windscreen covers
- 24v and 240v electrical control panel
- Riding light, helm and navigation light control switches
- USB charging points (2)
- Dimmable LED overhead, concealed lighting (24v) and night lighting with scene selection
- Timber flooring (V groove planked)

FLYBRIDGE AND FOREDECK

- Instrument console with dual station controls and LED display incorporating engine instruments, fuel gauges, alarms and rudder position indicator
- GPS chart plotter (19" display)
- Twin helm and navigator seats with fore and aft adjustment
- Foredeck area with U-shaped seating and storage locker
- Glazed panels in foredeck to allow light through to main deck owner's cabin below
- Foredeck sunbathing area with twin sunpads and integrated adjustable headrests and

- storage locker
- Port side pantograph door giving deck access directly from foredeck to flybridge
- Flybridge aft deck area with free standing furniture
- Dining table with chairs to accommodate 10 persons
- Port forward L-shaped seating area with cupholders
- Naim Uniti Star audio system with waterproof speakers (4)
- Clear view hatch to aft cockpit
- Access stairway to aft cockpit
- Stainless-steel handrails with glass balustrade to aft flybridge deck
- Port wetbar unit with twin barbecue, sink, drawer refrigerator, bin and storage
- Starboard servery unit with storage
- Lifteraft deployment system integrated into port and starboard coaming
- LED overhead and deck level lighting
- GRP radar arch
- Radar mast
- Twin matching whip aerials for VHF R/T and radio
- Covers to exterior furniture where appropriate

- Optional crane (1,000kg SWL) concealed in starboard coaming
- Optional GRP hardtop

SALOON

- Large sofa to port with storage below
- Sofa to starboard with storage below
- Coffee table
- 65" 4K UHD LED TV on rise and fall.
- Naim Uniti Star system with Focal 100 ICW6 speakers (4) and Focal Cub Evo subwoofer
- Panoramic tinted toughened glass windows port and starboard
- Triple stainless-steel framed cockpit doors
- Access to main deck lobby
- Dimmable LED overhead and concealed lighting with scene selection
- 220/240v outlets (4)
- USB charging points (4)
- Electric roller blinds to outboard windows
- Manual curtains on wave track to aft patio doors
- Fitted carpet

DINING AREA

- Dining table with dining chairs (10)

- Servery unit with integrated drinks refrigerator, bottle storage and icemaker
- Electric blinds to windows
- Fitted carpet
- Full height glazing port and starboard in way of servery unit/bar and starboard dining area

GALLEY

- Enclosed galley
- Galley unit counter tops in choice of granite or quartz
- 5-zone induction hob
- 900mm wide conventional oven
- Combination convection/microwave oven with grill
- Twin full height refrigeration units with deep freeze drawers
- Ice maker (in freezers)
- Twin stainless-steel sinks with mixer tap
- 12 place dishwasher
- Waste bin
- High- and low-level storage cupboards and drawers
- Extractor fan
- Cutlery and crockery storage
- Space for optional wine cooler

- Manual sliding access doorway to deck saloon/ dining area
- Watertight hinged access door to port side deck
- 220/240v power outlets (4)
- Dimmable LED overhead and concealed lighting with scene selection
- Electric roller blinds to windows
- Timber flooring (V groove planked)
- Bulkhead between galley to owner's stateroom to include insulation layers

MAIN DECK LOBBY

- Access stairway to pilothouse
- Access stairway to lower accommodation
- Storage lockers including space for additional dining chairs when table not extended (under stairs, aft of day head)
- Watertight pantograph access door to starboard side deck
- 220/240v outlet (1)
- Dimmable LED overhead concealed lighting (24v) with scene selection
- Electric blind to window
- Timber flooring (V groove planked)

DAY HEAD

- Electric freshwater toilet
- Wash hand basin and counter top in thermoformed solid surface
- Storage cupboard
- Panoramic tinted toughened glass window
- Manual tension venetian blinds
- Marble/granite/quartz floor

ACCOMMODATION

- All cabins and bathrooms feature opening portholes and air conditioning
- All cabins feature 220/240v power points
- All en-suites feature 240v shaver points

MAIN DECK OWNER'S STATEROOM

- Large double bed with bedside tables and drawers below
- Dressing area with full length mirror, hanging, shelf and drawer storage
- Wardrobes
- Built-in safe
- Port dressing table with integrated mirror, chair, storage drawers and cupboards
- Starboard seating area with sofa and storage below and coffee table

- 65" 4K UHD LED TV
- Naim Uniti Atom audio system with speakers (2) and subwoofer
- Panoramic windows including opening portholes
- Electric roman blinds and manual sheer roller blinds to hull windows
- Dimmable LED overhead and concealed lighting (24v) with scene selection
- Individual berth lights
- 220/240v outlets (4)
- USB charging points (4)
- Fitted carpet

EN-SUITE BATHROOM

- Twin washbasins and counter top in thermoformed solid surface
- Mirror
- Storage lockers
- Separate compartment with toilet
- Shower compartment with automatic pump out
- Extractor fan
- Window with opening porthole
- Manual tension venetian blind
- LED overhead and concealed lighting (24V)
- Bathroom accessories

- Marble/granite/quartz to floor and specified bulkheads

AFT STATEROOM

- Large double bed with bedside tables and drawers below
- Dressing area with full length mirror, hanging, shelf and drawer storage
- Built-in safe
- Starboard dressing table with integrated mirror, chair, storage drawers and cupboards
- Portside seating area with sofa and storage below and coffee table
- 55" 4K UHD LED TV
- Naim Uniti Atom audio system with speakers (2) and subwoofer
- Panoramic windows including opening portholes
- Electric roman blinds to hull windows, with out-board manual sheer roller blind
- Dimmable LED overhead and concealed 24v lighting with scene selection
- Individual berth lights
- 220/240v outlets (4)
- USB charging points (4)
- Fitted carpet

EN-SUITE BATHROOM

- Twin washbasin and counter top in thermoformed solid surface
- Mirror
- Storage lockers
- Separate compartment with toilet and option of bidet
- Shower compartment with automatic pump out
- Extractor fan
- Window with opening porthole
- Manual tension venetian blind
- LED overhead and concealed lighting (24v)
- Bathroom accessories
- Marble/granite/quartz to floor and specified bulkheads

FORWARD STATEROOM

- Large double bed with drawers below
- Walk-in wardrobe with shelves
- Dressing table with chair
- Mirror
- Storage lockers
- 43" UHD LED TV
- Naim Uniti Atom audio system with ceiling mounted Focal 100 ICW6 speakers (2)
- Windows with opening portholes

- Electric roman blinds to hull windows
- Dimmable LED overhead and concealed lighting (24v) with scene selection
- Individual berth lights
- 220/240v outlets (2)
- USB charging points (2)
- Fitted carpet

EN-SUITE BATHROOM

- Washbasin and counter top in thermoformed solid surface
- Mirror
- Storage lockers
- Shower compartment with automatic pump out
- Extractor fan
- Window with opening porthole
- Manual tension venetian blind
- LED overhead and concealed lighting (24v)
- Bathroom accessories
- Marble/granite/quartz flooring

STARBOARD GUEST CABIN

- Two single beds with drawers below (with option of double bed conversion)
- Bedside table
- Wardrobe with shelves

- Mirror
- Storage lockers
- Window with opening portholes
- Electric roman blind to hull window
- Dimmable LED overhead and concealed (24v) lighting with scene selection
- Individual berth lights
- Optional pullman berth
- 220/240v outlets (1)
- USB charging point (2)
- Fitted carpet

EN-SUITE BATHROOM

- Washbasin and counter top in thermoformed solid surface
- Mirror
- Storage lockers
- Shower compartment with automatic pump out
- Extractor fan
- Window with opening porthole
- Manual tension venetian blind
- LED overhead and concealed lighting (24v)
- Bathroom accessories
- Marble/granite/quartz flooring

PORT GUEST CABIN

- Two single beds with drawers below (with option of double bed conversion)
- Bedside table
- Wardrobe with shelves
- Mirror
- Storage lockers
- Window with opening portholes
- Electric roman blind to hull window
- Deck hatch
- Dimmable LED overhead and concealed 24v lighting with scene selection
- Individual berth lights
- Optional pullman berth
- 220/240v outlets (1)
- USB charging points (2)
- Fitted carpet

EN-SUITE BATHROOM

- Washbasin and counter top in thermoformed solid surface
- Mirror
- Storage lockers
- Shower compartment with automatic pump out
- Extractor fan
- Window with opening porthole

- Manual tension venetian blind
- LED overhead and concealed lighting (24v)
- Bathroom accessories
- Marble/granite/quartz flooring

LOWER ACCOMMODATION LOBBY

- Linen cupboard below companionway stairs
- Space for optional washer/dryer below companionway stairs
- Dimmable LED overhead and concealed lighting (24v) with scene selection
- Fitted carpet

CREW QUARTERS

- Standard transom configuration is a transom garage with Captain's double cabin and en-suite, second crew bunk cabin, aft bathroom, crew mess and dining area.
- Optional transom configuration is a beach club with Captain's double cabin (with en-suite), crew bunk cabin, central bathroom, and aft beach club/dinette.
- All lower crew furniture is in white finish, with solid surface Carrera White (gloss finish) bathroom vanity unit tops and solid surface Koko White (satin finish) bathroom floors (non-

slip flooring

(satin finish)

CAPTAIN'S CABIN

- Double berth with storage below
- Wardrobe with shelf
- Mirror
- Storage lockers
- Opening porthole and venetian blind
- Emergency deck hatch access to cockpit
- LED overhead lighting (24v)
- Individual berth light
- 220/240v outlets (1)
- USB charging points (2)
- Fitted carpet

CAPTAIN'S EN-SUITE

- Washbasin with Carrera White (gloss finish) solid surface counter top
- Mirror
- Storage lockers
- Shower compartment with automatic pump out
- Extractor fan
- Porthole with venetian blind
- LED overhead lighting (24v)
- Bathroom accessories
- Solid surface flooring in Koko White

CREW CABIN

- Single bunk beds (2)
- Wardrobe with shelf
- Mirror
- Storage lockers
- Opening porthole and venetian blind
- LED overhead lighting (24v)
- Individual berth light
- 220/240v outlets (2)
- USB charging points (2)
- Fitted carpet

CREW BATHROOM

- Washbasin with Carrera White (gloss finish) solid surface counter top
- Mirror
- Storage lockers
- Shower compartment with automatic pump out
- Extractor fan
- LED overhead lighting (24v)
- Bathroom accessories
- Solid surface flooring in Koko white (satin finish)

CREW AREA

- Access from port side deck (also transom door with optional beach club)
- Access to engine room
- Storage space, cupboards and lockers
- Dinette with table
- Crew mess with microwave with grill, sink, refrigerator and waste bin
- Solid surface counter top in Ice Crystal (satin finish)
- Washing machine and separate tumble dryer
- LED overhead lighting (24v)
- Non-slip flooring

POWER AND DRIVE SYSTEMS

- High volume air intakes
- Engine room extractor fan with electronic time delay
- Engine exhaust silencers and water-cooled exhausts
- Engine beds integrally moulded with hull for strength and vibration absorption
- Forward and aft engine room bulkheads integrally bonded including acoustafoam layers
- Engines flexibly mounted

- Automatic fire extinguisher with remote override control
- Automatic and manual bilge pumps
- Propeller shafts produced from Marinemet
- 5-bladed propellers in nickel aluminium bronze
- High speed balanced rudders
- Cathodic protection for sterngear
- Sterngear, engines, fuel tank fillers, etc all electrically bonded
- Engine room lighting
- Engine room access from port side deck via crew area and from cockpit deck
- Power-assisted electro-hydraulic steering system
- Electronic engine and gear shift controls
- Bow thruster with dual-station controls (Sleipner 550kgf)
- Fresh water supply point in engine room
- Dripless self-aligning shaft seals

ELECTRICAL SYSTEMS

24 Volt:

- 4 x heavy duty batteries for engine starting
- 6 x heavy duty auxiliary batteries
- Battery link facility with remote control at helm position

- Both battery banks are charged using a voltage sensitive relay that parallels both battery banks when a charging source is present
- 1 x 100 amp charger, 1x 100 amp-3500W charger/inverter & 1x 25amp charger (for generator battery).
- Remote battery isolator control switches at main switch panel position
- Circuit breakers on all circuits
- 24v to 12v converters for certain navigation and radio circuits
- Galvanic isolation system
- CCTV system with camera in aft cockpit and fixed cameras in engine room (2) linked to Böning system

220/240 Volt:

- European specification: 2 x 40kW @ 50Hz Onan diesel generators in own sound shields, water cooled and with specially silenced exhaust systems and with remote operation from main control panel
- USA specification: 2 x 40kW @ 60Hz Onan diesel generators in own sound shields, water cooled and with specially silenced exhaust systems and with remote operation from main

control panel

- Three phase shore inlet (380v-415v / 42kVa @50Hz) with Glendinning cablemaster (15m/ 50ft) and a single-phase shore power inlet (220-240v / 15kVa @ 50Hz. Both shore supports with isolation transformers. (US Spec single phase 2 x 100 amp @ 60Hz)
- Shore power/generator change over control operated from main control panel
- Polarity check system
- Earth leakage safety trip, circuit breakers on all circuits
- Power points (240v) in all cabins and living areas, helm position and galley
- 240v shaver points in washrooms
- 3kW immersion heater for fresh water (2)

FUEL SYSTEM

- Main fuel tank with fuel polishing transfer system to day tank giving a total 3,040 gal / 3,650 US gal / 13,818l of fuel capacity (forward fuel bunker tank 4,866 l and main fuel bunker tank 8,008l plus day fuel tank 944l)
- Fuel fillers to port and starboard
- High capacity duplex fuel filters/water traps with integral changeover valves and water

- sensors connected to alarms at helm position
- Remote fuel isolation controls in cockpit locker for main engines and generators
- Fuel gauges at helm position

AIR CONDITIONING SYSTEM

- Air conditioning/heating reverse cycle 300,000 BTU fan capacity with 216,000 BTU chiller capacity suitable for temperatures to 40°C (tropical)
- Windscreen demist facility
- Outlets in all areas

WATER SYSTEM

- Water tanks giving 1,865l capacity plus 205l hot water calorifier
- Automatic water pump with filter
- Water level gauge
- Deck filler
- Pump circuit breaker at main switch panel
- Electric freshwater toilet system linked to 720l holding tank, content gauge and low noise electric overboard discharge, with macerator backup system as well as dockside discharge system
- Grey water to take waste water from sinks/

showers, washing machine(s) and dishwasher

BILGE PUMPS

- Automatic/manual override electric bilge pumps in engine room, rudder area, forward accommodation, crew area and chain locker
- High capacity manual bilge system with suction points in the same areas
- Electric bilge pumps have controls and warning lights with audible alarm at helm position

EXTINGUISHERS / FIRE CONTROL SYSTEMS

- Automatic engine room fire extinguisher system (with manual override) and warning system at helm position providing automatic shutdown of engines, generators and ventilation fans
- Manually operated engine room air shutoff system
- Hand operated fire extinguishers in all guest cabins, galley, crew quarters and flybridge

OTHER STANDARD EQUIPMENT

- Ensign staff
- Fenders (8)
- Mooring warps (4)

- First-aid kit
- Set of towels (10 large, 10 hand)
- Quilted bed covers supplied to all cabins (except crew cabins)
- Complete set of Lucrezia cut crystal glassware (12 settings consisting of tumbler, highball and wine glasses)
- Set of Sous Le Soleil crockery (10 settings consisting of plate, cake plate, dessert plate, bowl, cup and saucer)
- Set of stainless steel cutlery (10 settings of David Mellor "Paris" cutlery 7 pieces)
- Tool kit
- Boat hook
- Owner's manual and engine manual
- Ship's document case
- Black mesh windscreen covers
- Dynamat applied in the following locations
- Crews aft engine room bulkhead
- Crew deck head
- Forward main deck owner's/dining area deck head

FINISHES

- Teak-laid decks to all external deck areas (including flybridge)

- Timber floor (V groove planked) to galley and wheelhouse as standard (wheelhouse in Newport oak as standard)
- Furniture in choice of Alba Oak, Rovere Oak in satin lacquer finish as standard. Silver Oak or Walnut with satin or gloss lacquer finishes available as an option
- Marble, quartz or granite floors in all bathroom suites in guest accommodation (including day head)
- Thermo-formed solid surface wash basins and counter tops in all bathroom suites and day head
- Galley counter top in granite or quartz as standard (some options carry additional premiums)
- Choice of high-quality carpets and fabrics from extensive range
- Curtains, blinds or sunscreens to all windows and portholes (except pantograph doors and wheelhouse)
- Crew cabins have fitted carpet, crew bathrooms have solid surface floors and counter tops
- Non-slip flooring to crew mess and passageway