

S

CLASS



S CLASS

Cool and captivating. Balanced. Distinctively luxurious and spaciousness throughout, the extensive cockpits, garages and aft sunpads entice you to enjoy watersports and the great open air. A sports experience with generous interior accommodation for entertaining, our S Class craft are a haven of relaxation, and exhilaration is on tap, for when you need it.

S 65



With a sleek exterior profile, the S65 balances dynamic form with breathtaking performance. The main deck flows from outside to in, surrounded by large hull length windows, sliding doors aft, an electrically sliding roof and an aft galley which connects beautifully to the cockpit.









Below deck, four cabins, including a full-beam master stateroom, can accommodate up to eight guests, plus optional crew cabin with en-suite.

Generously appointed deck areas, which include a spacious foredeck seating area, aft sunpad, hydraulic bathing platform and 3.3m tender garage become the perfect base for watersports.

The sportsbridge offers flexible seating areas with the option to adapt the space via a moveable backrest to offer a forward sunbed with storage below.





S65
SPECIFICATION

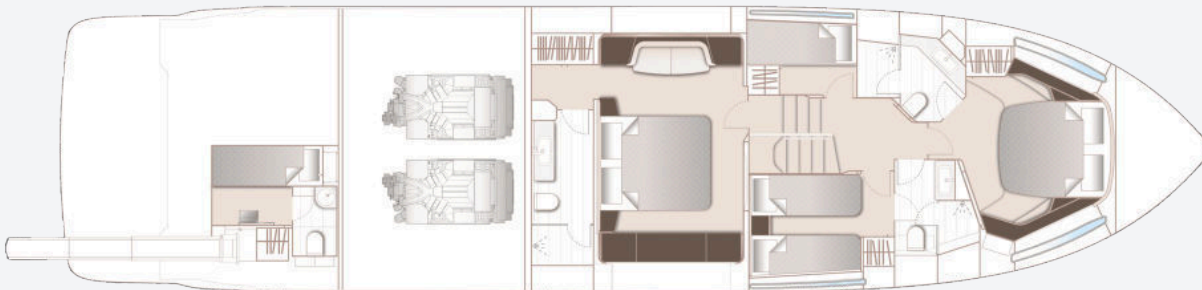
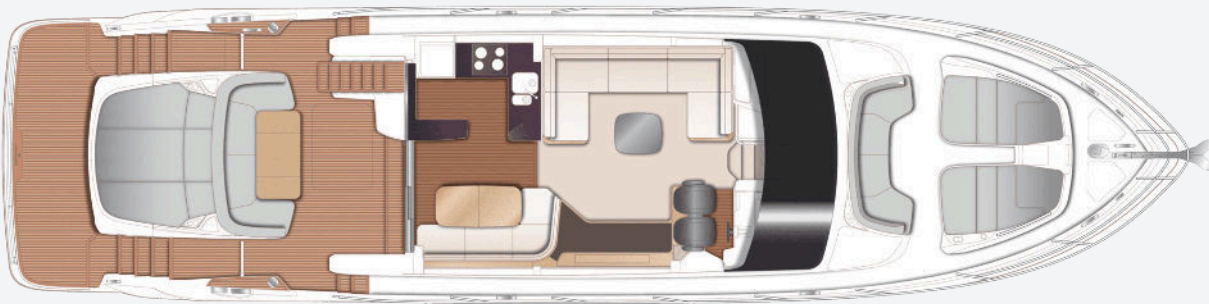
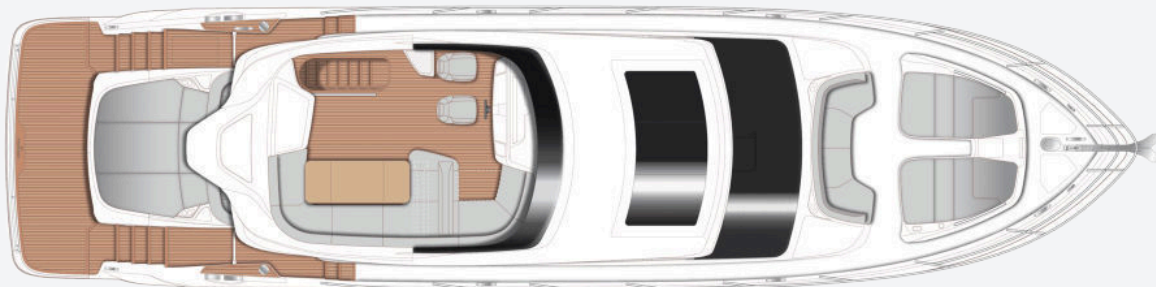

PRINCIPAL DIMENSIONS

Length overall (incl. pulpit)	67ft 7in (20.605m)
Length overall (excl. pulpit)	65ft 8in (20.027m)
Beam	16ft 9in (5.094m)
Draft	5ft 5in (1.655m)
Displacement approx. (half load)	42,277kg (93,20lbs)*
Fuel capacity	902 gal/1083 US gal/4,100l
Water capacity (excl. calorifier)	176 gal/212 USgal/802l

ENGINES

MAN V8-1200 (2 x 1200mhp)	Maximum speed - 32-34 knots [†]
MAN V12-1400 (2 x 1400mhp)	Maximum speed - 34-36 knots [†]

FULL SPECIFICATION

DECK FITTINGS

- Teak-laid transom platform, transom steps, cockpit deck, Sportbridge stairway and steps to side deck
- Reversible electric anchor winch with foredeck and helm position controls
- Stem head roller with automatic anchor launch and retrieve
- Self-stowing anchor system incorporating one Lewmar Delta anchor (40kg/88lb) with 60m of 9.5mm chain
- Bow rope storage locker
- Deck storage lockers for fenders
- Freshwater deck/anchor wash
- Stainless steel bow fairleads (2) and stern fairleads (2)
- Cast stainless steel bow (2), stern (2) and spring cleats (4)
- Stainless steel pulpit and guardrails (round 32mm)
- Stainless steel coach roof handrails
- PVC rubbing band with stainless steel insert

- LED deck level lighting
- Illuminated crown logo to transom
- Full set of IMCO navigation lights
- Riding light
- Searchlight with remote control
- Loudhailer (connected to VHF)
- Twin electric horns
- Fuel and water fillers
- Foredeck escape hatch
- Foredeck U-shaped seating area and walk-through
- Foredeck sunbathing area with twin sunbeds including cushions with integrated storage locker and drinks holders (4)

AFT COCKPIT AND BATHING PLATFORM

- Self-draining
- U-shaped seating/dining area with folding teak table and drinks holders
- Sunbed aft with drinks holders
- Cockpit countertop (aligned with galley countertop and hinging window), with under-

- stairs storage unit
- LED overhead and deck level lighting
- Integral stairway to Sportbridge
- Stainless steel handrails
- Life raft stowage locker
- Rope stowage lockers
- Lockable gas strut assisted hatch to lazarette to port side
- Lockable gas strut assisted hatch to lazarette/ optional crew cabin to starboard under aft sunpad
- Lockable gas strut assisted hatch to engine room
- Locker containing remote fuel cocks, manual bilge pump with valve chest and manual controls for automatic fire extinguishers
- Twin transom gates leading to bathing platform
- Transom grab rail
- Ensign socket
- Garage (suitable for up to a Williams SportJet 345 or equivalent) with electro-hydraulic door and tender launch system with electric winch
- Electro-hydraulic raise/lower teak laid bathing

platform (500kg SWL)

- Retractable bathing ladder (manual) in side of hydraulic platform
- Transom steps to access stern from bathing platform when in lowered position
- Hot and cold transom shower
- 220/240v shore support inlet in locker
- Tonneau cover

HELM POSITION

- Twin helm seats with fore and aft adjustment for helmsman, crown logo to both seats, flip up base to helm seat for door access
- Raymarine Axiom 2XL (15.6" display size) multifunction colour display, incorporating GPS/chart plotter, log and echo sounder
- Raymarine Evolution autopilot with P70Rs control head
- 9" multifunction display, displaying engine instrumentation (including fuel levels and fuel flow)
- Dual station instruments and controls at Sportbridge and Lower Helm Positions:
 - power-assisted electro-hydraulic steering
 - adjustable steering wheel

- rudder position indicator
- magnetic compass
- electronic engine controls
- trim tab controls with indicators
- bow thruster control
- electric anchor winch remote control
- VHF with DSC R/T with intercom
- remote control searchlight
- horn button
- Storage tray
- Drinks holders
- Toughened glass screen (clear for night vision)
- Windscreen wipers with freshwater windscreen wash – review alternative control options during development
- Exterior black mesh windscreen covers
- Bilge pump controls with visual pump running warnings
- 24v and 240v electrical control panel
- Riding light, helm and navigation light control switches
- USB charging points (2) (1x USB-A and 1x USB-C)
- 220/240v outlet (1)
- LED overhead lighting (24v) and night lighting
- Pantograph helmsman's side door to starboard

side deck

- Timber flooring (V-groove planked)

SPORTBRIDGE

- Dual station instruments and controls (see helm position)
- Raymarine Axiom 2XL (15.6" display size) multifunction colour display, incorporating GPS/chart plotter, log and echo sounder
- Raymarine Evolution autopilot with P70Rs control head
- 9" multifunction display, displaying engine instrumentation (including fuel levels and fuel flow)
- Adjustable steering wheel
- Drinks holders (2), storage box, and storage tray at helm position
- Separate helm and navigator seats (with sufficient space to allow ingress/egress without disturbing helmsman) with fore and aft adjustment for helmsman
- Forward U-shaped upholstered companion seating (converts to sunpad with infill)
- Aft large U-shaped upholstered seating area with storage below

- Movable back rest between dining and companion seating (to convert seating areas between U-shaped and L-shaped)
- Teak double-fold dining table with drinks holders
- Fusion Apollo SRX-400 audio system with Wi-Fi/Bluetooth/DAB. Paired with Fusion Signature 7.7" speakers (2)
- Wet bar with waste bin, electric grill/barbecue and sink/tap, with Solid Surface countertop
- Top-loading cool box position behind navigator seat
- Clear view hatch to aft cockpit
- Wind deflector screens (grey tinted Perspex)
- Stainless steel handrails
- LED deck level lighting
- GRP radar arch
- Matched whip aerials for VHF R/T radio
- Console, seat, wet bar and table covers
- *Optional GRP Sportbridge hardtop (including LED dimmable lighting) OR Optional bimini with/without electro hydraulic operation/ lighting*
- USB charging points (2) (1x USB-A and 1x USB-C)

DECK SALOON

- U-shaped sofa with storage/crockery drawers
- Coffee table
- Electric drop window to port
- Sideboard unit with bottle and glass storage, and refrigerator
- 55" TV on rise and fall
- Fusion Apollo MS-RA770 audio system with Wi-Fi/Bluetooth/ DAB. Paired with Focal 100ICW6 speakers (2)
- Storage drawers below navigator's seat
- Panoramic tinted toughened glass windows port and starboard
- Manual tension venetian blinds (matte black) to windows
- LED overhead and concealed lighting (24v)
- Access stairway to lower accommodation
- Skylights with dark grey tint and sliding blinds (*option of powered opening roof*)
- Fitted carpet
- 220/240v outlets (2)

DINING AREA

- L-shaped sofa with storage drawer
- Folding dining table/drinks holders (4)
- Stainless steel framed sliding door to cockpit (three pane) with integrated hinging window aft of galley (one fixed pane, two sliding panes, one flip window) and integrated Skysol blind
- Manual tension venetian blinds (matte black) to windows
- LED overhead and concealed lighting (24v)
- 220/240v outlet (2)
- Timber flooring (V-groove planked)

GALLEY

- Solid Surface countertop
- 4-zone ceramic hob
- Extractor fan
- Combination microwave/convection oven with grill
- Full height fridge/freezer (281l)
- Twin-bowl (1.5) stainless steel sink with mixer tap
- Slimline full height dishwasher (9 place setting)
- Waste bin

- Drawers and storage cupboards
- Manual tension venetian blinds (matte black) to windows
- LED overhead and task lighting (24v)
- 220/240v outlets (4)
- Timber flooring (V-groove planked)

ACCOMMODATION

- All cabins and bathrooms (exc. crew bathroom) feature opening portholes
- All cabins feature 220/240v power points
- All bathrooms (exc. crew bathroom) feature 240v shaver points
- All bathrooms feature electric freshwater toilets

MASTER STATEROOM

- Large double bed with drawers below
- Twin bedside tables
- Walk-through wardrobe area with hanging, drawer storage and full-length mirror
- Dressing table
- Sofa
- Storage drawers
- 50" TV

- Fusion Apollo MS-RA770 audio system with Wi-Fi/Bluetooth/DAB. Paired with Focal 100ICW6 speakers (2)
- Panoramic windows including opening porthole
- Manual tension venetian blinds (grey)
- LED overhead and concealed lighting (24v)
- Individual berth lights
- 220/240v outlets (4) (1 per side and 2 beside vanity unit)
- USB charging points (4) (2 per side (1x USB-A and 1x USB-C))
- Fitted carpet

EN-SUITE BATHROOM

- Wash basin with thermoformed, Solid Surface vanity top
- Mirror to vanity unit
- Storage lockers
- Shower compartment with automatic pump out
- Extractor fan
- Window with opening porthole
- Manual tension venetian blind (grey)
- LED overhead lighting (24v)
- Bathroom accessories

- Solid Surface flooring

FORWARD STATEROOM

- Large double bed with drawers below
- Wardrobe with shelves and full-length mirror
- Dressing table
- Storage lockers
- Windows with opening portholes
- Manual tension venetian blind (grey)
- Deck hatch
- LED overhead lighting (24v)
- Individual berth lights
- 220/240v outlets (3) (1 per side and 1 under vanity unit)
- USB charging points (4) (2 per side (1x USB-A and 1x USB-C))
- Fitted carpet

EN-SUITE BATHROOM

- Wash basin with thermoformed, Solid Surface vanity top
- Mirror
- Storage lockers
- Shower compartment with automatic pump out

- Extractor fan
- Window with opening porthole
- Manual tension venetian blind (grey)
- LED overhead lighting (24v)
- Bathroom accessories
- Solid Surface flooring

STARBOARD GUEST CABIN

- Two single beds with drawers below (*with option of sliding double bed conversion*)
- Bedside table
- Wardrobe with shelves
- Mirror
- Storage lockers
- Window with opening portholes
- Manual tension venetian blinds (grey)
- LED overhead lighting (24v)
- Individual berth lights
- 220/240v outlets (1)
- USB charging points (2) (1x USB-A and 1x USB-C)
- Fitted carpet

EN-SUITE BATHROOM

- Wash basin with thermoformed, Solid Surface vanity top
- Mirror
- Storage lockers
- Shower compartment with automatic pump out
- Extractor fan
- Window with opening portholes
- Manual tension venetian blind (grey)
- LED overhead lighting (24v)
- Bathroom accessories
- Solid Surface flooring
- Day access door from lower lobby

PORT GUEST CABIN

- Two single beds (bunk)
- Wardrobe with shelf
- Mirror
- Storage lockers
- Window with opening portholes
- Manual tension venetian blinds (grey)
- LED overhead lighting (24v)
- Individual berth lights
- 220/240v outlet (1)

- USB charging points (2) (1x USB-A and 1x USB-C)
- Fitted carpet

LOWER ACCOMMODATION LOBBY / PASSAGEWAY AREA

- Combination washer/dryer with storage area above located below companionway stairs (*option of separate washing and drying machines if required*)
- LED overhead and concealed lighting (24v)
- Fitted carpet

OPTIONAL CREW CABIN (IN PLACE OF AFT LAZARETTE)

- Furniture in specified choice of boat timber
- Single bed with storage below
- Lockers with shelf
- Opening porthole
- Hinged door with access from hatch under aft sunpad
- LED overhead lighting (24v)
- Individual berth lights
- 220/240v outlet (1)

- USB charging point (2) (1x USB-A and 1x USB-C)
- Timber floor

EN-SUITE BATHROOM

- Bathroom in white laminate
- Wash basin with Solid Surface vanity top
- Storage lockers
- Shower with automatic pump out
- Extractor fan
- LED overhead lighting (24v)
- Bathroom accessories
- Non-slip flooring (GRP)

POWER AND DRIVE SYSTEMS

- Propeller shafts in Marinemet
- 5-bladed propellers in nickel aluminium bronze
- Bow thruster (170kgF) with dual-station controls
- High speed balanced rudders
- Power-assisted electro-hydraulic steering system
- Trim tabs with indicators
- Cathodic protection for stern gear

- Stern gear, engines, fuel tank fillers, etc all electrically bonded
- Forward and aft engine room bulkheads and engine room headlining to be integrally bonded including insulation with acoustafoam layers
- High volume air intakes
- Engine room extractor fan with electronic time delay
- Engine exhaust silencers and water-cooled exhausts
- Engine beds integrally moulded with hull for strength and vibration absorption
- Engines flexibly mounted
- Automatic fire extinguisher with remote override control
- Automatic and manual bilge pumps
- Engine room lighting
- Engine room access from cockpit deck, via hatch with ladder
- Electronic engine and gear shift controls
- Fresh water supply point in engine room
- Dripless self-aligning shaft seals

ELECTRICAL SYSTEMS

24 Volt:

- 4 x heavy duty batteries for engine starting
- 4 x heavy duty auxiliary batteries
- 1 x generator battery
- Battery link facility with remote control at helm position
- Battery banks are charged using a voltage sensitive relay that parallels both battery banks when a charging source is present
- 60-amp battery charger charges both banks of batteries via an automatic switch charging system
- 6-amp battery charger for generator battery
- Remote battery master switches with control switch at main switch panel
- Circuit breakers on all circuits
- 12v voltage dropper for certain navigation and radio circuits

220/240 Volt:

- EU specification: 11Kw diesel generator in own sound shield with water cooled specially silenced exhaust systems
- US specification: 13.5kW diesel generator in

own sound shield with water cooled specially silenced exhaust systems

- Automatic fire extinguisher situated by generator
- 60-amp shore support inlet
- 6-amp battery charger for generator battery
- Generator/shore support change-over switch
- Polarity check system
- Earth leakage safety trip
- Circuit breakers on all circuits
- Power points in: master stateroom, guest cabins, galley and saloon area
- Shaver points in all bathrooms (exc. crew)

FUEL SYSTEM

- Twin fuel tanks (in NS8 marine grade alloy) with interconnection system giving 902 gal / 1083 US gal / 4,100 l capacity
- Fuel fillers on port and starboard side decks
- High-capacity duplex fuel filters with water traps with change-over valves, water warning sensors connected to warning lights at lower helm
- Remote fuel cocks in cockpit locker
- Fuel gauges at main helm console (via MFD)

WATER SYSTEM

- Water tanks totalling 176 gal / 211 US gal / 800 l plus 16 gal / 19 US gal / 73 litres hot water calorifier
- Water heated by engines and 240v immersion heater
- Automatic water pump with filter
- Main circuit breaker at switch panel
- Water level gauge
- Deck filler
- Electric WC system with 60 gal / 72 US gal / 272 l holding tank, content gauge and low noise electric overboard discharge, with macerator backup system as well as dockside discharge system

BILGE PUMPS

- Automatic/manual override electric bilge pumps in engine room (2), rudder area, lazarette and forward accommodation (6 in all)
- High-capacity manual bilge pump with valve system and suction points in same areas
- Electric bilge pumps have controls and warning

lights at main helm and warning light with audible alarm at Sportbridge helm

FIRE EXTINGUISHERS

- Automatic/manual override fire extinguishers in engine room with warning system at helm position
- Hand-operated fire extinguishers (6) in master stateroom, forward, port and starboard guest cabins, galley and helm position
- Additional extinguisher fitted when optional aft cabin is specified
- Automatic under helm fire extinguisher at lower helm

OTHER STANDARD EQUIPMENT

- Ensign staff
- Fenders (6)
- Mooring warps (4)
- Boat hook
- First-aid kit
- Tool kit
- Owner's manual and engine manual
- Functional bed linen supplied to all cabins

- (including optional aft cabin when specified)
- Set of glassware (8 settings consisting of tumbler and wine glasses)
- Set of Princess china (8 settings consisting of plate, side plate, bowl, cup & saucer)
- Set of cutlery (8 settings of David Mellor “Paris” cutlery 7 pieces)
- Ship’s document case
- Anchor winch back up handle
- S65 canopy badges

FINISHES

- Teak-laid decks to transom platform, transom steps, steps to side decks, cockpit deck, steps to Sportbridge and steps to side decks
- Timber-laid floor to galley, dining area (V-groove planked)
- Furniture in choice of Rovere Oak or Alba Oak in satin finish as standard. Silver Oak or Walnut in satin or gloss finishes available as an option
- Solid Surface floors in all bathroom suites in guest accommodation
- Solid Surface wash basin vanity tops in all bathrooms
- Galley countertop in Solid Surface

- Choice of high-quality carpet and upholstery fabric from extensive range
- Exterior upholstery in white vinyl as standard, with optional upgrade to Comfort Exterior available
- Manual tension venetian blinds (matte black to main deck, grey to lower deck) to all windows
- Optional crew cabin furniture in specified choice of boat timber with timber flooring. Crew bathroom in white laminate with white Solid Surface vanity tops and non-slip (GRP) flooring