

Van der Valk Continental 1800 • 2007 • Ref: PB650

Lying: UK South Coast

Price: 1,195,000 €



Actual Craft

Dutch Built steel motor yacht

Wheel house with electrically operated sliding sunroof

Twin double cabins with en-suite bathrooms

Under floor heating and Air conditioning

Radar, chartplotter, GPS and autopilot

KVH 4 TV Sat system, Sat phone

Camera to decks and engine room

Hydraulic bow and stern thruster

Hydraulic stabilisation system

Tracking burglar alarm system

Hydraulic Passerelle

Watermaker

Generator

Contact: Swanwick

Tel: Int. +44 (0)1489 557744 Fax: Int. +44 (0)1489 557766

E-mail: pbi@princess.co.uk

Van der Valk Continental 1800 • Ref: PB650

Dimensions:

- L.O.A: 18.40 metres (60 ft 7in)
- Beam: 5.00 metres (16 ft 5 in)
- Draft: 1.60 metres (5 ft 3 in)
- Displacement: approx 43 Tonnes
- Fuel capacity: 3500 Litres (786 Gallons)
- Water capacity: 1000 Litres (225 Gallons)

Propulsion:

- 2 x Volvo D6 370hp EVC diesel engines on shafts
- Engine hours: approx 270 hours
- 22hp Hydraulic Bow and Stern thrusters
- Hydraulic power assisted steering
- NAIAD Marine Hydraulic stabilisation System

Navigational Equipment:

- Raymarine E120 Radar/Chart plotter/ GPS with 2x 12" colour displays
- Raymarine ST8002 autopilot
- Raymarine ST100 autopilot remote control
- Raymarine ST60 rudder position indicator, compass, wind, speed/log, echo sounder
- Raymarine 240E VHF/RT with DSC and loudhailer
- Holland Nautic back-up steering
- Search light

Deck Equipment:

- Besenzoni hydraulic passerelle/ tender crane
- Side boarding gate with folding hydraulic stairs
- Lofrans electric windlass 42kg stainless steel anchor with 60 meters of 12mm chain
- Deck wash facility with foredeck outlet
- Teak cockpit, side decks and transom platform
- Ten mooring bollards, two sets of spring cleats
- Stainless steel fender baskets
- Stainless steel foldaway swim ladder
- Hot and cold transom shower
- Teak cockpit table
- Deck lighting
- Cockpit cover

Ship Systems:

- Hull and superstructure has upgraded insulation
- 1 x 32 amp shore support inlet with Glendenning shore cable system 220V
- Mastervolt battery charges and twin alternators

Generators, Air Conditioning & Heating:

- Mastervolt Whisper Ultra 12 kVa generator
- Mastervolt Whisper Ultra 6kVA generator
- Heating: Kabola boiler HR400-Combi
- Underfloor heating in whole boat
- Marine Air System air conditioning to whole boat
- Whole boat is thermally insulated

Safety Equipment:

- Orlaco camera system to deck and engine room
- Automatic engine room fire extinguisher system
- Hand held fire extinguishers
- Bilge pumps
- Escape hatches in master and guest cabin
- 8 man liferaft
- CE-class A homologation

Interior Arrangements:

- Master stateroom aft with en-suite bathroom
- Forward stateroom with en-suite bathroom
- Wheelhouse with adjustable helm seats, C-shaped settee and bar with sink and cooler
- Saloon with U-shaped seating, dinette and galley
- Teak woodwork with blue lacquered gloss panels
- Cream leather saloon upholstery
- Electric blinds to wheel house and saloon areas
- Teak floor to galley and bathrooms
- Triple opening door to wheel house
- Overhead and concealed lighting with dimmers

Interior Equipment:

- Wheel house with electrically sliding sunroof
- Mosquito screens
- Central vacuum system
- Full height fridge/freezer, ceramic hob, combination microwave/conventional oven
- Qucooker (hot) tap,
- Bosch dishwasher
- Miele washing machine/dryer
- DVD/Stereo Surround system
- Electric WCs with holding tank 500 litres
- Water Purifier system
- 32" LCD TV to saloon
- LCD TV to master with mirror effect screen
- KVH-4 satellite TV system
- Sat phone with KVH-4 antenna

- Trac Alarm, Alarm E-marine

Layout Plan:

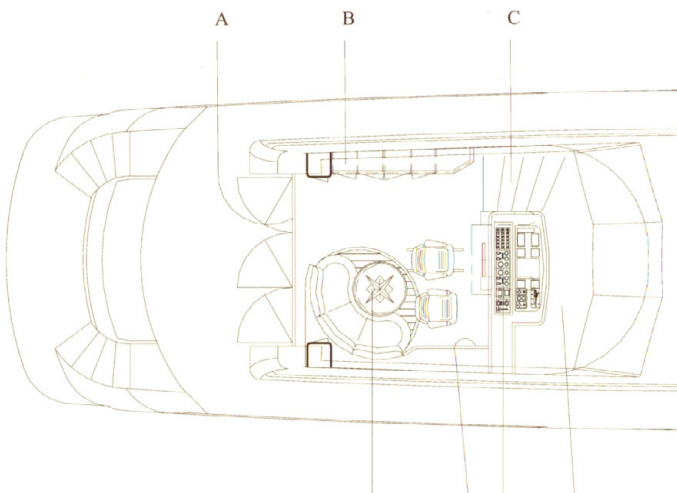
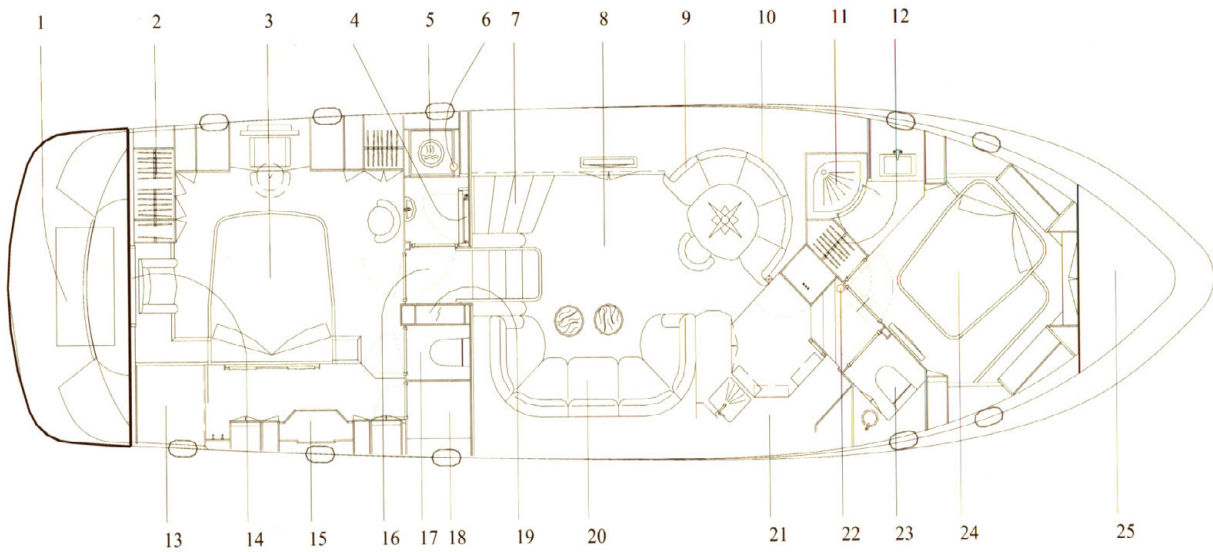

Whilst every care has been taken in the preparation of these particulars, their correctness is not guaranteed and they are intended as a guide only and do not constitute a part of any contract. A prospective purchaser is strongly advised to check these particulars and where appropriate and at his own expense to employ a qualified marine surveyor to carry out a survey and/or to have an engine trial conducted which if conducted by us shall not imply any liability on our part.

All dimensions, speeds & range given are approximate and should be treated as a guide only. Some pictures may be from brochures or of a similar boat. Engine hours shown are correct at the time of the preparation of the particulars, but will vary with usage.